

## NEED MORE HELP?

For the latest support info and online User Manuals visit [jabra.com/motionoffice](http://jabra.com/motionoffice)

TOLL FREE Customer Contact Details:

EUROPE	PHONE	EMAIL
Austria	+43720880558	support.at@jabra.com
Belgique/Belgium	+3228080766	support.be@jabra.com
Czech Republic	--	support.global@jabra.com
Denmark	+45 69918794	support.dk@jabra.com
Finland	+4535256540	--
France	+33 182880251	support.fr@jabra.com
Germany	+4930896778991	support.de@jabra.com
Italy	+39 0662207674	support.it@jabra.com
Luxembourg	+45 35256540	--
Netherlands	+31 208080962	support.nl@jabra.com
Norway	+4722577785	support.no@jabra.com
Poland	--	support.global@jabra.com
Portugal	+4535256540	--
Russia	--	support.ru@jabra.com
Spain	+34 911875539	support.es@jabra.com
Sweden	+46 852507012	support.se@jabra.com
Switzerland	+41 435002460	support.ch@jabra.com
Turkey	--	support.global@jabra.com
United Kingdom	+44 2033180070	support.uk@jabra.com
International	+4535256540	--

For more information, please visit  
[www.jabra.com](http://www.jabra.com)

Jabra MOTION OFFICE

**Jabra**<sup>®</sup>  
YOU'RE ON

**GET STARTED**

[JABRA.COM/MOTIONOFFICE](https://jabra.com/motionoffice)

A BRAND BY

**GN Netcom**

---

© 2014 GN Netcom A/S (North America: GN Netcom US, Inc.). All rights reserved. Jabra® is a registered trademark of GN Netcom A/S. All other trademarks included herein are the property of their respective owners. The Bluetooth® word mark and logos are owned by the Bluetooth SIG, Inc. and any use of such marks by GN Netcom A/S is under license. (Design and specifications subject to change without notice).

---

Made in China

MODEL: BTE6  
WHB006



**Bluetooth®**

---

[www.jabra.com](http://www.jabra.com)

ENGLISH.....	2
ČESKY .....	8
DEUTSCH .....	14
DANSK/ SVENSKA.....	20
ESPAÑOL .....	26
FRANÇAIS .....	32
ITALIANO.....	38
NEDERLANDS.....	44
POLSKI .....	50
PORTUGUÊS .....	56
РУССКИЙ .....	62
TÜRKÇE.....	68

# OVERVIEW

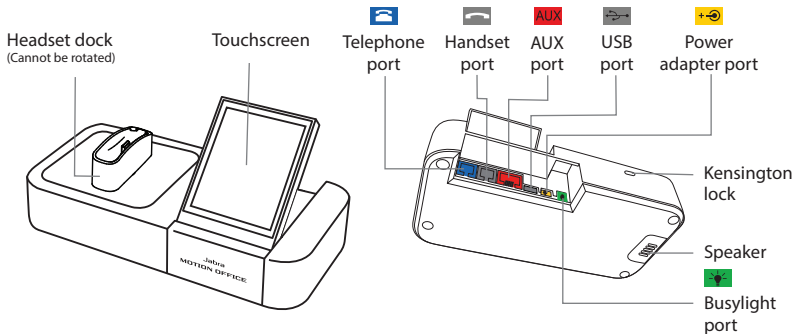
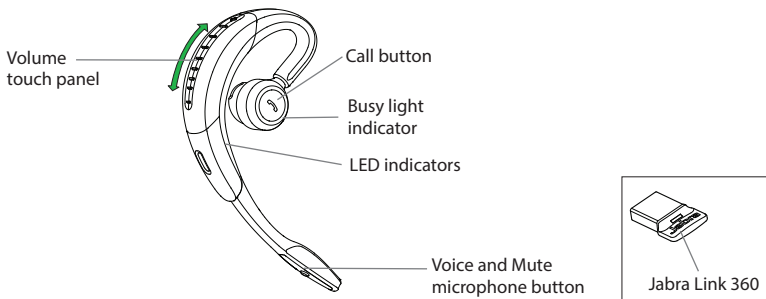

# 1 BASIC SETUP

ENGLISH

1

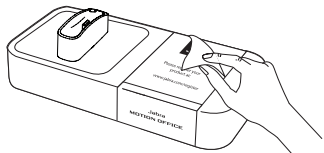

2

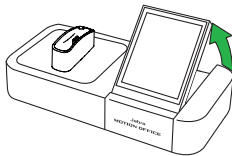

3

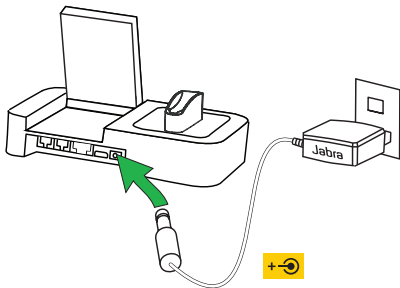

4



## Important!

Download and install the latest Jabra software from [jabra.com/pcsuite](http://jabra.com/pcsuite) for full headset functionality.

# 2 CONNECT TO PHONE OR PC

## JABRA MOTION OFFICE CONNECTION

The first time the base is connected to power, the setup wizard will automatically start. The setup wizard can also be accessed at any time via the touchscreen menu.

1. Tap the Settings menu on the touchscreen.
2. Tap Phone settings > Setup wizard.
3. Tap confirm to start the setup wizard.

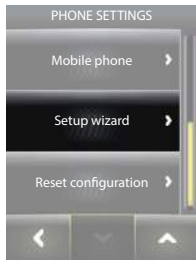

## JABRA LINK 360 CONNECTION

The Jabra Link 360 enables a connection to a PC without the base, giving you wireless freedom when you travel.

To connect, simply plug the Jabra Link 360 into a USB port on your PC. The headset and the Jabra Link 360 are already pre-paired.



### Important!

The Jabra Link 360 and the base should not be plugged in at the same time.



# 3 WEARING THE HEADSET

## HEIGHT ADJUSTMENT

Get the perfect fit for your ear by adjusting the height of the speaker up or down.

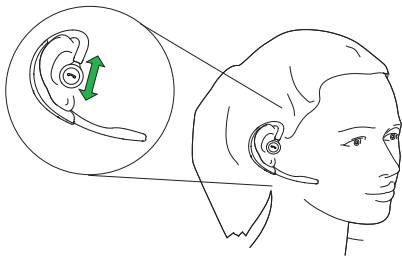

## LEFT OR RIGHT EAR WEARING STYLE

The headset can be worn on the left or right ear. To switch ear:

1. Pull the speaker all the way down.
2. Rotate the speaker 180°.
3. Twist the eargel around to fit your ear.

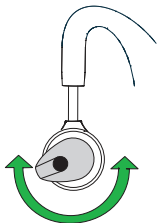
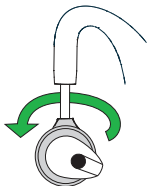
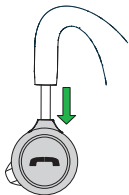



# 4 HOW TO USE

Volume touch panel

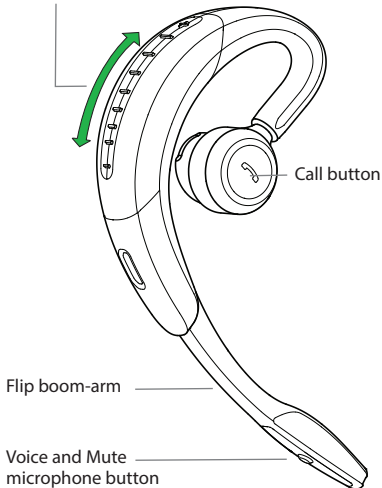





**IDLE**



**INCOMING CALL**

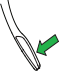

**ON A CALL**

	FUNCTION	ACTION
	Headset On/off	Open/close the flip boom-arm
	Answer call	Tap the <b>Call</b> button on the headset, or tap the <b>Answer call</b> button on the touchscreen
	End call	Tap the <b>Call</b> button on the headset, or tap the <b>End/reject call</b> button on the touchscreen
	Talk time status	When not on a call, tap the <b>Call</b> button on the headset
	Speaker volume	Slide a finger up/down the <b>Volume touch panel</b>
	Switch primary device	Tap a connected device on the touchscreen to switch the primary device for calls
	Voice commands	Tap the <b>Voice and Mute microphone</b> button when not on a call, until you hear 'Say a command'. Say 'What can I say?' for a list of voice commands
	Mute microphone	Tap the <b>Voice and Mute microphone</b> button during a call

### Important!

For more information about using the Jabra Motion Office, refer to [jabra.com/motionoffice](http://jabra.com/motionoffice)

# PŘEHLED

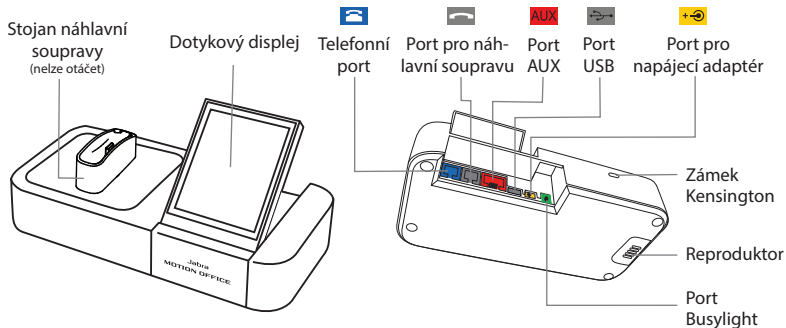
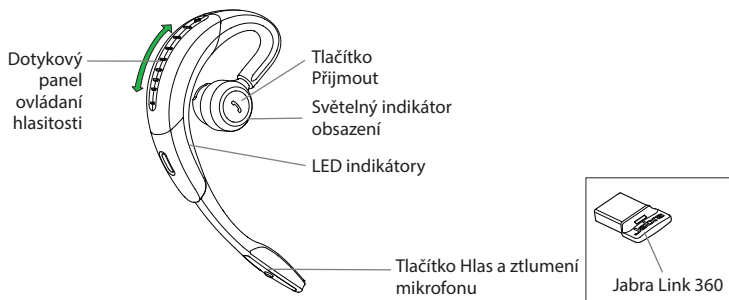

# 1 ZÁKLADNÍ NASTAVENÍ

ČESKY

1

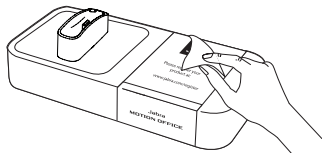

2



3

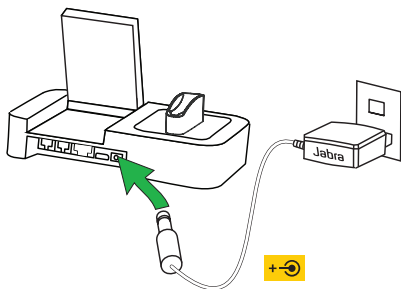

4

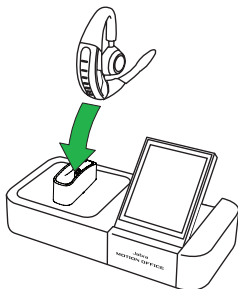

## Důležité!

Pro plnou funkčnost náhlavní soupravy si stáhněte a nainstalujte nejnovější Jabra software z [jabra.com/pcsuite](http://jabra.com/pcsuite).

# 2 PŘIPOJENÍ K TELEFONU NEBO PC

## PŘIPOJENÍ JABRA MOTION OFFICE

Při prvním připojení základny k napájení se automaticky spustí průvodce nastavením. Průvodce nastavením lze také kdykoliv otevřít pomocí nabídky dotykového displeje.

1. Klepněte na nabídku Nastavení na dotykovém displeji.
2. Klepněte na Phone settings (Nastavení telefonu) > Setup wizard (Průvodce nastavením).
3. Klepnutím na tlačítko Confirm (Potvrdit) spustíte průvodce nastavením.



## PŘIPOJENÍ JABRA LINK 360

Jabra Link 360 umožňuje připojení k PC bez základny, čímž vám dává bezdrátovou volnost během cestování.



Chcete-li se připojit, stačí zapojit Jabra Link 360 do USB portu na počítači. Náhlavní souprava a Jabra Link 360 jsou předem spárovány.

### Důležité!

Jabra Link 360 a základna by se neměly zapojovat současně.



# 3 NOŠENÍ NÁHLAVNÍ SOUPRAVY

## NASTAVENÍ VÝŠKY

Úpravou výšky sluchátka nahoru nebo dolů můžete dosáhnout dokonalého uchycení na uchu.

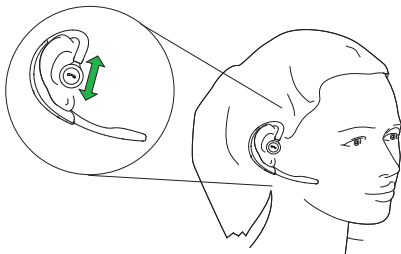

## STYL NOŠENÍ NA LEVÉM NEBO PRAVÉM UCHU

Náhlavní soupravu lze nosit na levém nebo pravém uchu. Změna z levého na pravé nebo naopak:

1. Stáhněte sluchátko zcela dolů.
2. Sluchátko otočte o 180°.
3. Zahýbejte gelovým nástavcem tak, aby se řádně usadil na vašem uchu.

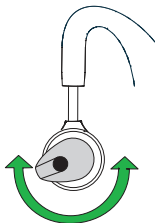
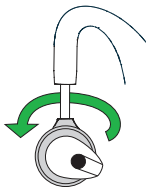
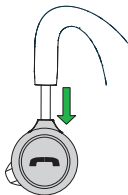

# 4 ZPŮSOB POUŽÍVÁNÍ

Hlasitost  
dotykový  
panel

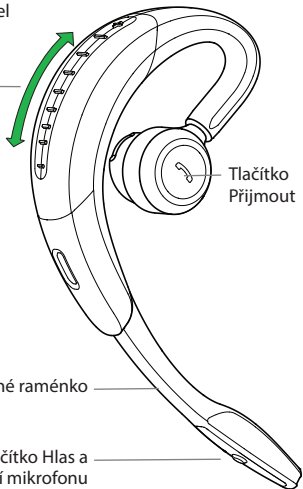

## NEAKTIVNÍ

Nabídka  
Nastavení

Připojená  
zařízení  
(primární  
zařízení vpředu)

Uskutečnit  
hovor



## PŘÍCHOZÍ HOVOR

Přijmout hovor

Odmítnout  
hovor







## PROBÍHÁ HOVOR

Nabídka  
možností volání

Ztišit hovor

Ukončit hovor

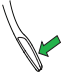
	FUNKCE	AKCE
	Zapnutí a vypnutí náhlavní soupravy	Vyklopit/sklopit výklopné raménko
	Přijem hovoru	Stiskněte tlačítko <b>Přijmout</b> na náhlavní soupravě nebo klepněte na <b>Přijmout hovor</b> na dotykovém displeji
	Ukončit hovor	Stiskněte tlačítko <b>Přijmout</b> na náhlavní soupravě nebo klepněte na <b>Ukončit/odmítnout hovor</b> na dotykovém displeji
	Stav doby hovoru	Pokud neprobíhá hovor, stiskněte tlačítko <b>Přijmout</b> na náhlavní soupravě
	Hlasitost reproduktoru	Na <b>dotykovém panelu ovládání hlasitosti</b> posouvejte prstem nahoru/dolů
	Přepnout primární zařízení	Klepnutím na připojené zařízení na dotykovém displeji přepněte primární zařízení pro volání
	Hlasové příkazy	Pokud neprobíhá hovor, klepněte na tlačítko <b>Hlas a ztlumení mikrofonu</b> , dokud neuslyšíte povel „Say a command.“ Chcete-li znát úplný seznam hlasových příkazů, řekněte „What can I say?“
	Ztlumení mikrofonu	Klepněte na tlačítko <b>Hlas a ztlumení mikrofonu</b> během hovoru

## Důležité!

Více informace o použití Jabra Motion Office naleznete v [jabra.com/motionoffice](https://jabra.com/motionoffice)



# ÜBERSICHT

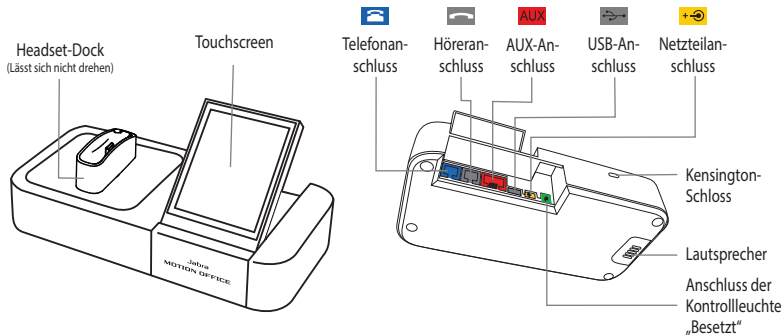
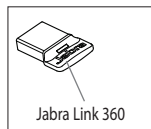
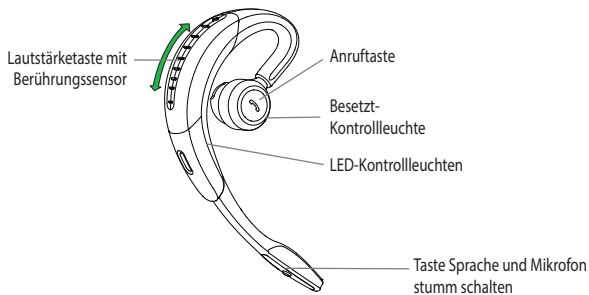

# 1 GRUNDLEGENDE KONFIGURATION

DEUTSCH

1

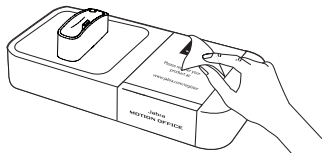

2



3

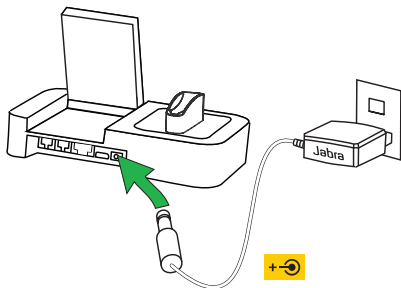

4

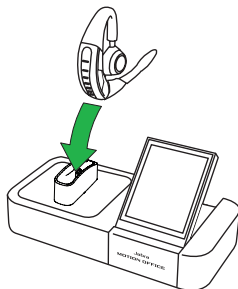

## Wichtig

Laden Sie sich unter [jabra.com/pcsuite](http://jabra.com/pcsuite) die neueste Jabra-Software herunter und installieren Sie sie, um in den Genuss der vollen Headset-Funktionalität zu kommen.

## 2 VERBINDEN MIT DEM MOBILTELEFON ODER DEM PC

### VERBINDUNG DES JABRA MOTION OFFICE

Wenn die Basisstation zum ersten Mal an Netzstrom angeschlossen wird, wird der Konfigurationsassistent automatisch gestartet. Der Konfigurationsassistent kann zudem jederzeit über das Touchscreen-Menü aufgerufen werden.

1. Tippen Sie auf das Einstellungsmenü am Touchscreen.
2. Tippen Sie auf „Phone settings > Setup wizard“ (Telefoneinstellungen > Konfigurationsassistent).
3. Tippen Sie auf „Confirm“ (Bestätigen), um den Konfigurationsassistenten auszuführen.

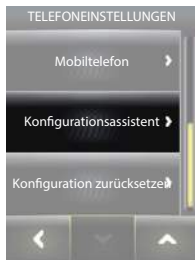

### VERBINDUNG DES JABRA LINK 360

Der Jabra Link 360 ermöglicht die Verbindung mit einem PC ohne Basisstation, was Ihnen auf Reisen schnurlose Freiheit bietet.



Stecken Sie zum Herstellen der Verbindung einfach den Jabra Link 360 in einen freien USB-Anschluss an Ihrem PC. Das Headset und der Jabra Link 360 sind bereits „pre-paired“ (gekoppelt).

### Wichtig

Der Jabra Link 360 und die Basisstation sollten nicht gleichzeitig angeschlossen sein.



# 3 TRAGEN DES HEADSETS

## HÖHENANPASSUNG

Sorgen Sie für die optimale Passform für Ihr Ohr – indem Sie den Lautsprecher in der Höhe nach oben oder unten regulieren.

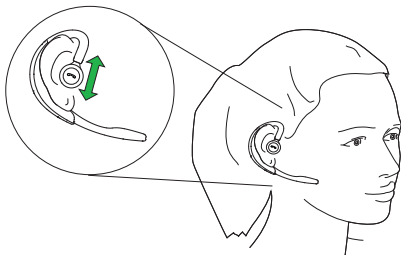

## TRAGBAR AM LINKEN ODER RECHTEN OHR

Das Headset kann am linken oder am rechten Ohr getragen werden. Auf anderes Ohr wechseln:

1. Ziehen Sie den Lautsprecher ganz nach unten.
2. Drehen Sie den Lautsprecher um 180°.
3. Drehen Sie das Eargel, bis die optimale Passform in Ihrem Ohr erreicht ist.

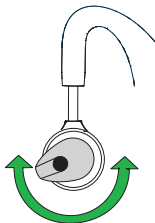
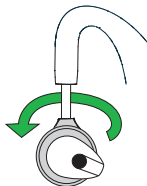
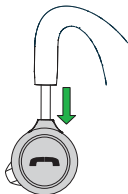

# 4 VERWENDEN

Lautstärke  
Touchpanel

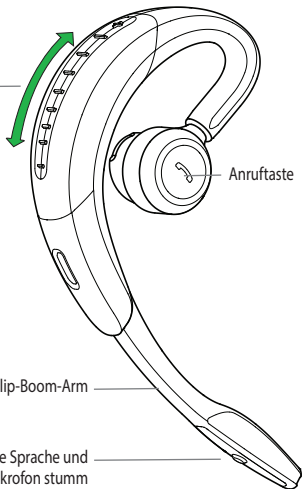

## RUHEZUSTAND







## EINGEHENDER ANRUF



## IM GESPRÄCH



	FUNKTION	AKTION
	Headset ein/aus	Öffnen/schließen des Flip-Boom-Arms
	Anruf annehmen	Tippen Sie auf die Taste <b>Anrufen</b> am Headset oder tippen Sie auf die Taste <b>Rufannahme</b> am Touchscreen
	Anruf beenden	Tippen Sie auf die Taste <b>Anrufen</b> am Headset oder tippen Sie auf die Taste <b>Anruf beenden/abweisen</b> am Touchscreen
	Gesprächszeit-Status	Tippen Sie, wenn Sie sich nicht in einem Gespräch befinden, auf die Taste <b>Anrufen</b> am Headset
	Hörlautstärke	Fahren Sie mit dem Finger auf dem <b>Touchpanel Lautstärke nach oben/ unten</b>
	Wechseln des primären Geräts	Tippen Sie auf ein verbundenes Gerät am Touchscreen, um das primäre Gerät für Anrufe zu wechseln
	Sprachbefehle	Tippen Sie auf die Taste <b>Sprache und Mikrofon stumm schalten</b> , wenn Sie sich nicht in einem Gespräch befinden. Halten Sie die Taste gedrückt, bis Sie die Aufforderung „Sagen Sie einen Befehl“ hören. Sagen Sie „Was kann ich sagen?“, um eine umfassende Liste der Sprachbefehle zu erhalten
	Mikrofon stumm schalten	Tippen Sie während eines Gesprächs auf die Taste <b>Sprache und Mikrofon stumm schalten</b>

### Wichtig

Weitere Informationen zur Verwendung des Jabra Motion Office erhalten Sie unter [jabra.com/motionoffice](http://jabra.com/motionoffice)

# OVERSIGT

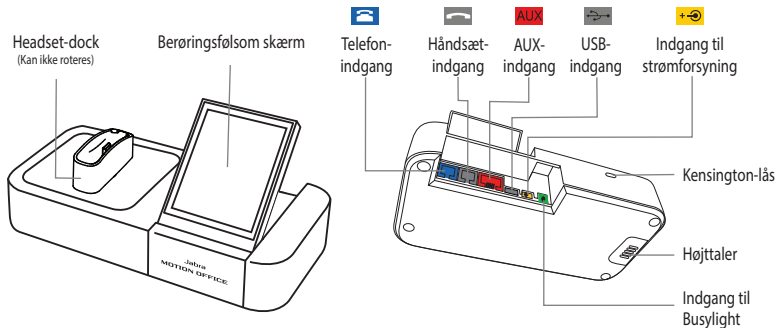
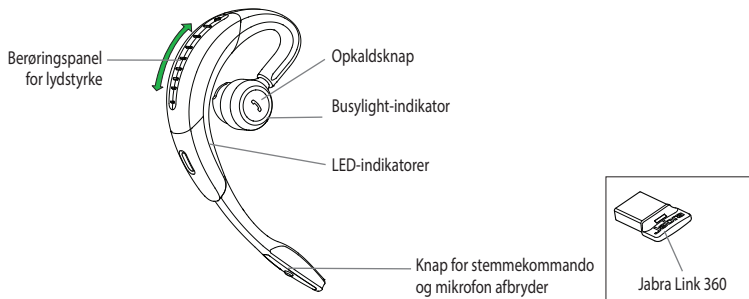

# 1 GRUNDLÆGGENDE OPSÆTNING

DANSK/ SVENSKA

1

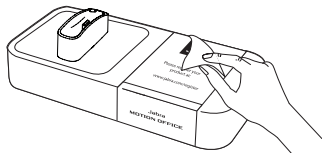

2

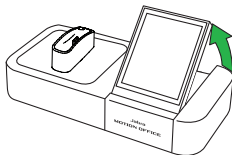

3

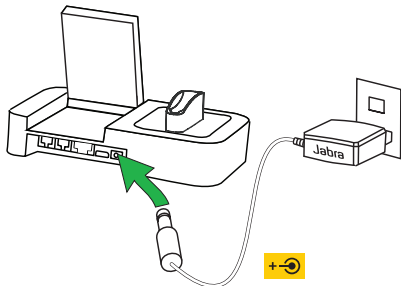

4

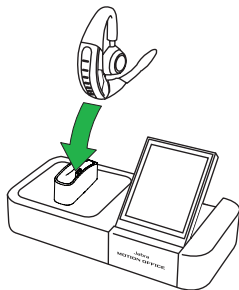

## Vigtigt!

Download og installer den seneste Jabra software fra [jabra.com/pcsuite](http://jabra.com/pcsuite) for at udnytte dit headset optimalt.



# 2 FORBIND MED EN TELEFON ELLER PC

## JABRA MOTION OFFICE TILSLUTNING/ANSLUTNING

Første gang basen tilsluttes strømforsyningen, starter opsætningsguiden/installationsguiden automatisk. Du kan også når som helst få adgang til opsætningsguiden via menuen på den berøringfølsomme skærm.

1. Tryk på Settings menu (Indstillingsmenuen) på den berøringfølsomme skærm.
2. Tryk på Phone settings > Setup wizard (Telefonindstillinger > Opsætningsguide).
3. Tryk på Confirm (Bekræft) for at starte opsætningsguiden.

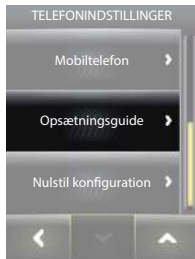

## JABRA LINK 360 TILSLUTNING

Jabra Link 360 aktiverer en forbindelse til en pc uden basen, så du kan have trådløs frihed, når du rejser.

For at forbinde skal du blot tilslutte Jabra Link 360 til en USB-indgang på din PC. Headsettet og Jabra Link 360 er allerede parret/ihopkopplade.



### Vigtigt!

Jabra Link 360 og basen må ikke være tilsluttet på samme tid.



# 3 SÅDAN BÆRES HEADSETTET

## JUSTERING AF HØJDEN

Få perfekt tilpasning til dit øre ved at justere højtaleren opad eller nedad.

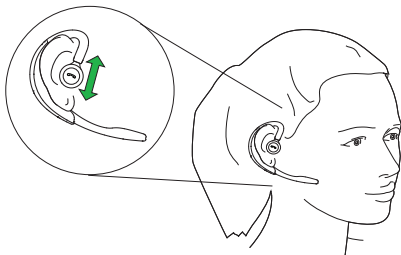

## BÆREMÅDE/BÅRSTIL PÅ HØJRE ELLER VENSTRE ØRE

Headsettet kan bæres på højre eller venstre øre. For at skifte øre:



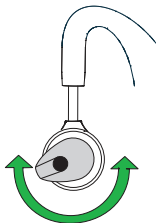
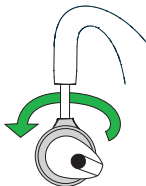
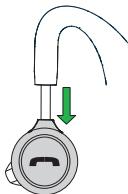

1. Træk/Dra højtaleren helt ned.
2. Drej/Vrid højtaleren 180°.
3. Drej øre-gel'en/eargel omkring for at tilpasse den.

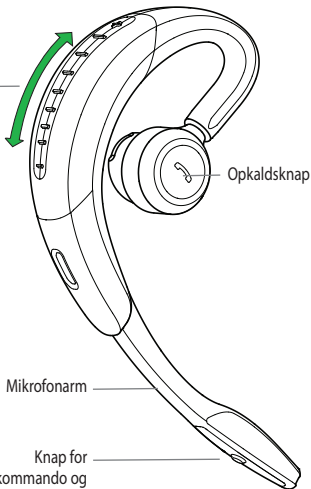

# 4 SÅDAN BRUGES HEADSETTET

Lyndindstilling  
Berøringspanel

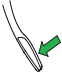

	FUNKTION	HANDLING
	Headset Tænd/sluk	Åbn/luk mikrofonarmen
	Besvar opkald	Tryk på <b>Opkalds</b> -knappen på headsettet, eller tryk på <b>Besvar opkald</b> -knappen på den berøringfølsomme skærm
	Afslut opkald	Tryk på <b>Opkalds</b> -knappen på headsettet, eller tryk på <b>Afslut/afvis opkald</b> -knappen på den berøringfølsomme skærm
	Status for taletid	Hvis du ikke er i gang med en samtale, kan du trykke på <b>Opkalds</b> -knappen på headsettet
	Højtalerlydstyrke	Før en finger op og ned over <b>berøringspanelet for lydstyrke</b>
	Skift primær enhed	Tryk på en tilsluttet enhed på den berøringfølsomme skærm for at skifte den primære enhed for opkald
	Stemme kommandoer	Tryk på <b>Knap for stemmekommando og mikrofonafbryder</b> , hvis en samtale ikke er i gang, indtil du hører 'Say a command' (sig en kommando). Sig "What can I say?" for at få en liste over kommandoer
	Slå lyden fra mikrofonen	<b>Tryk på Knap for stemmekommando og mikrofonafbryder</b> under en samtale

## Vigtigt!

For yderligere oplysninger om brug af Jabra Motion Office, henvises du til [jabra.com/motionoffice](http://jabra.com/motionoffice)

# DESCRIPCIÓN GENERAL

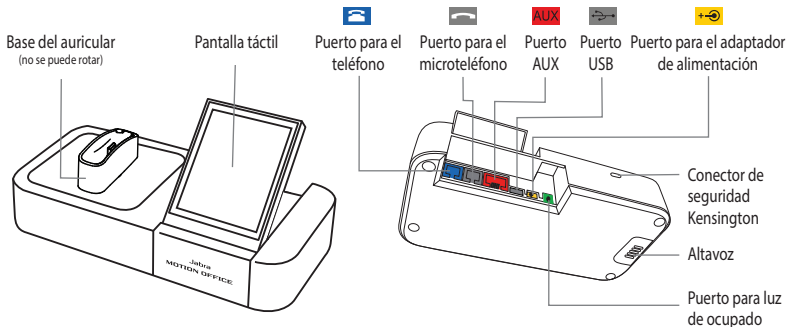
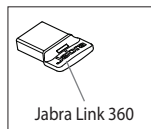
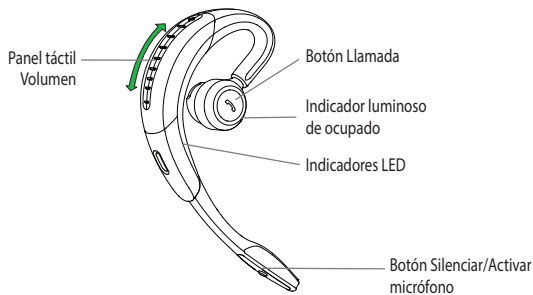

# 1 CONFIGURACIÓN BÁSICA

ESPAÑOL

1

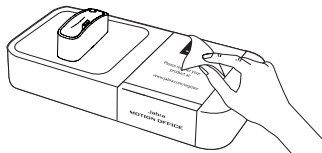

2

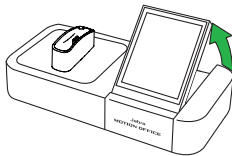

3

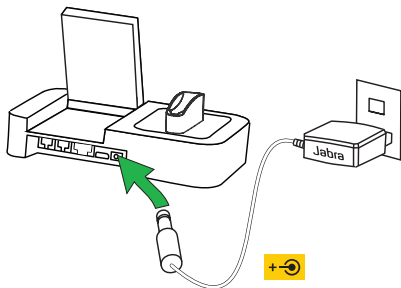

4

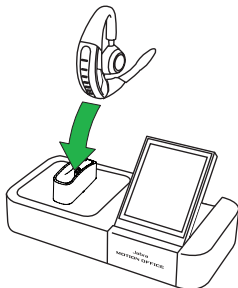

## ¡Importante!

Descargue e instale el último software de Jabra en [jabra.com/pcsuite](http://jabra.com/pcsuite) para disfrutar de todas las funcionalidades del auricular.

# 2 CÓMO SE CONECTA AL TELÉFONO O PC

## CONEXIÓN CON JABRA MOTION OFFICE

La primera vez que se conecta la base a la electricidad, el asistente de configuración se inicia automáticamente. También puede acceder al asistente de configuración en cualquier momento desde el menú de la pantalla táctil.

1. Toque el menú de configuración en la pantalla táctil.
2. Pulse Phone settings > Setup wizard (Configuración del teléfono > Asistente de configuración).
3. Toque Aceptar para iniciar el asistente de configuración.



## CONEXIÓN CON JABRA LINK 360

Jabra Link 360 permite establecer una conexión con un PC sin utilizar la base para ofrecer mayor libertad cuando viaja.

Para utilizarlo, conecte el Jabra Link 360 en un puerto USB del PC. El auricular y el Jabra Link 360 están presincronizados.



### ¡Importante!

No conecte el Jabra Link 360 y la base al mismo tiempo.



# 3 CÓMO SE COLOCA EL AURICULAR

## CÓMO AJUSTAR LA ALTURA

Aumente o reduzca la altura del altavoz para adaptarlo perfectamente a su oreja.

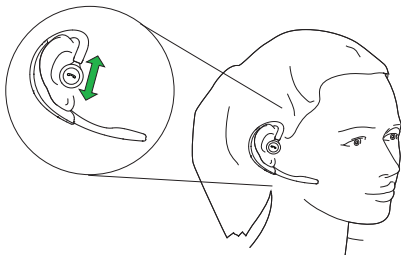

## OREJA IZQUIERDA O DERECHA

Puede utilizar el auricular en la oreja izquierda o en la derecha. Para cambiar de lado:

1. Baje totalmente el auricular.
2. Gire el auricular 180°.
3. Gire el eargel para ajustarlo a su oído.

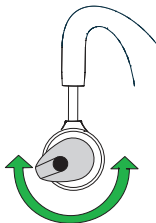
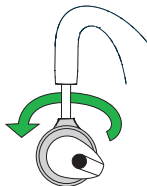
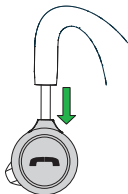





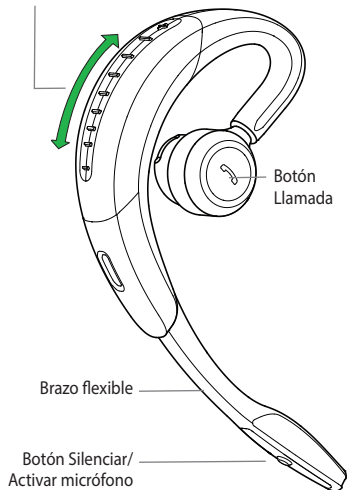

# 4 CÓMO SE USA

Panel táctil  
Volumen

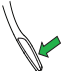

	<b>FUNCIÓN</b>	<b>ACCIÓN</b>
	Encender/Apagar el auricular	Abra o cierre el brazo flexible
	Responder una llamada	Pulse el botón <b>Llamada</b> en el auricular o toque el botón <b>Responder llamada</b> en la pantalla táctil
	Finalizar una llamada	Pulse el botón <b>Llamada</b> en el auricular o toque el botón <b>Finalizar/Rechazar llamada</b> en la pantalla táctil
	Tiempo de conversación	Cuando no haya ninguna llamada, pulse el botón <b>Llamada</b> en el auricular
	Volumen del altavoz	Deslice el dedo arriba o abajo por el <b>panel táctil Volumen</b>
	Cambiar al dispositivo primario	Toque un dispositivo conectado en la pantalla táctil para cambiar el dispositivo primario para realizar llamadas
	Comandos de voz	Toque el botón <b>Silenciar/Activar micrófono</b> cuando no haya ninguna llamada hasta que oiga "Say a command". Diga "¿What can I say?" para oír una lista con los comandos de voz disponibles
	Silenciar el micrófono	Toque el botón <b>Silenciar/Activar micrófono</b> durante una llamada

### ¡Importante!

Para más información sobre cómo usar Jabra Motion Office, consulte [jabra.com/motionoffice](http://jabra.com/motionoffice)

# VUE D'ENSEMBLE

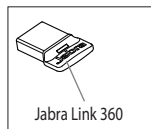
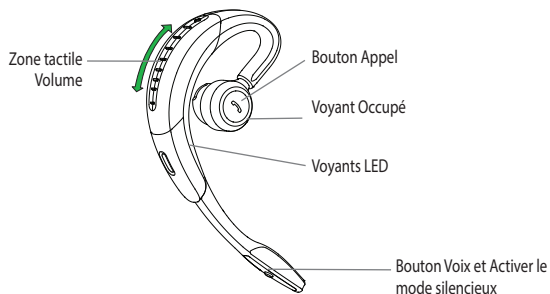

Station d'accueil de l'oreillette  
(ne peut être tournée)

Écran tactile



Port téléphone



Port casque



Port AUX



Port USB



Port d'adaptateur électrique

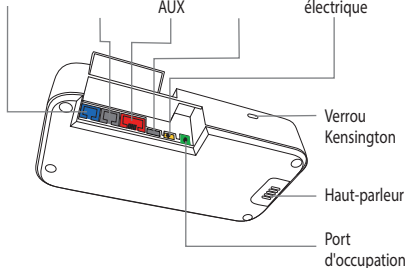
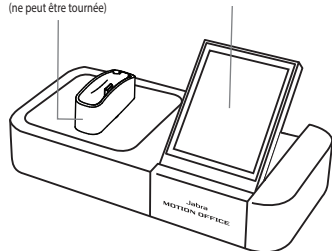

# 1 CONFIGURATION BASIQUE

FRANÇAIS

1

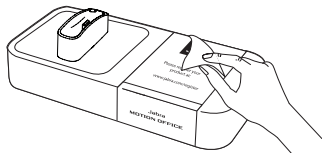

2



3

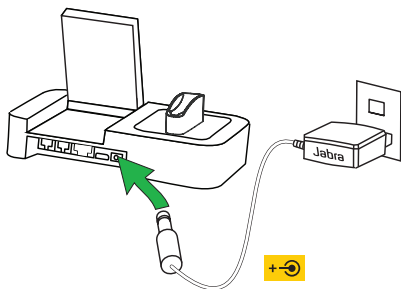

4

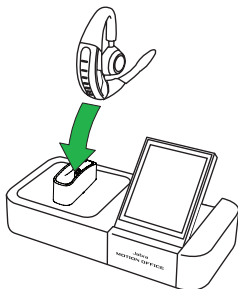

## Important!

Téléchargez et installez le dernier logiciel Jabra sur [jabra.com/pcsuite](http://jabra.com/pcsuite) pour obtenir la fonctionnalité complète de l'oreillette.

# 2 CONNEXION À UN TÉLÉPHONE OU UN PC

## CONNEXION DE JABRA MOTION OFFICE

La première fois que le socle est branché à la source d'alimentation, l'assistant de configuration démarre automatiquement. L'assistant de configuration est également accessible à tout moment via le menu de l'écran tactile.

1. Appuyez sur le menu des paramètres de l'écran tactile.
2. Appuyez sur Paramètres du téléphone > Assistant de configuration.
3. Appuyez sur Confirmer pour lancer l'assistant de configuration.



## CONNEXION DE JABRA LINK 360

Le Jabra Link 360 permet une connexion à un PC sans le socle, vous offrant une liberté sans fil lorsque vous êtes en déplacement.

Pour le connecter, il vous suffit de brancher Jabra Link 360 sur un port USB de votre PC. L'oreillette et le Jabra Link 360 sont déjà pré-appairés.



### Important !

Le Jabra Link 360 et le socle ne doivent pas être branchés en même temps.



# 3 PORTER L'OREILLETTE

## RÉGLAGE DE LA HAUTEUR

Obtenez un ajustement parfaitement adapté à votre oreille en réglant la hauteur du haut-parleur vers le haut ou vers le bas.

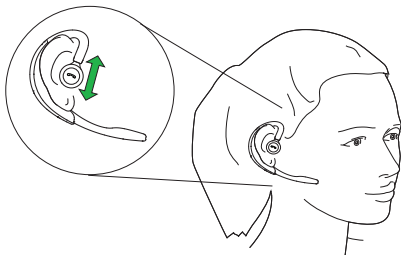

## STYLE DE PORT SUR L'OREILLE GAUCHE OU DROITE

L'oreillette peut se porter sur l'oreille gauche ou droite. Pour changer d'oreille :

1. Tirez le haut-parleur vers le bas, jusqu'au bout.
2. Tournez le haut-parleur de 180°.
3. Tournez l'Eargel pour l'ajuster à votre oreille.

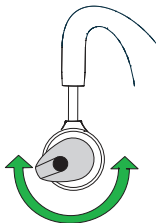
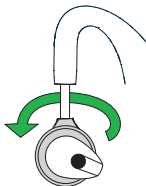
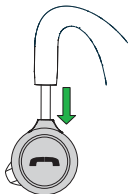

# 4 INSTRUCTIONS D'UTILISATION

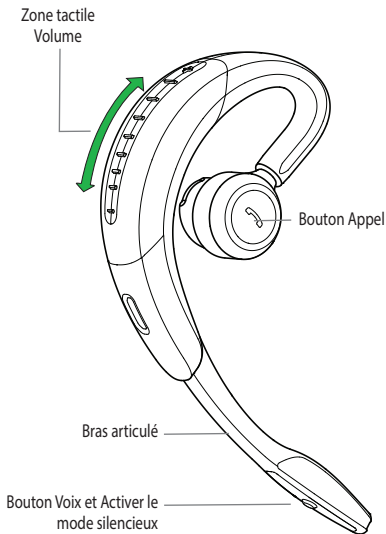





**VEILLE**



**APPEL ENTRANT**

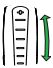

**EN CONVERSATION**

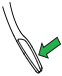
	FONCTION	ACTION
	Marche/arrêt de l'oreillette	Ouvrir/fermer le bras articulé
	Prendre un appel	Appuyez sur le bouton <b>Appel</b> de l'oreillette, ou appuyez sur le bouton <b>Répondre à l'appel</b> de l'écran tactile
	Terminer un appel	Appuyez sur le bouton <b>Appel</b> de l'oreillette, ou appuyez sur le bouton <b>Terminer/Rejeter l'appel</b> de l'écran tactile
	État temps de conversation	Lorsque vous n'êtes pas en conversation, appuyez sur le bouton <b>Appel</b> de l'oreillette
	Volume du haut-parleur	Faites glisser votre doigt vers le haut/bas sur le <b>zone tactile Volume</b>
	Changer de périphérique principal	Appuyez sur le périphérique connecté sur l'écran tactile pour changer le périphérique principal pour les appels
	Commandes vocales	Appuyez sur le bouton <b>Voix et Activer le mode silencieux</b> lorsque vous n'êtes pas en conversation jusqu'à ce que vous entendiez « Dire une commande ». Prononcez « Que puis-je dire ? » pour entendre la liste des commandes vocales
	Activer le mode silencieux	Appuyez sur le bouton <b>Voix et Activer le mode silencieux</b> pendant un appel

### Important !

Pour de plus amples informations concernant l'utilisation de Jabra Motion Office, consultez le site [jabra.com/motionoffice](http://jabra.com/motionoffice)



# PANORAMICA

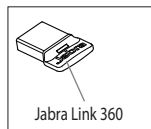
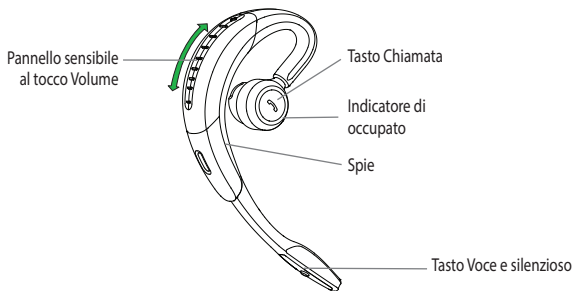

Dock per l'auricolare  
(Non può venire ruotato)

Touch screen

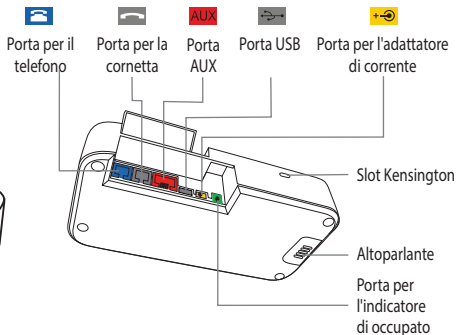
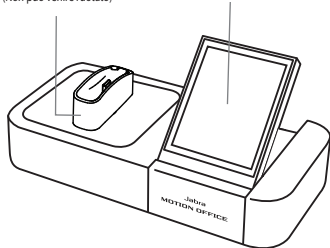

# 1 CONFIGURAZIONE DI BASE

ITALIANO

1

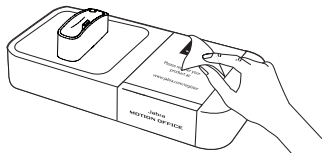

2



3

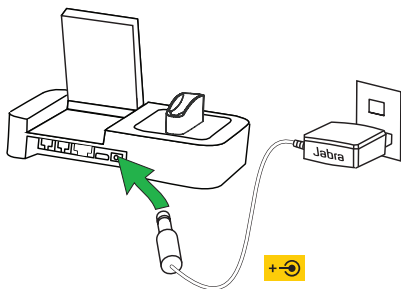

4

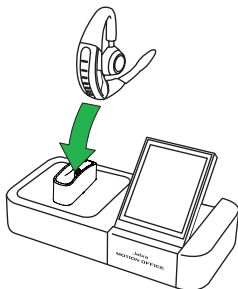

## Importante!

Scarica e installa la versione più recente del software Jabra dal sito [jabra.com/pcsuite](http://jabra.com/pcsuite) per usufruire delle funzionalità complete dell'auricolare.

# 2 CONNESSIONE AL TELEFONO O AL PC

## CONNESSIONE DI JABRA MOTION OFFICE

Quando la base viene collegata per la prima volta all'alimentazione, si avvia automaticamente la configurazione guidata. È possibile accedere alla configurazione guidata in qualsiasi momento tramite il menu touch screen.

1. Sfiora il menu delle impostazioni sul touch screen.
2. Sfiora Phone settings (Impostazioni telefono) > Setup wizard (Configurazione guidata).
3. Sfiora Confirm (Conferma) per avviare la configurazione guidata.



## CONNESSIONE A JABRA LINK 360

Jabra Link 360 permette di effettuare una connessione a un PC senza utilizzare la base e offre libertà wireless per quando sei in movimento.

Per connetterti, collega Jabra Link 360 a una porta USB disponibile del PC. L'auricolare e Jabra Link 360 vengono preconnessi al momento della produzione.



### Importante!

Jabra Link 360 e la base non devono venire mai connessi contemporaneamente.



# 3 INDOSSARE L'AURICOLARE

## REGOLAZIONE DELL'ALTEZZA

Otteni la vestibilità perfetta per il tuo orecchio regolando l'altezza dell'altoparlante verso l'alto o il basso.

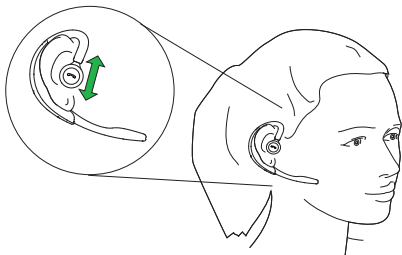

## TIPO DI INDOSSAGGIO SULL'ORECCHIO SINISTRO O DESTRO



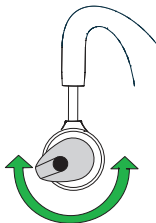
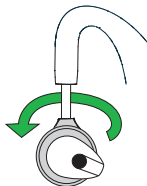
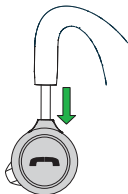

L'auricolare può venire indossato sull'orecchio sinistro o su quello destro. Per cambiare orecchio:

1. Tira l'altoparlante verso il basso fino in fondo.
2. Ruota l'altoparlante a 180°.
3. Sposta l'EarGel in modo che si adatti al tuo orecchio.

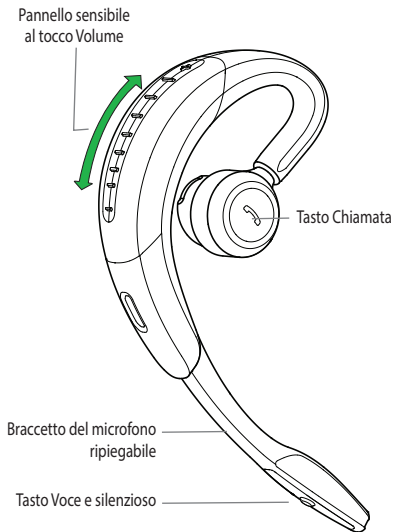

# 4 COME UTILIZZARLO

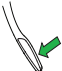

	FUNZIONE	AZIONE
	Spegnere/Accendere l'auricolare	Apri/Chiudi il braccetto del microfono
	Rispondere a una chiamata	Sfiora il tasto <b>Chiamata</b> sull'auricolare o il tasto <b>Rispondi alla chiamata</b> sul touch screen
	Terminare la chiamata	Sfiora il tasto <b>Chiamata</b> sull'auricolare o il tasto <b>Termina/Rifiuta la chiamata</b> sul touch screen
	Stato del tempo di conversazione	Sfiora il tasto <b>Chiamata</b> sull'auricolare quando non c'è una chiamata in corso
	Volume dell'altoparlante	Fai scorrere il dito verso l'alto o verso il basso sul <b>pannello sensibile al tocco Volume</b>
	Modificare il dispositivo primario	Sfiora un dispositivo connesso sul touch screen per cambiare il dispositivo primario per le chiamate
	Comandi vocali	Sfiora il tasto <b>Voce e silenzioso</b> quando non c'è una chiamata in corso fino a quando non senti "Pronuncia un comando". Pronuncia "Cosa posso dire?" per ascoltare l'elenco dei comandi vocali disponibili
	Silenziare il microfono	Sfiora il tasto <b>Voce e silenzioso</b> quando c'è una chiamata in corso

### Importante!

Per maggiori informazioni sull'uso di Jabra Motion Office, consulta il sito [jabra.com/motion](http://jabra.com/motion)

# OVERZICHT

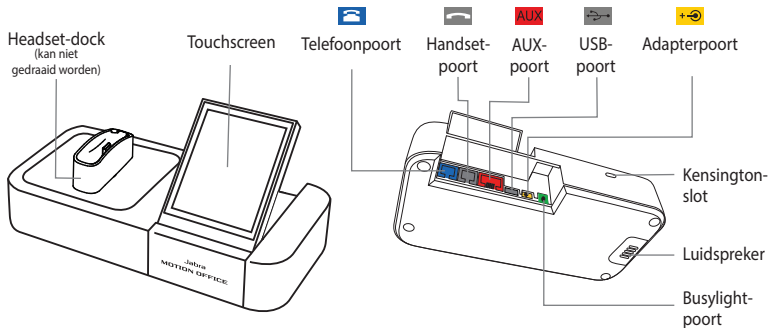
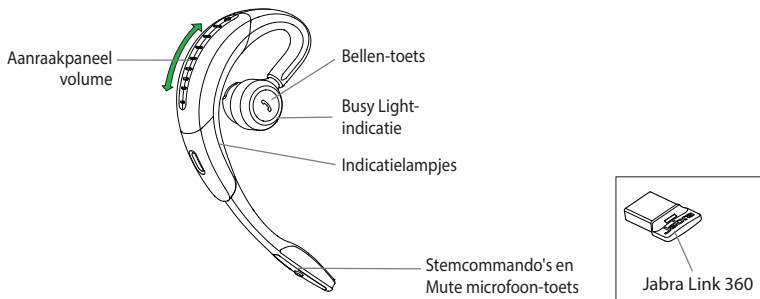

# 1 BASISCONFIGURATIE

NEDERLANDS

1

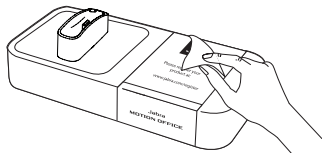

2

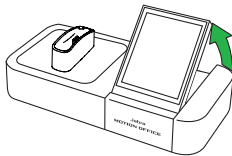

3

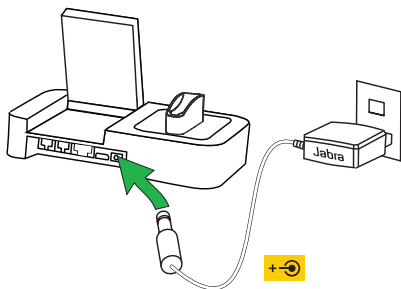

4

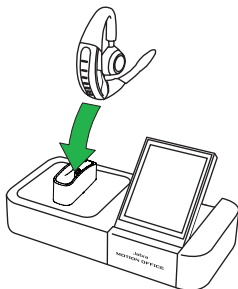

## Belangrijk!

Download en installeer de nieuwste Jabra-software van [jabra.com/pcsuite](http://jabra.com/pcsuite) voor volledige functionaliteit van uw headset.



# 2 VERBINDEN MET TELEFOON OF PC

## JABRA MOTION OFFICE VERBINDEN

De eerste keer dat het basisstation op de netstroom wordt aangesloten, start de installatiewizard automatisch. U kunt de installatiewizard ook starten via het menu van het touchscreen.

1. Tik op instellingenmenu op het touchscreen.
2. Tik op Phone settings (Telefooninstellingen) en vervolgens op Setup wizard (Installatiewizard).
3. Bevestig dit door op 'Confirm' te tikken en de installatiewizard te starten.



## JABRA LINK 360 VERBINDEN

De Jabra Link 360 stelt u in staat te verbinden met een PC zonder het basisstation, zodat u onderweg draadloze vrijheid heeft.

Om te verbinden, sluit u de Jabra Link 360 aan op een USB-poort van uw PC. De headset en de Jabra Link 360 zijn standaard al gekoppeld.



### Belangrijk!

De Jabra Link 360 en het basisstation kunnen niet tegelijkertijd aangesloten zijn.



# 3 DE HEADSET DRAGEN

## HOOGTE VERSTELLEN

Voor de optimale pasvorm voor uw oor, verstelt u de hoogte van de luidspreker.

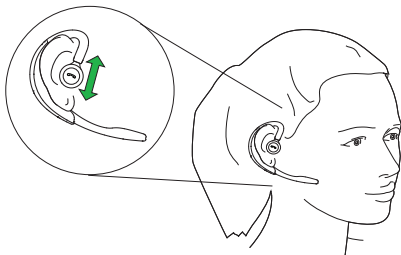

## DRAAGSTIJL LINKER OF RECHTEROOR

De headset kan zowel op het linker- als het rechteroor gedragen worden. Om het andere oor te gebruiken:

1. Trek de luidspreker helemaal omlaag.
2. Draai de luidspreker 180°.
3. Draai de oorgel zodat hij goed in uw oor past.

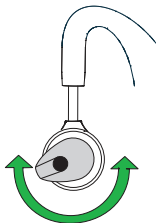
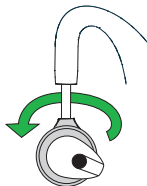
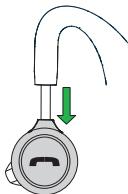

# 4 GEBRUIKEN

Volume  
aanraakpaneel

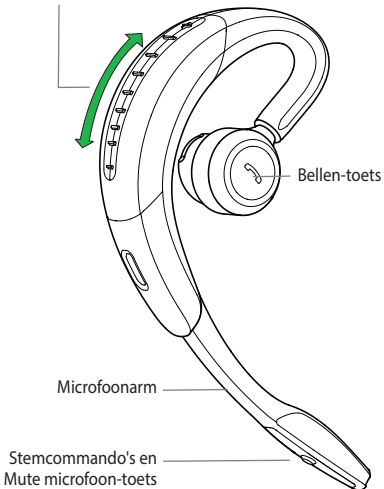

## INACTIEF

Menu Instellingen

Verbonden  
apparaten  
(primaire apparaat  
vooraan)

Oproep starten



## INKOMENDE OPROEP

Oproep  
beantwoorden

Oproep weigeren





## TIJDENS EEN GESPREK



Menu Belopties

Oproep op mute  
zetten

Gesprek beëindigen

	FUNCTIE	ACTIE
	Headset aan/uit	Klap de microfoonarm in/uit
	Oproep beantwoorden	Tik op de <b>Bellen</b> -toets van de headset of op de <b>Beantwoorden</b> -toets van het touchscreen
	Gesprek beëindigen	Tik op de <b>Bellen</b> -toets van de headset of op de <b>Beëindigen/Weigeren</b> -toets van het touchscreen
	Status gesprekstijd	Wanneer u niet aan de telefoon bent, tikt u op de <b>Bellen</b> -toets van de headset
	Luidsprekervolume	Wrijf met uw vinger omhoog/omlaag over het <b>Volumepaneel</b>
	Primair apparaat schakelen	Tik op een verbonden apparaat op het touchscreen om het primaire apparaat voor oproepen te wisselen
	Stemcommando's	Tik op de toets <b>Stemcommando's en Mute microfoon</b> wanneer u niet aan de telefoon bent, totdat u 'Geef een opdracht' hoort. Zeg 'Wat kan ik zeggen?' om de lijst met stemcommando's te beluisteren
	Mute-stand microfoon inschakelen	Tik tijdens een gesprek op de toets <b>Stemcommando's en Mute microfoon</b>

## Belangrijk!

Voor meer informatie over het gebruiken van de Jabra Motion Office kijkt u op [jabra.com/motionoffice](http://jabra.com/motionoffice)

# PRZEGLĄD

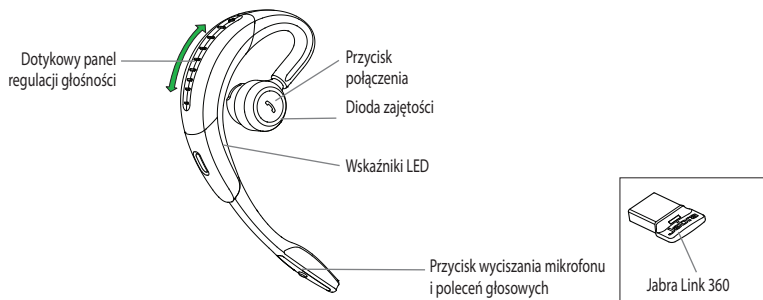

Stacja dokująca zestawu słuchawkowego (nie obraca się)

Ekran dotykowy

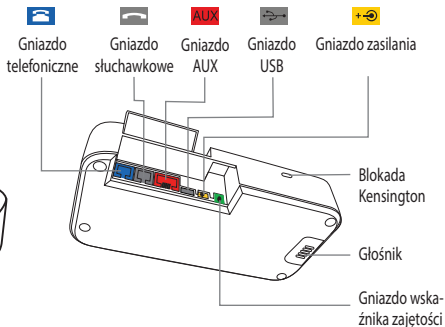
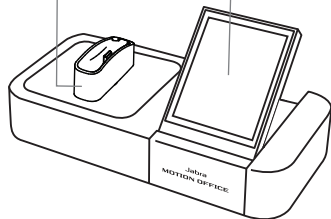

# 1 KONFIGURACJA PODSTAWOWA

POLSKI

1

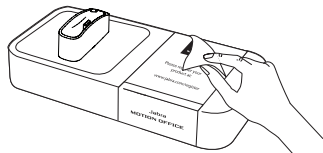

2

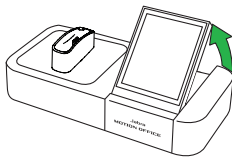

3

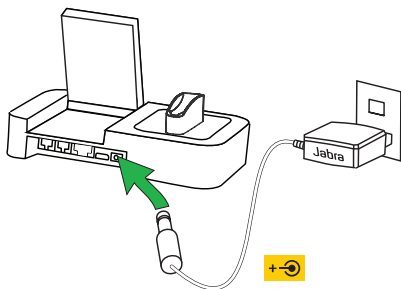

4

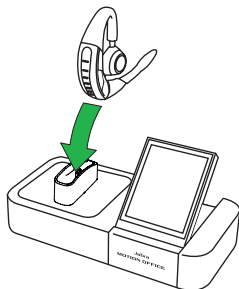

## Ważne!

Aby korzystać z wszystkich funkcji zestawu słuchawkowego, pobierz i zainstaluj najnowsze oprogramowanie Jabra, odwiedzając stronę [jabra.com/pcsuite](http://jabra.com/pcsuite).

# 2 ŁĄCZENIE Z TELEFONEM LUB KOMPUTEREM

## POŁĄCZENIE JABRA MOTION OFFICE

Po pierwszym podłączeniu stacji bazowej do zasilania zostanie uruchomiony kreator konfiguracji. Można go także uruchomić w dowolnej chwili za pośrednictwem ekranu dotykowego.

1. Dotknij menu Settings (Ustawień) na ekranie dotykowym.
2. Dotknij pozycji Phone settings (Ustawienia telefonu) > Setup wizard (Kreator konfiguracji).
3. Dotknij Confirm (Potwierdzenia), aby uruchomić kreatora konfiguracji.

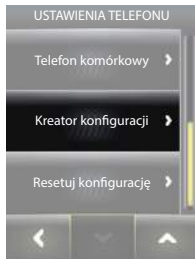

## POŁĄCZENIE JABRA LINK 360

Jabra Link 360 to połączenie z komputerem bez pośrednictwa stacji bazowej, zapewniające swobodę podczas podróży.

Aby nawiązać połączenie, podłącz urządzenie Jabra Link 360 do gniazda USB komputera. Zestaw słuchawkowy i urządzenie Jabra Link 360 są już fabrycznie sparowane.



### Ważne!

Nie należy jednocześnie podłączać urządzenia Jabra Link 360 i stacji bazowej.



# 3 SPOSÓB NOSZENIA ZESTAWU SŁUCHAWKOWEGO

## REGULACJA WYSOKOŚCI

Idealnie dopasuj zestaw do ucha, podnosząc lub opuszczając słuchawkę.

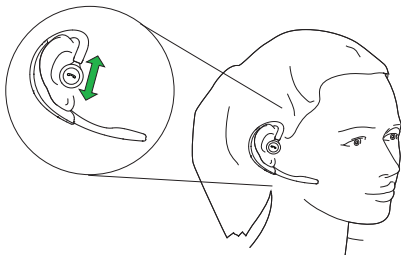

## NOSZENIE NA LEWYM LUB PRAWYM UCHU

Zestaw można nosić na lewym lub prawym uchu.

Aby zmienić ucho:

1. Pociągnij słuchawkę maksymalnie w dół.
2. Obróć głośnik o 180°.
3. Obróć wkładkę do ucha tak, aby dobrze ją dopasować.

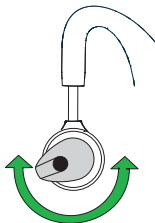
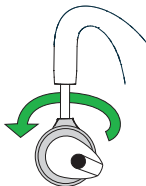
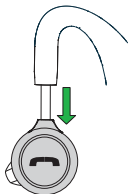



# 4 OBSŁUGA

Dotykowy panel regulacji głośności

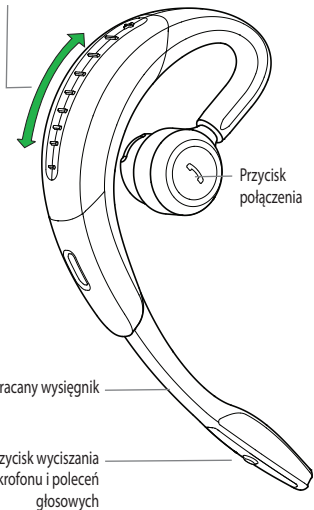

## OCZEKIWANIE







## POŁĄCZENIE PRZYCHODZĄCE



## ROZMOWA

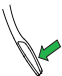

	FUNKCJA	DZIAŁANIE
	Włączanie/ wyłączanie zestawu słuchawkowego	Otwórz lub zamknij odwracany wysięgnik
	Odbieranie połączeń	Dotknij przycisku <b>połączenia</b> na zestawie słuchawkowym lub dotknij przycisku <b>odbierania połączenia</b> na ekranie dotykowym
	Kończenie połączenia	Dotknij przycisku <b>połączenia</b> na zestawie słuchawkowym lub dotknij przycisku <b>zakończenia/odrzucenia połączenia</b> na ekranie dotykowym
	Stan czasu rozmowy	Dotknij przycisku <b>połączenia</b> , kiedy nie prowadzisz rozmowy
	Głośność	Przesuń palec w górę/dół <b>na panelu regulacji głośności</b>
	Wybieranie urządzenia podstawowego	Dotknij podłączonego urządzenia na ekranie dotykowym, aby przyjmować połączenia za jego pośrednictwem
	Polecenia głosowe	Dotknij przycisku <b>wyciszania mikrofonu i poleceń głosowych</b> , gdy urządzenie nie jest używane do prowadzenia rozmowy, aż do usłyszenia polecenia „Wydadaj polecenie”. Wypowiedz polecenie „Co mogę powiedzieć?”, aby usłyszeć obsługiwane polecenia głosowe
	Wyciszenie mikrofonu	Dotknij przycisku <b>wyciszania mikrofonu i poleceń głosowych</b> podczas prowadzenia rozmowy.

### Ważne!

Aby uzyskać więcej informacji na temat Jabra Motion Office, odwiedź stronę [jabra.com/motionoffice](http://jabra.com/motionoffice)

# VISTA GERAL

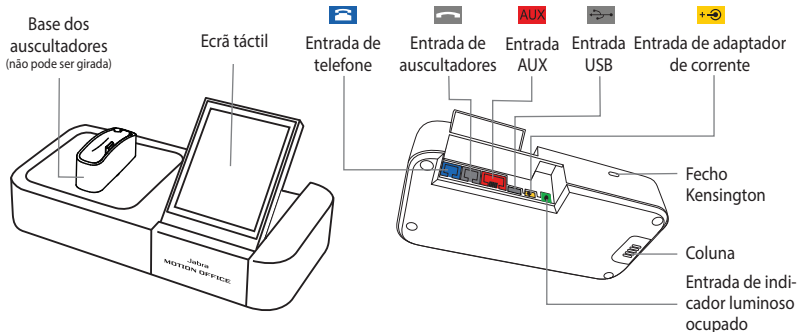
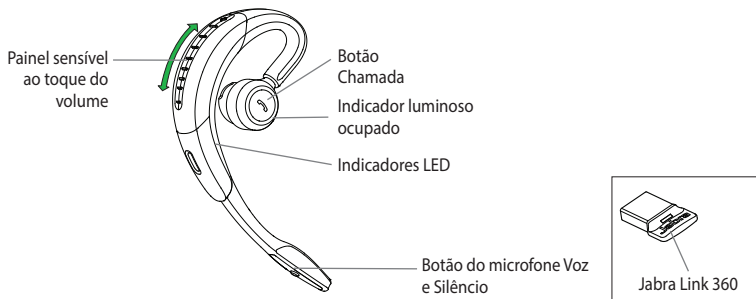

# 1 CONFIGURAÇÃO BÁSICA

PORTUGUÊS

1

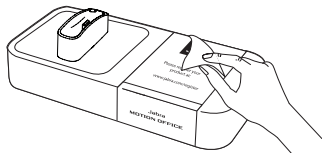

2



3

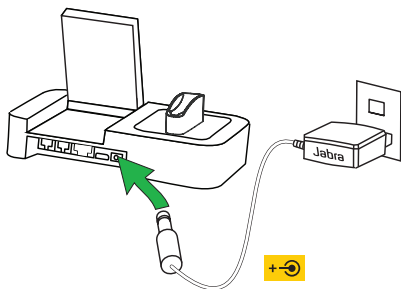

4

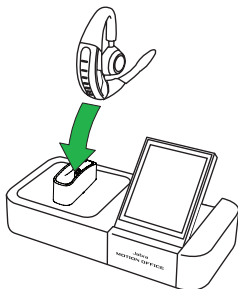

## Importante!

Proceda ao download e instalação do mais recente software Jabra em [jabra.com/pcsuite](http://jabra.com/pcsuite) para obter uma funcionalidade completa dos auscultadores.

# 2 LIGAÇÃO A UM TELEFONE OU PC

## JABRA MOTION OFFICE CONNECTION

O assistente de configuração inicia-se automaticamente na primeira vez que a base é ligada à corrente. O assistente de configuração também pode ser acedido a qualquer altura através do menu do ecrã táctil.

1. Toque no menu de Definições do ecrã táctil.
2. Toque em "Phone settings" (Definições do telefone) > "Setup wizard" (Assistente de configuração).
3. Toque em "Confirm" (Confirmar) para iniciar o Assistente de Configuração.



## LIGAÇÃO JABRA LINK 360

O Jabra Link 360 permite a ligação a um PC sem a base, oferecendo-lhe liberdade sem fios sempre que viajar.

Para efectuar a ligação, basta ligar o Jabra Link 360 a uma entrada USB do seu PC. Os auscultadores e o Jabra Link 360 já se encontram pré-emparelhados.



### Importante!

O Jabra Link 360 e a base não devem estar ligados em simultâneo.



# 3 USAR OS AUSCULTADORES

## AJUSTE DA ALTURA

Obtenha o encaixe perfeito na sua orelha ajustando a altura da coluna para cima ou para baixo.

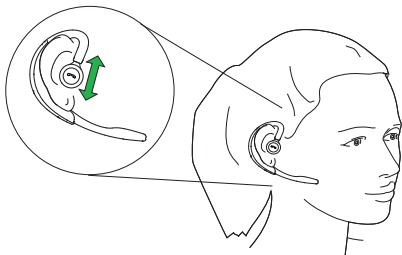

## COLOCAÇÃO NA ORELHA ESQUERDA OU DIREITA

O auricular pode ser usado na orelha esquerda ou direita. "Mudar" de orelha:

1. Puxe completamente a coluna para baixo.
2. Gire a coluna em 180°.
3. Torça o gel auricular à volta para encaixar na sua orelha.

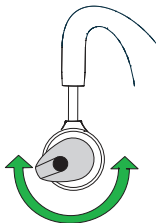
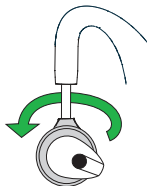
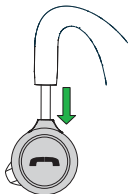

# 4 COMO UTILIZAR

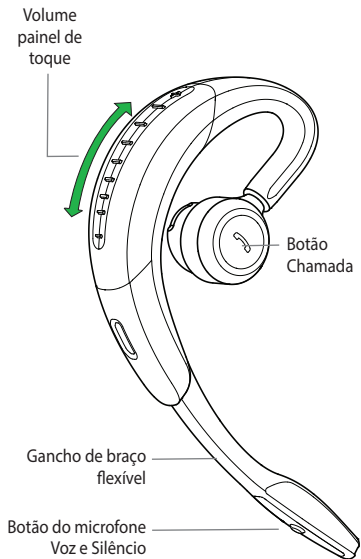

## EM PAUSA

Menu de definições

Dispositivos ligados (dispositivo primário dianteiro)

Iniciar chamada



## A RECEBER CHAMADA

Atender chamada

Rejeitar chamada







## EM CHAMADA

Menu de opções de chamada

Silenciar chamada

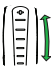
Terminar chamada

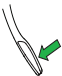
	FUNÇÃO	ACÇÃO
	Ligar/desligar auscultadores	Abrir/fechar o gancho de braço flexível
	Atender chamada	Prima o botão <b>Chamada</b> dos auscultadores ou prima o botão <b>Atender chamada</b> do ecrã táctil
	Terminar chamada	Prima o botão <b>Chamada</b> dos auscultadores ou prima o botão <b>Terminar/rejeitar chamada</b> do ecrã táctil
	Estado de tempo de conversação	Sempre que não estiver a efectuar uma chamada, prima o botão <b>Chamada</b> dos auscultadores
	Volume da coluna	Deslize um dedo para cima/baixo no <b>painel sensível ao toque do Volume</b>
	Ligação de dispositivo primário	Prima um dispositivo ligado no ecrã táctil para ligar o dispositivo primário de forma a efectuar ou receber chamadas
	Comandos de voz	Toque no botão do <b>microfone Voz e Silêncio</b> quando não estiver a atender uma chamada até ouvir "Say a command". Diga "What can I say?" para uma lista de comandos de voz
	Silenciar microfone	Toque no botão do <b>microfone Voz e Silêncio</b> durante uma chamada

### Importante!

Para obter mais informação sobre como utilizar o Jabra Motion Office, entre em [jabra.com/motionoffice](http://jabra.com/motionoffice)



# ОБЗОР

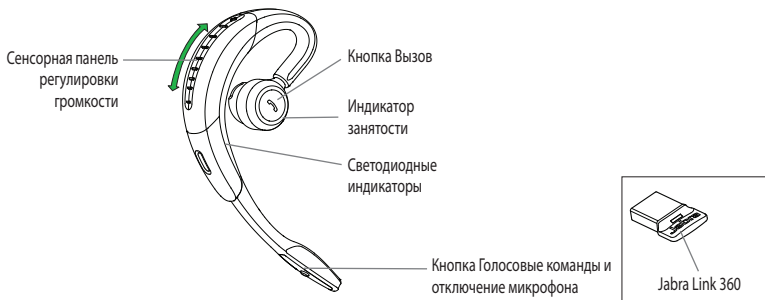

База гарнитуры  
(не может вращаться)

Сенсорный экран



Телефонный разъем



Разъем для гарнитуры



AUX-разъем



USB-разъем



Разъем для адаптера питания

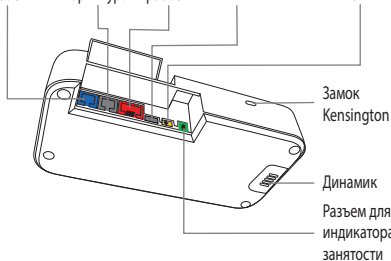
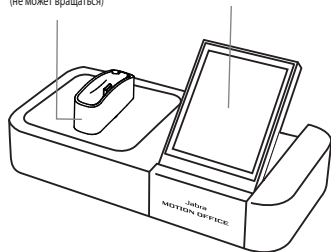

# 1 УСТАНОВКА БАЗЫ

РУССКИЙ

1

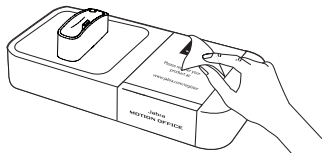

2



3

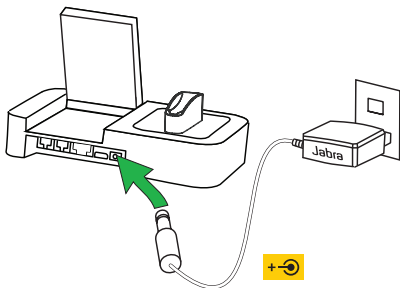

4

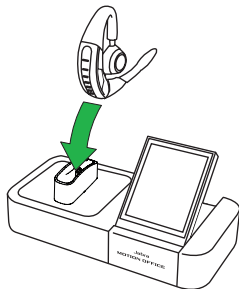

## Важно!

Для полной функциональности гарнитуры загрузите и установите последнюю версию программного обеспечения Jabra с сайта [jabra.com/pcsuite](http://jabra.com/pcsuite).

# 2 ПОДКЛЮЧЕНИЕ К ТЕЛЕФОНУ ИЛИ ПК

## ПОДКЛЮЧЕНИЕ JABRA MOTION OFFICE

Мастер настройки автоматически запускается после первого включения базы. Однако к нему можно также в любое время получить доступ с помощью меню сенсорного экрана.

1. Кратковременно нажмите меню Settings (Настройки) на сенсорном экране.
2. Кратковременно нажмите «Phone settings» (Настройки телефона) > «Setup wizard» (Мастер настройки).
3. Кратковременно нажмите «Confirm» (Подтвердить), чтобы запустить мастер настройки.

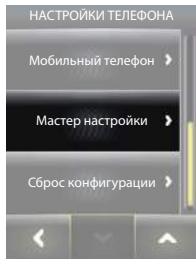

## ПОДКЛЮЧЕНИЕ JABRA LINK 360

Jabra Link 360 используется для подключения гарнитуры к ПК без базы, обеспечивая беспроводную свободу во время поездки.



Для подключения просто вставьте Jabra Link 360 в USB-разъем ПК. Гарнитура и Jabra Link 360 предварительно сопряжены.

### Важно!

Не подключайте одновременно Jabra Link 360 и базу.



# 3 НОШЕНИЕ ГАРНИТУРЫ

## РЕГУЛИРОВКА ПО ВЫСОТЕ

Регулируемый по высоте динамик обеспечивает максимально комфортное восприятие на слух.

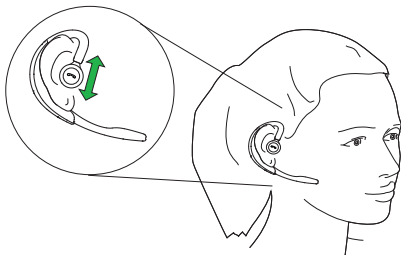

## СПОСОБ НОШЕНИЯ НА ЛЕВОМ ИЛИ ПРАВОМ УХЕ

Гарнитуру можно носить как на левом, так и на правом ухе. Чтобы надеть гарнитуру на другое ухо:

1. Потяните динамик вниз до упора.
2. Поверните динамик на 180°.
3. Поверните гелевый ушной вкладыш для оптимального удобства ношения.

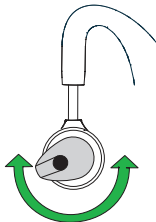
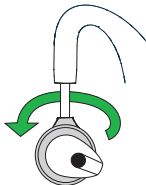
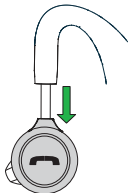

# 4 ИСПОЛЬЗОВАНИЕ

Сенсорная панель  
регулировки громкости

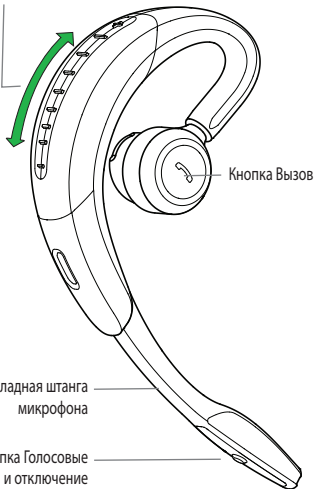

**ВО ВРЕМЯ БЕЗДЕЙСТВИЯ**

Меню Настройки

Подключенные  
устройства (первичное устройство на переднем плане)

Инициирование  
вызова



**ВХОДЯЩИЙ ЗВОНОК**

Ответ на вызов

Отклонение вызова



**ВО ВРЕМЯ ВЫЗОВА**

Меню настроек  
вызовов

Отключение звука

Окончание вызова

	ФУНКЦИЯ	ДЕЙСТВИЕ
	Вкл./выкл. гарнитуры	Разверните или сверните складную штангу микрофона
	Ответ на вызов	Кратковременно нажмите кнопку <b>Вызов</b> на гарнитуре или кратковременно нажмите кнопку <b>Ответ на вызов</b> на сенсорном экране
	Окончание вызова	Кратковременно нажмите кнопку <b>Вызов</b> на гарнитуре или кратковременно нажмите кнопку <b>Окончание/отклонение вызова</b> на сенсорном экране
	Время работы в режиме разговора	Кратковременно нажмите кнопку <b>Вызов</b> на гарнитуре, когда не разговариваете по телефону
	Громкость динамика	Проведите пальцем вверх или вниз по <b>Сенсорной панели регулировки громкости</b>
	Выбор первичного устройства	Кратковременно нажмите на подключенное устройство на сенсорном экране для выбора первичного устройства для совершения звонков
	Голосовые команды	Кратковременно нажмите кнопку <b>Голосовые команды и отключение микрофона</b> , когда не разговариваете по телефону, пока не услышите сообщение «Произнесите команду!». Скажите «Что сказать?» для получения списка голосовых команд
	Отключение микрофона	Кратковременно нажмите кнопку <b>Голосовые команды и отключение микрофона</b> во время вызова

### Важно!

Более подробную информацию об использовании Jabra Motion Office см. на сайте [jabra.com/motionoffice](http://jabra.com/motionoffice)

# GENEL BAKIŞ

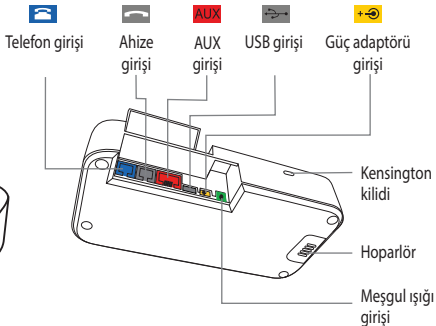
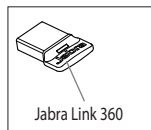
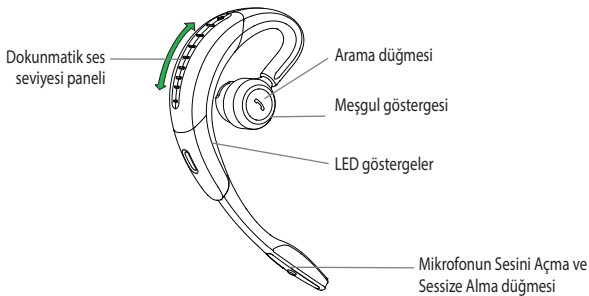

# 1 TEMEL KURULUM

TÜRKÇE

1

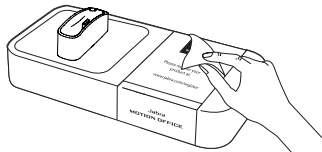

2



3

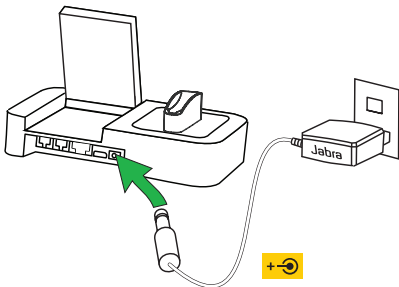

4

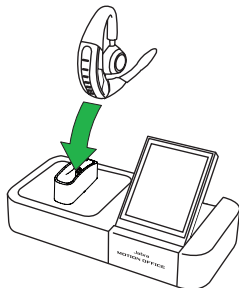

## Önemli!

Kulaklığın tüm fonksiyonlarını güncel hâline getirmek için [jabra.com/pcsuite](http://jabra.com/pcsuite) adresinden en son Jabra yazılımını indirin ve kurun.



# 2 TELEFONA VEYA PC'YE BAĞLANMA

## JABRA MOTION OFFICE BAĞLANTISI

Kulaklığın dock ünitesini elektrığe bağlayıp ilk çalıştırdığınız zaman, otomatik olarak kurulum sihirbazı başlatılacaktır. Kurulum sihirbazına istenildiğinde sonradan da dokunmatik ekran menüsü üzerinden erişilebilir.

1. Dokunmatik ekranda Ayarlar menüsüne dokununuz.
2. Phone settings (Telefon ayarları) > Setup wizard (Kurulum sihirbazı) üzerine dokununuz.
3. Setup wizard'ı (Kurulum sihirbazı) başlatmak için Confirm (Onayla) üzerine dokununuz.



## JABRA LINK 360 BAĞLANTISI

Jabra LINK 360, dock ünitesi olmadan PC ile bağlantı kurar; bu sayede, seyahatlerinizde kablosuz kullanımdan faydalanabilirsiniz.

Bağlantıyı kurmak için, Jabra Link 360'ı PC'nizdeki bir USB girişine takmanız yeterlidir. Kulaklık ve Jabra Link 360, eşleştirilmiş olarak gelir ve yeniden eşleştirilmelerine gerek yoktur.



### Önemli!

Jabra Link 360 ve dock ünitesi, PC'ye aynı anda takılmamalıdır.



# 3 KULAKLIĞIN KULLANIMI

## YÜKSEKLİK AYARI

Size uyan en rahat takma şekli için kulaklığın yüksekliğini aşağı veya yukarı ayarlayabilirsiniz.

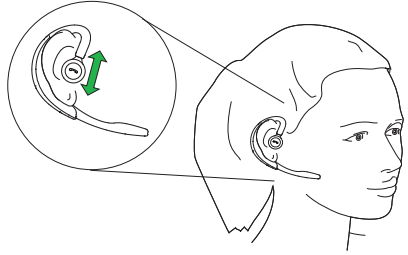

## SAĞ VEYA SOL KULAĞA TAKMA ŞEKİLLERİ

Mikrofonlu kulaklığınızı sağ veya sol kulağınıza takabilirsiniz. Cihazı bir kulaktan diğerine geçirmek için:

1. Kulaklığı aşağıya kadar çekin.
2. Hoparlörü 180° döndürün.
3. Silikon kulaklık başlığını kulağınıza uyacak şekilde çevirerek yerleştirin.

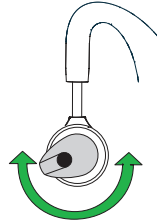
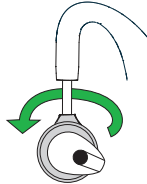
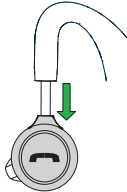

# 4 KULLANIM

Dokunmatik ses seviyesi paneli

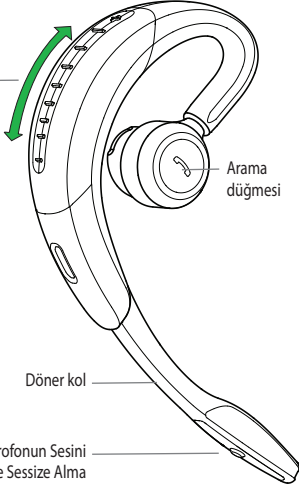

Mikrofonun Sesini  
Açma ve Sessize Alma  
düğmesi

## BOŞTAYKEN



Ayarlar menüsü

Bağlı cihazlar  
(öncelikli cihaz önde  
olacak şekilde)

Aramayı başlatma

## GELEN ARAMADA



Aramayı cevaplama

Aramayı reddetme





## ARAMA SIRASINDA



Arama seçenekleri  
menüsü

Aramayı sessize alma

Aramayı sonlandırma

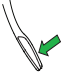
	FONKSİYON	YAPILMASI GEREKEN
	Kulaklığı Açma/ Kapama	Döner kolu açın veya kapatın
	Aramayı cevaplama	Kulaklıktaki <b>Arama</b> düğmesine basın veya dokunmatik ekrandaki <b>Aramayı cevaplama</b> düğmesine dokununuz
	Aramayı sonlandırma	Kulaklıktaki <b>Arama</b> düğmesine basın veya dokunmatik ekrandaki <b>Aramayı Sonlandırma/Reddetme</b> düğmesine dokununuz
	Konuşma süresi durumu	Aramada olmadığınız bir anda, kulaklıkta bulunan <b>Arama</b> düğmesine basın
	Hoparlör ses seviyesi	Bir parmağınızı <b>Dokunmatik ses seviyesi panelinin</b> üzerinde aşağı veya yukarı kaydırın
	Öncelikli cihazı değiştirme	Aramalarda öncelikli olarak kullanılacak cihazı, dokunmatik ekranda görünen bağlı cihazlardan birini seçerek değiştirin
	Sesli komutlar	Görüşme yapmadığınız bir sırada "Say a command" komutunu duyana dek <b>Mikrofonun Sesini Açma ve Sessize Alma</b> düğmesine dokununuz. Sesli komutların tümünü içeren listeye ulaşmak için, "What can I say?" komutunu söyleyin
	Mikrofonu sessize alma	Arama sırasında <b>Mikrofonun Sesini Açma ve Sessize Alma</b> düğmesine dokununuz

## Önemli!

Jabra Motion Office'in kullanımıyla ilgili ayrıntılı bilgi için [jabra.com/motionoffice](http://jabra.com/motionoffice) adresini ziyaret edin