



SPARE PARTS EXPLODED VIEW
STORAGE ELECTRIC WATER HEATERS

Model

ABS ANDRIS LUX

R8217264-02 - 07/01/2016

ABS ANDRIS LUX

Storage Electric Water Heaters

1	3100604	ABS ANDRIS LUX 10 OR	08-2015	-
2	3100605	ABS ANDRIS LUX 10 UR	08-2015	-
3	3100606	ABS ANDRIS LUX 15 OR	08-2015	-
4	3100607	ABS ANDRIS LUX 15 UR	08-2015	-
5	3100608	ABS ANDRIS LUX 30	08-2015	-
Col	Reference	Model type	Begin	End

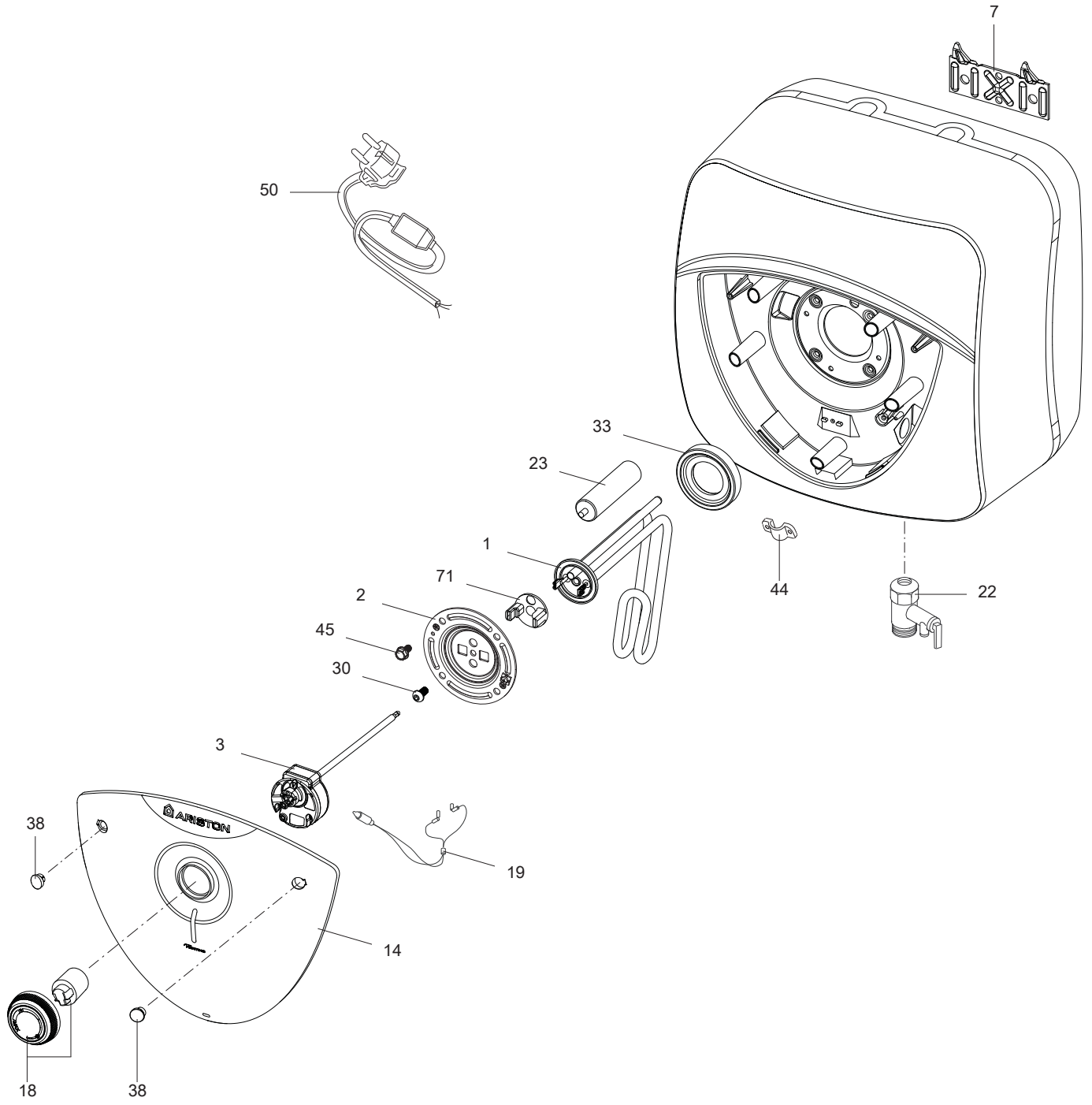

☉	Description	Manf. Pt. N	Type	ABS ANDRIS LUX 10 OR ABS ANDRIS LUX 10 UR ABS ANDRIS LUX 15 OR ABS ANDRIS LUX 15 UR ABS ANDRIS LUX 30																		31	
				1	2	3	4	5	6	7	8	9	10	11	12	13	14	15	16	17	18	From	to
0001	НАГРЕВАТЕЛЬНЫЙ ЭЛЕМЕНТ 1200W 220-240V	65114900					●	●															
	НАГРЕВАТЕЛЬНЫЙ ЭЛЕМЕНТ 1200W 220-240V	65114905		●	●																		
	НАГРЕВАТЕЛЬНЫЙ ЭЛЕМЕНТ 1500W 220-240V	65114894							●														
0002	ФЛАНЕЦ НА 4 БОЛТАХ	65114661		●	●	●	●	●													12/15		
	ФЛАНЕЦ НА 4 БОЛТАХ	65115359		●	●	●	●	●												01/16			
0003	ТЕРМОСТАТ	65114891							●														
	ТЕРМОСТАТ	65114908		●																			
	ТЕРМОСТАТ	65115012			●																		
	ТЕРМОСТАТ	65115013					●																
	ТЕРМОСТАТ	65115014						●															
0007	КРОНШТЕЙН	570341		●	●	●	●	●															
0014	КРЫШКА ПЛАСТИКОВАЯ	65115145		●	●	●	●	●															
	КРЫШКА ПЛАСТИКОВАЯ	65115148							●														
0018	РУЧКА РЕГУЛИРОВКИ	65115024		●	●	●	●	●															
0019	ИНДИКАТОРНАЯ ЛАМПА	65111550		●	●	●	●	●															
0022	ПРЕДОХРАНИТЕЛЬНЫЙ КЛАПАН (1/2" 8,5 БАР)	571730		●	●	●	●	●															
0023	МАГНИЕВЫЙ АНОД D:21,3 L:110 M5-M8	65103768-01		●	●	●	●	●															
0030	ВИНТ M6X12	993000		●	●	●	●	●															
0033	ПРОКЛАДКА ФЛАНЦА	65114660		●	●	●	●	●															
0038	ЗАГЛУШКА	65115133		●	●	●	●	●															
0044	ЗАЖИМ ДЛЯ КАБЕЛЯ	573266		●	●	●	●	●															
0045	ВИНТ M6X12	65114656		●	●	●	●	●															
0050	КАБЕЛЬ ПИТАНИЯ С УЗО	65151908		●	●	●	●	●															
0071	ИЗОЛЯТОР КЛЕММ ТЭНА (GREEN)	65114895						●															
	ИЗОЛЯТОР КЛЕММ ТЭНА (YELLOW)	65114901		●	●	●	●																

LIST OF THE ABBREVIATIONS

HW	: Hot water.
CW	: Cold water.
C	: Ceramic resistance (normal heating).
Ca	: Ceramic resistance (accelerated heating)
TP	: Immersion heater.
1F	: With fittings.
2F	: Without fittings.
3F	: With fittings and another outlet connection.
AMI	: With mixing valve.
SMI	: Without mixing valve.
PUISS	: Power of the appliance.
PN	: Appliance with normal pressure.
LP	: Appliance with low pressure.
PV	: Appliance with variable power.
PF	: Appliance with fixed power.

IDENTIFICATION PLATE

SERIAL NUMBER

6 Characters :
Year of manufacture: 03 09 08
Manufacturing day
Month of manufacture

9 Characters :
Year of manufacture: M 12 10 0606
Month of manufacture
Sequential number

14 Characters :
SI-V-0B0 45 07 0001
Sequential number
Year of manufacture : → 6 → 2004
Month of manufacture : → 25 → January 43 → July 7 → 2005
→ 13 → February 29 → August 8 → 2006
→ 32 → March 40 → September etc ...
→ 35 → April 38 → October
→ 39 → May 51 → November
→ 45 → June 12 → December
Product model

15 Characters :
Year of manufacture: 02 11 00001 007843
Month of manufacture
Code appareil
Sequential number

21 Characters :
3200050 XX 08115 0000001
Product reference
Sequential number
Year (08) / Manufacturing day (115)

22 Characters :
3200050 XX 070115 0000001
Product reference
Sequential number
Year (07) / Month (01) / Manufacturing day (15)