



EUROPEAN UNION
European Regional Development Fund
Operational Programme Enterprise
and Innovations for Competitiveness

B&BARTONI CONSUMABLE PARTS SUITABLE FOR

HIFOCUS 100®

B&BARTONI CONSUMABLE PARTS

B&Bartoni is a world-class manufacturer of plasma consumables with production solely in the Czech Republic, Europe.

Main advantage of the B&Bartoni brand is quality comparable to OEM manufacturers due to using identical materials, precise machinery and highly qualified staff.

B & B
BARTONI®
CONSUMABLEPARTS

B&BARTONI, SPOL. S R. O.
DOUBRAVIČKA 18
294 30 DOLNÍ CETNO
CZECH REPUBLIC

TEL.: +420 326 335225
FAX: +420 326 335942
E-MAIL: INFO@B-BARTONI.CZ
WWW.B-BARTONI.CZ

ID No: 26763915, Company registration at Municipal court of Prague, file No: C 92109



EUROPEAN UNION
European Regional Development Fund
Operational Programme Enterprise
and Innovations for Competitiveness

B&BARTONI CONSUMABLE PARTS SUITABLE FOR HIFOCUS 100®

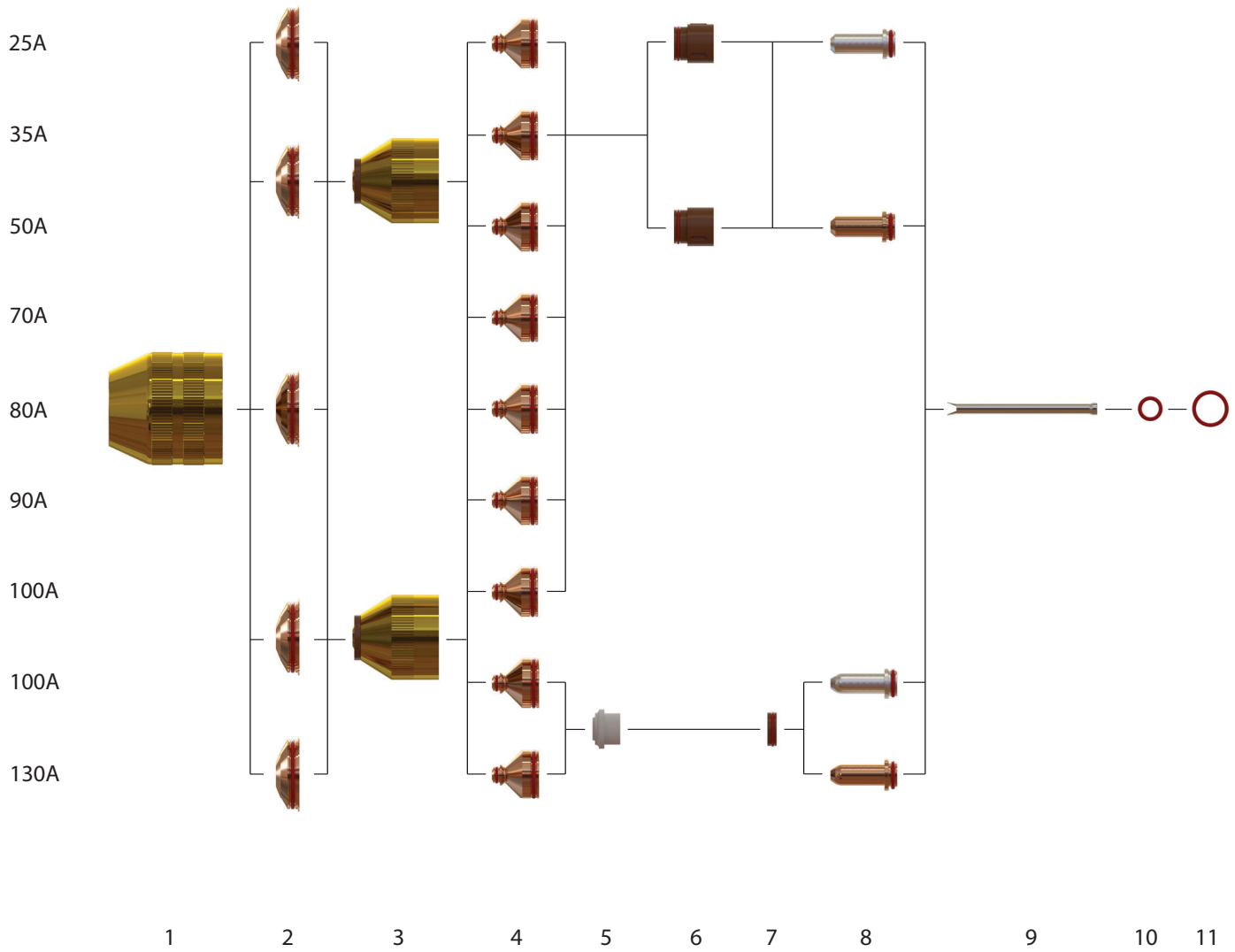



EUROPEAN UNION
European Regional Development Fund
Operational Programme Enterprise
and Innovations for Competitiveness

B&BARTONI CONSUMABLE PARTS SUITABLE FOR HIFOCUS 100®

ITEM	REF. NUMBER	ORDER NUMBER	DESCRIPTION
01.	B.11.835.201.081	BP-30401	Shield cap Z501
02.	B.11.835.201.1561	BP-30402	Shield Z4015 - ø 1,5mm
	B.11.835.201.1571	BP-30403	Shield Z4020 - ø 2,0mm
	B.11.835.201.1581	BP-30404	Shield Z4025 - ø 2,5mm
	B.11.835.201.1591	BP-30405	Shield Z4030 - ø 3,0mm
	B.11.835.401.1571	BP-30406	Shield Z4140 - ø 4,0mm
03.	B.11.835.201.160	BP-30407	Retaining cap Z3004 - ø 0,4mm
04.	B.11.835.221.406	BP-30408	Nozzle Z2006 - ø 0,6mm, 25A, O2
	B.11.835.221.407	BP-30409	Nozzle Z2007 - ø 0,7mm, 35A, O2
	B.11.835.221.408	BP-30410	Nozzle Z2008 - ø 0,8mm, 50A, O2
	B.11.835.221.409	BP-30411	Nozzle Z2009 - ø 0,9mm, 70A, O2
	B.11.835.221.410	BP-30412	Nozzle Z2010 - ø 1,0mm 80A, O2
	B.11.835.221.411	BP-30413	Nozzle Z2011 - ø 1,1mm, 90A, O2
	B.11.835.221.412	BP-30414	Nozzle Z2012 - ø 1,2mm, 100A, O2
05.	B.11.835.221.153	BP-30415	Swirl ring Z101 - 3 holes (vespel®)
06.	B.11.835.221.3101AG	BP-30416	Cathode Z002 - XL O2 SILVER
	B.11.835.221.3101SC	BP-30424	Cathode Z002 - XL O2 SilverCore
07.	B.11.835.201.162	BP-30417	Retaining cap Z3008 - ø 0,8mm
08.	B.11.835.421.412	BP-30418	Nozzle Z2112 - ø 1,2mm, 100A, O2
	B.11.835.421.414	BP-30419	Nozzle Z2114 - ø 1,4mm, 130A, O2
09.	B.11.834.321.153	BP-30208	Swirl ring Z111 (vespel®)
10.	B.11.835.421.303	BP-30420	Spacer ring Z111A (vespel®)
11.	B.11.835.421.3101AG	BP-30421	Cathode Z012 - XL O2 SILVER
	B.11.835.421.3101SC	BP-30425	Cathode Z012 - XL O2 SilverCore
12.	B.11.835.201.152	BP-30422	Cooling tube - PerCut 101
13.	B.10.575.052	BP-30109	O - ring 20x2 silicone
14.	B.10.505.946	BP-30423	O - ring 36x2 silicone



EUROPEAN UNION
European Regional Development Fund
Operational Programme Enterprise
and Innovations for Competitiveness

B&BARTONI CONSUMABLE PARTS SUITABLE FOR HIFOCUS 100®

GOALS OF B&BARTONI

Our goal is providing price competitive products while maintaining high quality.

Our aims are realized by:

- efficient use of the best input materials
- professional workforce
- technological background
- focus on innovation

WHY PURCHASE B&BARTONI CONSUMABLES?

- We provide free testing samples
- We help you to choose the right product
- B&Bartoni consumables are fully compatible with OEM parts and have comparable quality while reaching competitive prices
- Torch service and general repairs

B&Bartoni product range contains wide spectre of consumables from the most common OEM manufacturers as well as those rare ones. Please do not hesitate to inquire our sales representatives for availability to info@b-bartoni.cz or on the phone no. +420 326 335 225

ISO 9001:2009

KJELLBERG®, HIFOCUS 100® are the Registered Trademarks of KJELLBERG®. B&BARTONI, spol. s r.o. is in no way affiliated with KJELLBERG®. The parts advertised for sale are not genuine KJELLBERG® parts, but are parts made for and by B&BARTONI, spol. s r.o.. Reference to KJELLBERG® machine, torches and numbers are for your convenience only. We reserve the right to substitute genuine KJELLBERG® parts in place of B&BARTONI, spol. s r.o. parts. Parts indicated with a "OEM" are original parts manufactured by the above named manufacturer and are being resold by B&BARTONI, spol. s r.o.

B & B
BARTONI
CONSUMABLEPARTS