

A12-80S

KVAZAR

► **Technology:**

- ✓ Valve Regulated Lead Acid Battery / VRLA
- ✓ Sealed Maintenance Free / SMF
- ✓ AGM technology
- ✓ Complied with IEC60896-21/22 or IEC61056-1/2

► **Main Features:**

- ◆ Innovated technology of battery plate formula designed for Deep Discharge.
- ◆ Outstanding re-charge acceptability after deep discharged.
- ◆ Extreme low self-discharge, low internal resistance and low internal pressure.
- ◆ Long Life - Assembly using thicker plate with special chemical formation.

► **Main Application:**

- Sizable and critical UPS systems
- Solar PV & Wind power
- Off-grid power system / Power plant
- Medical power assurance
- Telecom & Towers power assurance
- High performance UPS system
- Deep cycle discharge
- Industrial battery & power reserve
- All general purpose

GEM Battery | GM Series batteries are designed at a larger size and higher capacity carrying more energy power to support more-power-requiring applications.

- ① Adopted with latest and most advanced AGM technology for assembly.
- ② Thick and strengthened plates with anti-corruption designed for long life time.
- ③ Using high purity metal lead/Pb during the production to assure low self-discharge and high power efficiency.
- ④ Flame Retardant UL94 V-0 available on request.

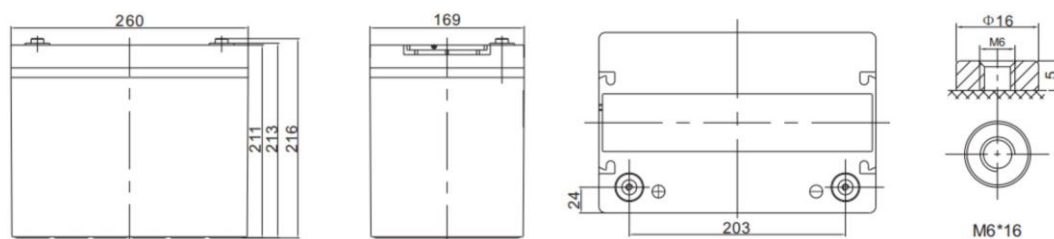

Model	GM 12-80		IR	Dimensions (mm ±2)				Weight	Terminal	
Voltage (V)	Nominal Capacity (25°C)		mΩ (25°C)	Length	Width	Height	Total Height	Kgs ±5%	L4	T4
12	80Ah	10Hr (10.8V)	6	260	169	213	216	22.5		M6*16

Capacity Range (25°C)	20Hr (10.8V)	5Hr (10.5V)	3Hr (9.60V)	1Hr (9.60V)	Designed Life (25°C)	Separator	Electrolyte	Case	Sealing
	84Ah	69.2Ah	61.6Ah	48.8Ah	10 Years (Float charging)	AGM	Sulfuric Acid	ABS plastic	Epoxy Glue

Max. Current (A)		Charge Voltage @25°C		Self-discharge		Capacity Effected by Temp. @20Hr			
Charge	Discharge	Float use	13.5-13.8V (-18mV/°C)	per month @25°C	40°C	25°C	0°C	-15°C	
20A	800A (5s)	Cycle use	14.4-14.7V (-30mV/°C)	3%	102%	100%	85%	65%	

● **Constant-Current (A) Discharge / CCD @25°C**

End V./VPC	5min	10min	15min	30min	1Hr	2Hr	3Hr	5Hr	10Hr	20Hr
9.60 / 1.60	-	168.00	132.00	80.00	49.60	29.20	20.40	14.30	8.14	4.28
9.90 / 1.65	-	163.00	129.00	78.40	48.90	29.10	20.30	14.20	8.13	4.27
10.2 / 1.70	-	156.00	124.00	76.00	47.60	28.80	20.10	14.10	8.10	4.25
10.5 / 1.75	-	150.00	120.00	74.20	46.70	28.40	20.00	14.00	8.06	4.23
10.8 / 1.80	-	141.00	114.00	71.40	45.20	27.60	19.40	13.60	8.00	4.20

● **Constant-Power (Watt) Discharge / CPD @25°C**

End V./VPC	5min	10min	15min	30min	1Hr	2Hr	3Hr	5Hr	10Hr	20Hr
9.60 / 1.60	-	1,814.00	1,449.00	898.00	565.00	339.00	240.00	169.00	97.20	51.30
9.90 / 1.65	-	1,760.00	1,415.00	880.00	557.00	337.00	238.00	168.00	97.00	51.20
10.2 / 1.70	-	1,687.00	1,362.00	853.00	543.00	334.00	237.00	167.00	96.80	51.10
10.5 / 1.75	-	1,615.00	1,316.00	832.00	532.00	329.00	235.00	165.00	96.20	50.80
10.8 / 1.80	-	1,524.00	1,246.00	802.00	516.00	320.00	228.00	161.00	95.50	50.40



GRAND ENERGY MANUFACTURING CO LIMITED
 ISO9001 / ISO14001 / ISO45001 / UL / CE / RoHS
www.gembattery.com

- Subject to revisions, the above data might be changed without prior notice, GEM BATTERY reserves the right to explain and update related information.
- The trade mark GEM BATTERY is registering in China, if any trade mark infringement, please contact us.
- To follow the latest information, please contact our sales representative.