



KT-13

CONDANSATE CONNECTION MANIFOLDS

GENERAL FEATURES

KT-13 is used for both steam distribution and condensate generation. Piston valves must be completely open or closed during the operation. These valves are not designed for flow control. Because of the wide sealing area of the piston valves, usage of an additional valve for sealing is not necessary.

Installation

KT-13 condensate manifolds are designed for vertical installation. It is suggested to insulate the condensate manifolds in order to prevent heat losses and to protect the users.

Steam Distribution

Suggested installation is to connect the steam entry to the top of the condensate manifold. A steam trap unit should be placed at the bottom. The discharge from this steam trap unit should return to the condensate line properly. If dis-charging will be done to the atmosphere, a diffuser must be used.

Condensate Generating

It is suggested to install the KT-13 as the condensate exit to come up to the top side. A stop valve for blowing off should be place underneath the condensate generator. Usage of diffuser is suggested as well.

Max. Working Pressure: 26 bar

Max. Working Temperature: 250°C

KV Value: 1.8 m³/h

Pressure And Temperature Limitations

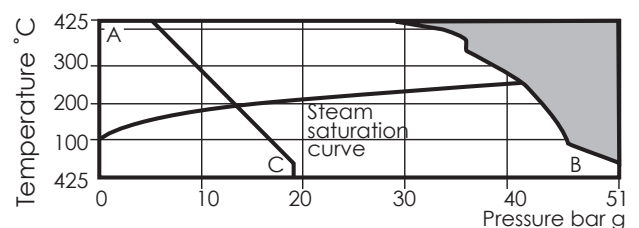

 Product should not be used in this area

*PMO: Max. suggested operating pressure for saturated steam

KT-13 CONDANSATE CONNECTION MANIFOLDS

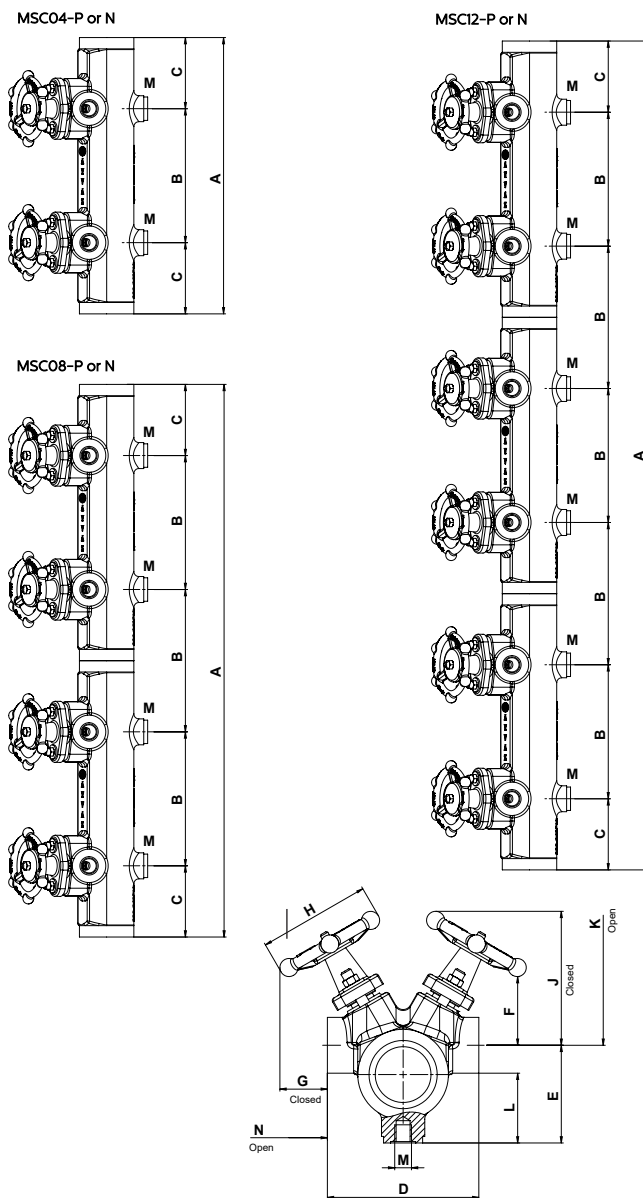
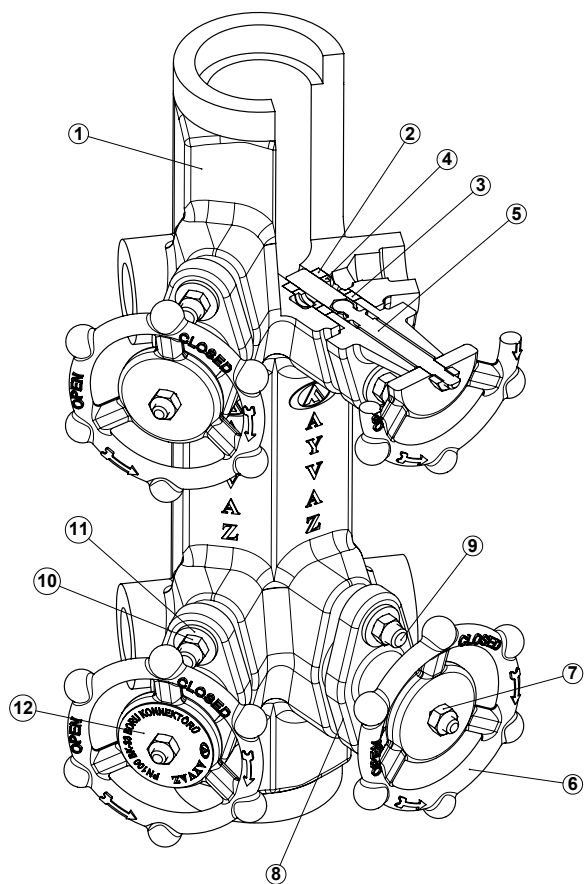

Part list		
No	Part Name	Material
1	Body	Carbon Steel
2	Lower Gasket	Graphite and stainless steel
3	Upper Gasket	Graphite and stainless steel
4	Bush	Stainless Steel
5	Piston	Stainless Steel
6	Hand Wheel	Carbon Steel
7	Nut	Stainless Steel
8	Cover	Carbon Steel
9	Pin	Stainless Steel
10	Nut	Stainless Steel
11	Gasket	Stainless Steel
12	Label	Stainless Steel

Dimensions / Weight (approx.) mm and kg

Type	A	B	C	D	E	F	G	H	J	K	L	M	N	Weight
TK-13 04	330	160	85	110	71	60	45	96	110	130	51	M12	55	10
TK-13 08	650	160	85	110	71	60	45	96	110	130	51	M12	55	20
TK-13 12	970	160	85	110	71	60	45	96	110	130	51	M12	55	30



HEAD OFFICE - FACTORY

Atatürk Sanayi Bölgesi Hadımköy Mahallesi Mustafa İnan Caddesi No: 44 Arnavutköy - İSTANBUL
 Tel: +90 212 771 01 45 (pbx) | Fax: +90 212 771 47 27
 info@ayvaz.com | www.ayvaz.com

Caserta/Italy

Tel: +39 0823 187 3988
 rmolaro@ayvaz.com

Moscow/Russia

Tel: +74959951728
 ayvazrus@ayvaz.com

Viernheim/Germany

Tel: +49 62046014399
 germany@ayvaz.com

Kiev/Ukraine

Tel: +380 44 390 57 57
 info@ayvaz.com.ua

Warsaw/Poland

Tel: +48-32-783-295-1
 tricorr@tricorr.eu

Dubai/U.A.E

Tel: +971 563550822
 +971 501306871
 mideast@ayvaz.com

Cixi City/China

Tel: +86 0574 5897 3851
 info@ayvazchina.com

Kazakhstan

Tel: +7 (701) 066 066 1
 +90 (533) 760 34 66
 celyas@ayvaz.com

Ispereh/Bulgaria

Tel: +359 8431 27 32
 office@ayvaz-n.eu

Belgrad/Serbia

Tel: +381 61 658 70 52
 yakbiyik@ayvaz.com