

DITREEX

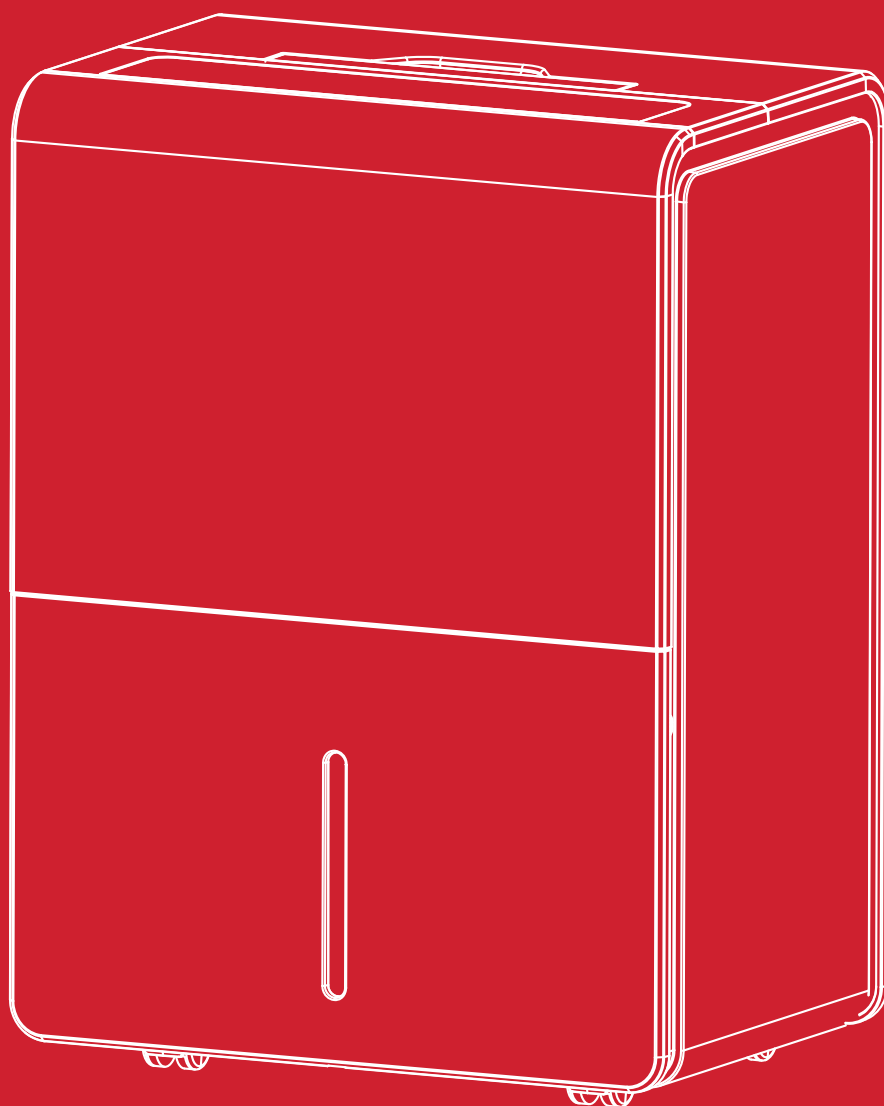

Dehumidifier
Ditreex DEM 35EB

Table of Contents

Important Safety Instructions.....

What's in the Box.....

Let's Get Started!.....

How to Control Your Dehumidifier.....

Troubleshooting

IMPORTANT SAFETY INSTRUCTIONS

Before installing and using your dehumidifier, please read this owner's manual carefully.

Store this manual in a safe place for future reference. Your safety and the safety of others is very important to us.

Please pay attention to all safety messages outlined in this owner's manual.

WARNING: To reduce the risk of fire, electrical shock or injury when using your dehumidifier, follow the following basic precautions:

ELECTRICAL REQUIREMENTS

The electrical ratings for your dehumidifier are listed on the model and serial number label located on the on the back side (when facing the front).

REGISTER YOUR APPLIANCE

You can register your appliance online by going to register.tcl.com

Be sure to retain your original sales receipt. A valid proof of purchase is required for all warranty claims.

Document your model and serial numbers here:

Model # _____ Serial # _____

You can locate your 20 digit serial number underneath the bar code (on the back side)

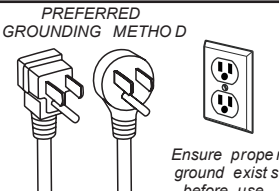
WARNING			Specific electrical requirements are shown in the diagram below. Follow the requirements below for the type of plug on the power supply cord.	
Electrical Shock Hazard	Wiring Requirements		Power Supply Cord	
	<p>Plug into a grounded 3 prong outlet. Do not remove the ground prong. Do not use an adapter. Do not use an extension cord. Failure to follow these instructions can result in death, fire, or electrical shock.</p>		<p style="text-align: center;">60Hz, 115V AC outlet protected by a 15 amp time delay fuse or circuit breaker.</p> <div style="text-align: center;"> <p><i>PREFERRED GROUNDING METHOD</i></p>  <p style="text-align: right;"><i>Ensure proper ground exists before use</i></p> </div>	

RECOMMENDED GROUND METHOD

For your personal safety, this air conditioner must be grounded. This dehumidifier is equipped with a 3 prong power supply cord with a grounded plug. To minimize the possibility of electrical shock, the cord must be plugged into a 3 prong outlet and grounded in accordance with all local codes and ordinances. If a 3 prong outlet is not available, it is the customer's responsibility to have a properly grounded 3 prong outlet installed by a qualified electrician.

FCC CAUTION

This device complies with part 15 of the FCC Rules. Operation is subject to the following two conditions: (1) This device may not cause harmful interference, and (2) this device must accept any interference received, including interference that may cause undesired operation. Any Changes or modifications not expressly approved by the party responsible for compliance could void the user's authority to operate the equipment.

Note: This equipment has been tested and found to comply with the limits for a Class B digital device, pursuant to part 15 of the FCC Rules. These limits are designed to provide reasonable protection against harmful interference in a residential installation. This equipment generates uses and can radiate radio frequency energy and, if not installed and used in accordance with the instructions, may cause harmful interference to radio communications. However, there is no guarantee that interference will not occur in a particular installation. If this equipment does cause harmful interference to radio or television reception, which can be determined by turning the equipment off and on, the user is encouraged to try to correct the interference by one or more of the following measures:

- Reorient or relocate the receiving antenna.
- Increase the separation between the equipment and receiver.
- Connect the equipment into an outlet on a circuit different from that to which the receiver is connected.
- Consult the dealer or an experienced radio/TV technician for help. The distance between user and device should be no less than 20cm.



What's in the Box

Note: Some accessories are not in bucket, please find it in packaging.

NO.	APPEARANCE	PART NAME	QUANTITY
1		Pump Drain Hose (about 5m, 16.4ft) (PUMP MODEL ONLY)	1 set

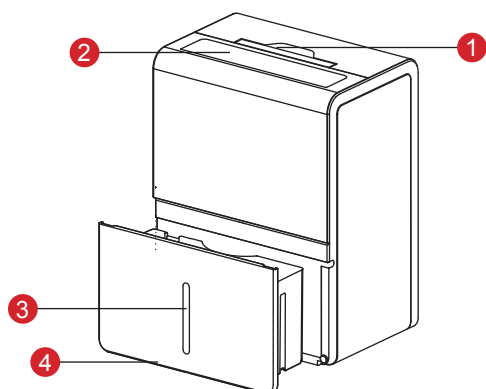

SMALLER CABINET

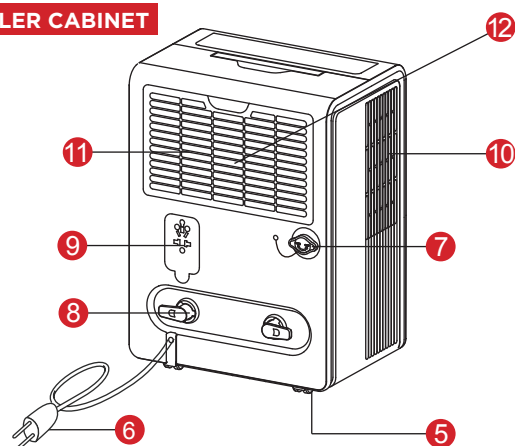

BIGGER CABINET

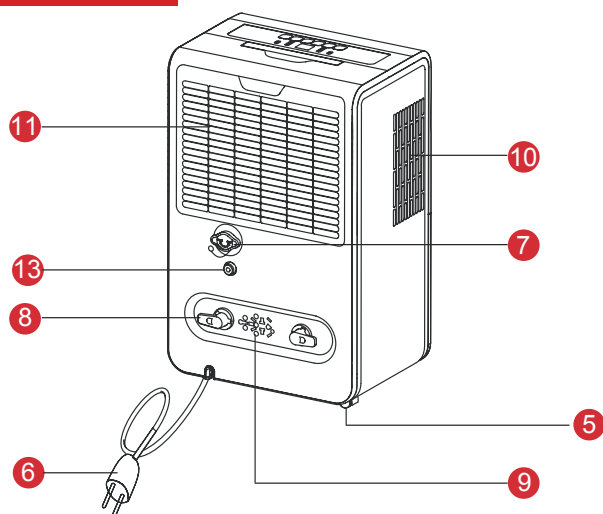

NO.	COMPONENT DESCRIPTION
1	Handle
2	Control Panel
3	Water Level View Window
4	Bucket
5	Wheels
6	Power Cord
7	Drainage Holes
8	Power Cord Storage
9	Plug Fixer
10	Air Outlet Grille
11	Air Inlet Grille & Filter
12	UVC LED (Select Models Only)
13	Pump Connector (Only on models with a pump)

Note: Illustrations in this manual are for explanatory purposes only. Product design and aesthetics may vary.

Let's Get Started!

Installation & Assembly Instructions:

Step 1: Testing

- Do not use outdoors.
- Place the unit on a smooth level surface.
- Allow at least 12 -18 inches of clearance on all sides of the unit.
- Place the unit in a space where the temperature will not fall below 41 degrees Fahrenheit.
- The dehumidifier must be operated in an enclosed area to be most effective, such as a basement.
- Close all doors, windows, and other outside openings to the room.

Step 2: Installation

There are two sizes of cabinet

Smaller cabinet size (WxHxD)	Bigger cabinet size (WxHxD)
365mm x 500mm x 250mm 14.37in x 19.69in x 9.84in	383mm x 610mm x 280mm 15.08in x 24.02in x 11.02in

For the smaller cabinet:

Before use, please remove the accessories from the bucket

- 1a.** Remove the bucket from appliance.
- 1b.** Open the cover, take out the accessories. (Fig 1a).
- 1c.** Reinstall the cover, correctly put the bucket back into the appliance (Fig 1b).

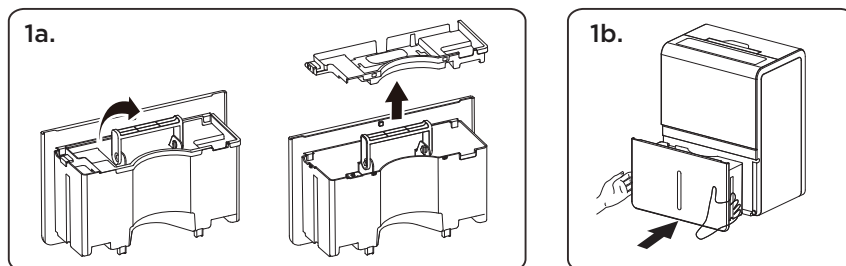

For the bigger cabinet:

Before use, please remove the accessories from the bucket

- 1a.** Remove the bucket from appliance. **Note:** Not all models have handles.
- 1b.** Make sure to release the cover by pushing in the two latches at the top of the bucket.
- 1c.** Open the cover, take out the accessories. (Fig 1a).
- 1d.** Reinstall the cover, correctly put the bucket back into the appliance (Fig 1b).

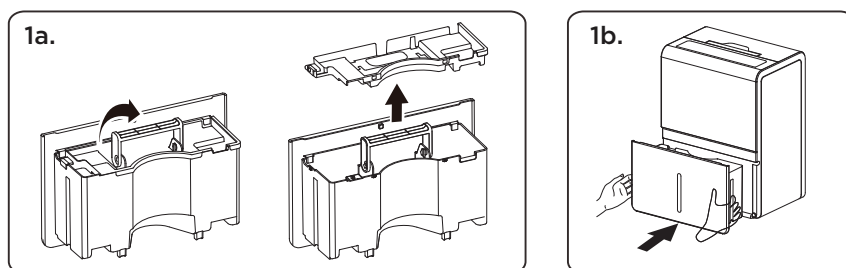





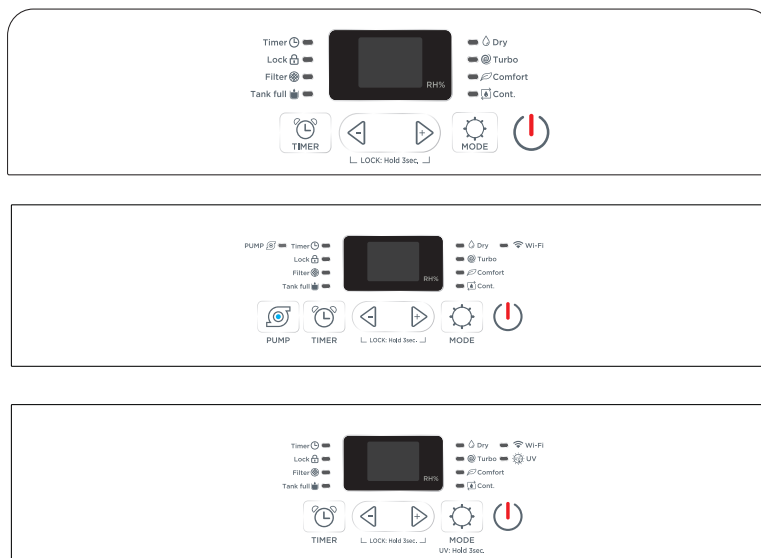





How to Control Your Dehumidifier









All the basics you need to know!



Disclaimer: Pump, UV, and Wi-Fi features are only available on select models. It is normal for the letters “CF” to be displayed for several seconds on Wi-Fi models as the dehumidifier powers on.

It is recommended to run the dehumidifier in Contentious mode for 24 hours for the first time. This will stabilize the humidity and ensure that the compressor will function properly.

1. **Power On and Off** - Press the  once to turn on the appliance, push again to power off.
2. **MODE** - Press the  to toggle through the different modes: Dry, Turbo, Comfort or Continuous.
3. **Dry** - Press the  until the Dry symbol is selected. Press the left and right buttons to set the desired relative humidity (RH) level between 35% - 80% RH. After a few seconds, the RH of the room will be displayed. The fan speed will be set on low and cannot be adjusted.
4. **Turbo** - Press the  until the Turbo symbol is selected. This will set the dehumidifier to target 35% RH. After a few seconds, the RH% of the room will be displayed. The fan speed will be set on high and can not be adjusted.
5. **Comfort** - Press the  until the Comfort symbol is selected. This will automatically set the target RH according to the ambient temperature. While in this mode, the RH mode can not be manually set. After a few seconds, the RH of the room will be displayed. The fan speed will be set on low and cannot be adjusted. In this mode, the screen will dim and eventually turn off completely. To check the status, press the  to temporarily wake up the display.
6. **Continuous** - Press the  until the Cont. symbol is selected. This will set the dehumidifier to target 15% RH. The fan speed will be set on low and cannot be adjusted.
7. **Timer** - The timer can be used to delay the appliance start-up or shutdown.
8. **Start-up** - With the appliance off, press the  to enable this feature. Then press the  or  buttons to increase or decrease the timer in 30 minute increments. After 5 seconds of inactivity, the Timer symbol will light up and this feature will be active.

- 9. Shutdown** - With the appliance on, press the  to enable this feature. Then press the  or  buttons to increase or decrease the timer in 30 minute increments. After 5 seconds of inactivity, the Timer symbol will light up and this feature will be active.
- 10. Lock** - The lock function prevents from someone accidentally changing the settings. To lock the panel, simultaneously press and hold down the  and  buttons for 3 seconds. The Lock symbol will light up when this feature is enabled. To unlock the control panel, press and hold the  and  buttons for 3 seconds. The Lock symbol light will turn off.
- 11. Filter** - When the filter needs to be cleaned, the Filter symbol will light up. This will light up after every 250 hours of use and is used as a reminder (not an actual indicator that the filter is dirty). Remove the filter from the back of the unit by using your thumbs to press down on the filter tabs directly above the filter. Clean the filter with warm, soapy water. Dry thoroughly before replacing the filter. Once the filter is completely dry, place the filter back in the unit and hold the  for a few seconds to reset the filter indicator.

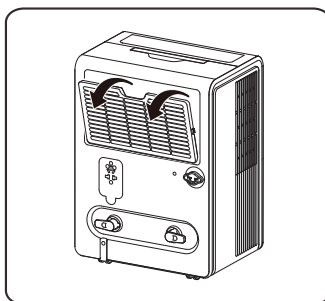

- 12. Tank Full** - When the water bucket is full, the Tank Full symbol will light up and the compressor will turn off. The fan may continue to run for a few more minutes. Remove the bucket with both hands and empty. Do not place the bucket on the floor when it is full because the bottom is not flat.

Cleaning the water tank - It is recommended to clean the bucket with a mild detergent every week to prevent the growth of mold, mildew, and bacteria. Once clean, completely dry the bucket and, using two hands, place it back inside the appliance.

For Model(s) with PUMP

- 1. PUMP** - Enable this function for use with a drain hose. Connect the pump drain tube and adapter to the back of the unit. Press the PUMP button and verify the light next to the Pump symbol turns on.

Note: Water will still drain into the bucket but the pump will engage when the bucket is almost full.

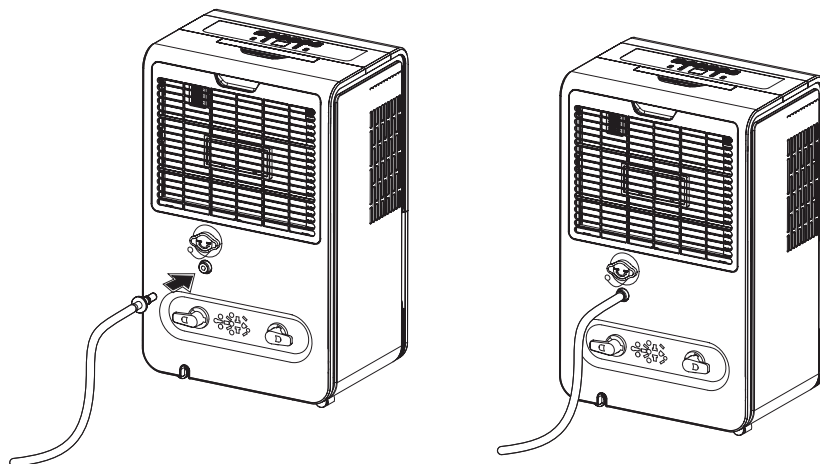

Note: You **must** place the end of the drain hose down a drain or someplace where it can freely drain (bowls, buckets, etc. are not recommended as they can overflow).

Continuous Drain -

A standard garden hose can be used for continuous gravity flow into a floor drain.

1. Unscrew the cap on the back of the unit.
2. Install a standard garden hose to the back of the unit, ensuring there are no kinks in the hose.
3. Ensure that the dehumidifier is level, even a slight tilt can cause the water to drip down into the drain bucket and not through the garden hose.

Attaching Pump Drain Tube -

1. Push in on the outer ring of the pump connector on the back of the dehumidifier (See photo).
2. Slide the drain adapter into the opening and then release the outer ring of the pump connect.
3. Gently pull the drain adapter to ensure it is locked into place.
4. To remove the drain hose push in on the outer ring of the pump connector and pull on the drain tube connector.

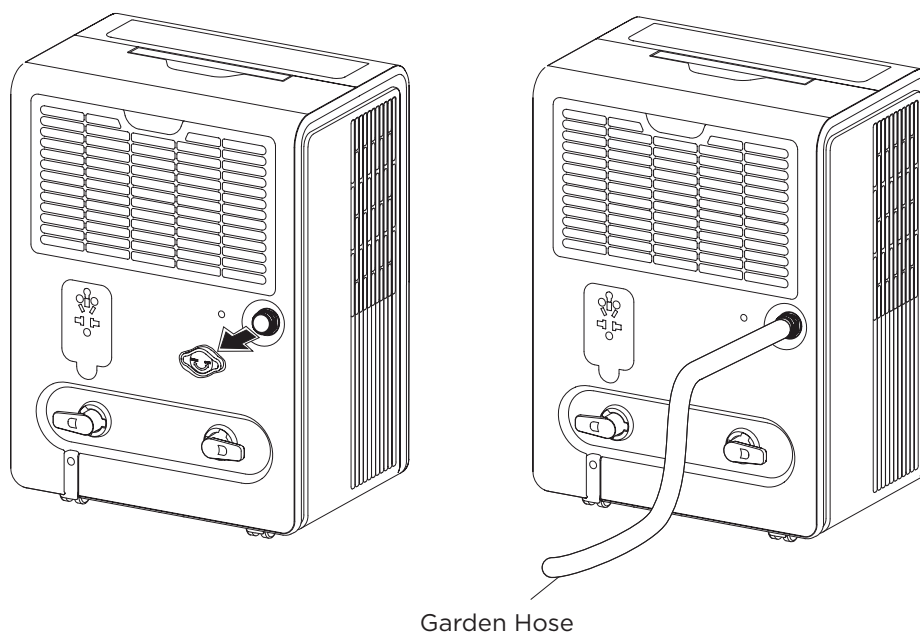

For Model(s) with UVC

Press and hold  for 3 second until the UV indicator turns on. To turn the UV function off, press and hold the mode button for another 3 seconds until the indicator turns off.

Should any UV light be exposed, stop use immediately and contact customer service.

Automatic Defrost - When frost builds up on the evaporator coils, the compressor will stop and the fan will continue to run until the frost disappears. When the coils are completely defrosted, the compressor will automatically restart and dehumidify will resume. If the frost does not completely melt on its own, unplug the appliance overnight. Be sure to confirm the filter is clean before running again.

Troubleshooting

Having trouble completing installation? Don't worry, it's usually an easy fix.

PROBLEM	POSSIBLE CAUSES	SOLUTIONS
Dehumidifier does not start	The dehumidifier is unplugged.	<ul style="list-style-type: none"> • Make sure the dehumidifier plug is pushed completely into the outlet.
	The fuse is blown/circuit breaker is tripped	<ul style="list-style-type: none"> • Check the house fuse/circuit breaker box and replace the fuse or reset the breaker.
	Dehumidifier has reached its pre-set level or the bucket is full	<ul style="list-style-type: none"> • The dehumidifier automatically turns off when either condition occurs. Change to a lower setting or empty the water bucket. The bucket must be replaced properly for the dehumidifier to operate.
	Bucket is not in the proper position	<ul style="list-style-type: none"> • The bucket must be in place and securely inserted for the dehumidifier to operate.
	Power failure	<ul style="list-style-type: none"> • There is a protective time delay (up to 3 min.) to prevent tripping of the compressor overload. For this reason, the unit may not start normal dehumidification for 3 min. after it is powered back on.
Dehumidifier does not dry the air as it should	Not enough time allowed for unit to remove moisture	<ul style="list-style-type: none"> • When first installed, allow at least 24 hours to reach the desired dryness/humidity level.
	Airflow is restricted	<ul style="list-style-type: none"> • Make sure there are no curtains, blinds, or furniture blocking the front or back of the dehumidifier.
	Dirty filter	<ul style="list-style-type: none"> • Clean the filter. See the Cleaning and Care Section of the manual.
	The Humidity Control may not be set low enough	<ul style="list-style-type: none"> • For drier air, press the v button to lower the humidity setting percentage in the room set the dehumidifier to CO for maximum dehumidification.
	Doors and windows may not be closed tightly	<ul style="list-style-type: none"> • Check that all doors, windows, and other openings are securely closed.
	Clothes dryer may be blowing moist air into the room	<ul style="list-style-type: none"> • Install the dehumidifier away from the dryer. The dryer should be vented outside.
	Room temperature is too low	<ul style="list-style-type: none"> • Moisture removal is best at higher room temperatures. Lower room temperatures will reduce the moisture removal rate. This model is designed to operate at temperatures above 41° F (5°C).

Troubleshooting

Having trouble completing installation? Don't worry, it's usually an easy fix.

PROBLEM	POSSIBLE CAUSES	SOLUTIONS
Home App loses connectivity to AC during setup	Wireless router may be too far from AC	<ul style="list-style-type: none"> Relocate wireless router closer to AC.
	Network error	<ul style="list-style-type: none"> Restart wireless router, AC, and mobile device
Home App cannot find AC	Network error	<ul style="list-style-type: none"> Restart wireless router, AC, and mobile device
	App & AC are not on the same 2.4GHz channel	<ul style="list-style-type: none"> Confirm your device is connected to the 2.4GHz channel.
	Router blocking TCL Home App	<ul style="list-style-type: none"> Verify App is not being blocked by the router's firewall.
	Incorrect WiFi Password	<ul style="list-style-type: none"> Reinput and verify WiFi password.
Unable to find or connect to Wireless Network	App may need permission to location	<ul style="list-style-type: none"> Give TCL Home App permission to Location in phone settings.