

# SMART TRASH BARREL

## 智能垃圾桶



A款

A Style

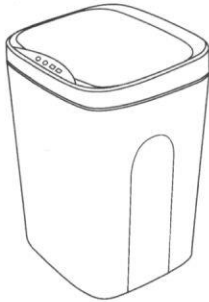

B款

B Style



C款

C Style

使用产品前请仔细阅读本说明书

Please Read This Manual Carefully Before Using The Product

### ① 产品简介 PRODUCT INTRODUCTION

#### A款

A Style

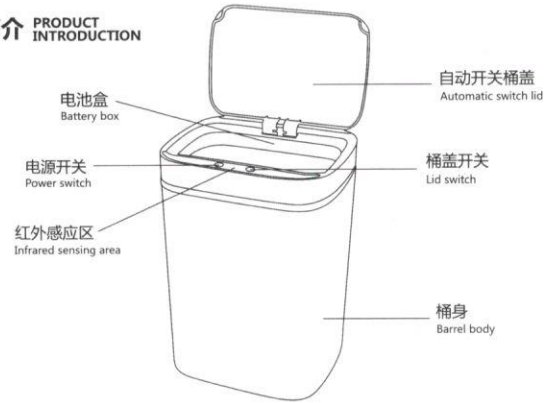

注：红色标识为电源开关，绿色标识为桶盖开关

Note: The red mark is the power switch, the green mark is the lid switch

### ② 操作指南 OPERATION GUIDE

从包装箱内取出所有部件，包括：  
Take out all parts from the box, including:

- 1.桶头  
1.Lid
- 2.桶身  
2.Barrel body
- 4.使用说明书  
4.Instruction manual



### ③ 安装说明 INSTALLATION INSTRUCTIONS

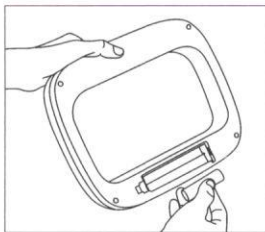

#### 装电池

拿下桶头，翻转到背面，打开电池盖，按电池盖里的图示电池正负极指示方向装入4节5号电池，最后把桶头装上桶身

#### INSTALL THE BATTERY

First take off the lid, turn it over to the back, then open the battery lid, insert four 5AA batteries in the direction indicated by the battery positive and negative poles in the battery lid, and finally install the lid on the barrel.

### ④ 感应功能说明 INDUCTION FUNCTION DESCRIPTION

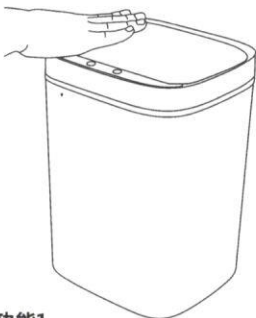

#### 功能1

首先按红色标识按键，开启电源，当手或垃圾置于感应区域时，桶盖会自动开启；当丢弃垃圾完毕离开后，桶盖会自动关闭。（如果手和垃圾没有离开感应区域，桶盖将不会关闭，防止夹手）

#### FUNCTION 1

First press the red button to turn on the power. When the hand or garbage is placed in the sensing area, the lid will automatically open; when the garbage is discarded and left, the lid will automatically close. (If hands and garbage do not leave the sensing area, the lid will not be closed to prevent hands from being caught)



#### 功能2

首先按红色标识按键，手按感应面板上绿色标识按键，桶盖打开；手再按一次绿色标识按键，桶盖关闭；（如果是感应开启盖子的情况下，按键是要按两次才是关闭）按键开启桶盖将不会自动关闭桶盖

#### FUNCTION 2

First press the red button, and press the green button on the sensor panel to open the lid; press the green button again to close the lid; (if the lid is opened by induction, the button must be pressed twice to close) Pressing the button to open the lid will not automatically close the lid.

### ① 产品简介 PRODUCT INTRODUCTION

#### B款

B Style

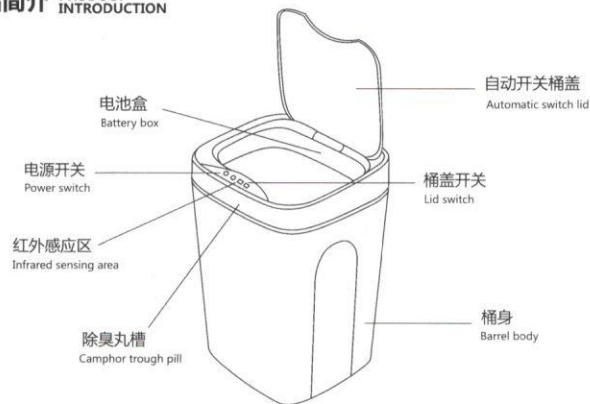

#### C款

C Style

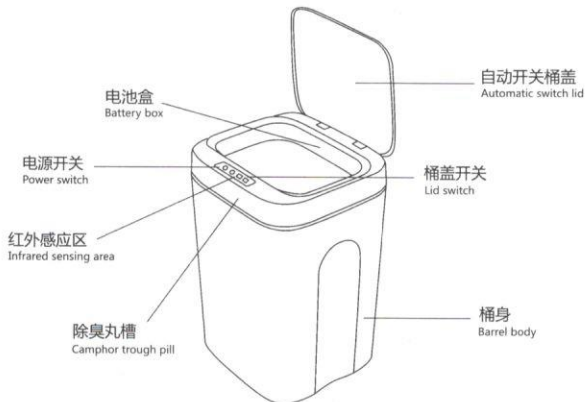

注：红色标识为电源开关，绿色标识为桶盖开关

Note: The red mark is the power switch, the green mark is the lid switch