

# EA900 G4 Li

6 kVA ~ 10 kVA  
PF 1.0



## Features

- High frequency on-line double conversion technology
- Advanced DSP and 3-level technology
- Output power factor 1.0
- Active power factor correction (APFC), input power factor up to 0.99
- High efficiency 95% (up to 98% in ECO mode)
- Advanced digital parallel technology
- Wide input voltage range (110 ~ 288 Vac) and frequency range (40 ~ 70 Hz)
- 50 / 60 Hz frequency auto sensing
- Two modes of frequency conversion: 50 Hz input / 60 Hz output or 60 Hz input / 50 Hz output
- Dual-input design, supporting independent bypass
- Flexible battery configuration (settable 60 - 80 pcs batteries)
- Digitally controlled charger
- High charging current available (Max. 12 A)
- Charging voltage and current configured by demands
- Linear derating in low voltage input reducing battery discharging times, extending the service life of battery
- Intelligent battery management, automatic floating / equalizing charge control, charger dormancy control, increasing battery life by 50%

- Ability to switch on the UPS with batteries
- Settable delayed start time when mains power is restored, reducing the impact on power grid or generator
- Fan speed varies intelligently with temperature, reducing noise and extending its service life
- Equipped with self-aging function
- Compact internal layout, miniaturized the complete unit for small footprint
- LCD+LED display, multi-functional keys operation, friendly human-machine interface
- Powerful background software for parameters configuration
- Advanced multi-platform communications: RS232, USB, RS485, SNMP and dry contacts communication interfaces
- Effective software and hardware protection function, robust self-diagnostic function, and abundant event log for check

### Available Options

- RS232 and smart card slot included
- Optional parallel function, battery temperature compensation, SNMP card, USB, RS485 card, dry contacts, EMD, and SMS alarms

## Rear Panel

1. SNMP (optional)
2. Fans
3. Parallel (optional)
4. RS232
5. EPO
6. USB (optional)
7. Temperature compensation (optional)
8. PE
9. Bypass breaker
10. Terminal and cover
11. Input breaker
12. Maintain bypass breaker (optional)

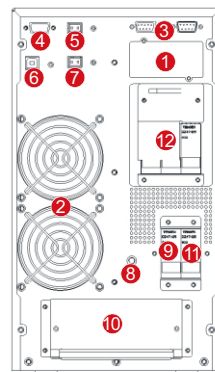

6 kVA / 10 kVA (Tower)



6kVA / 10 kVA (RT)

## Specifications

| MODEL                                | EA906 Li   | EA9010 Li                                       |
|--------------------------------------|--|---|
| Capacity                             | 6kVA / 6kW   | 10kVA / 10kW                                    |
| <b>INPUT</b>                         |  |   |
| Input wiring                         | Single-phase three-wire (1Φ + N + PE)  |   |
| Rated voltage                        | 208 / 220 / 230 / 240 Vac  |   |
| Voltage range                        | 110 ~ 176 Vac (linear derating between 50% and 100% load);<br>176 ~ 288 Vac (no derating)                |   |
| Rated frequency                      | 50 / 60 Hz (auto-sensing)  |   |
| Frequency range                      | 40 ~ 70 Hz   |   |
| Power factor                         | ≥ 0.99   |   |
| Bypass voltage range                 | - 40% ~ +15% (settable)  |   |
| Total harmonic distortion (THDi)     | ≤ 5%   |   |
| <b>OUTPUT</b>                        |  |   |
| Output wiring                        | Single-phase (L-N)   |   |
| Rated voltage                        | 208 (PF=0.9) / 220 / 230 / 240 Vac   |   |
| Voltage regulation                   | ± 1%   |   |
| Frequency                            | Synchronized to bypass in mains mode; 50 / 60 Hz ±0.1% Hz in battery mode                                |   |
| Waveform                             | Sinusoidal   |   |
| Power factor                         | 1  |   |
| Total harmonic distortion (THDv)     | ≤ 1% (linear load); ≤ 4% (non-linear load)   |   |
| Crest factor                         | 3:1  |   |
| Overload                             | 105% ~ 110% for 10 min, 110% ~ 125% for 1 min, 126% ~ 150% for 30 s                                      |   |
| <b>BATTERIES</b>                     |  |   |
| DC voltage                           | 192 Vdc (192 ~ 256 Vdc settable)   |   |
| Number of battery                    | 60 pcs (60 ~ 80 settable)  |   |
| Charging current                     | 5 A (default), 1 ~ 5 A settable; 12 A (optional)   |   |
| Recharge time                        | depend on the capacity of battery  |   |
| <b>SYSTEM</b>                        |  |   |
| Efficiency                           | ≥ 94% at 100% load, max. 95% at 60% load, ≥ 98% in ECO mode  |   |
| Transfer time                        | 0 ms   |   |
| Protections                          | Short-circuit, overload, overtemperature, battery low voltage, overvoltage, undervoltage and fan failure |   |
| Max. number of parallel connections  | 4  |   |
| Communications                       | RS232 (standard), USB / RS485 / dry contacts / SNMP / battery temperature compensation (optional)        |   |
| Display                              | LCD + LED  |   |
| <b>OTHERS</b>                        |  |   |
| Operating temperature                | 0°C ~ 40°C   |   |
| Storage temperature                  | -25°C ~ 55°C (without battery)   |   |
| Relative humidity                    | 0 ~ 95% (non-condensing)   |   |
| Altitude                             | ≤ 1000 m, derating 1% for each additional 100 m  |   |
| IP rating                            | IP 20  |   |
| Noise level at 1 m                   | ≤ 55 dB  | ≤ 58 dB   |
| Dimensions (W × D × H) (mm)          | 191 × 465 × 350 (Tower)<br>440 × 580 × 88 (RT)   | 191 × 495 × 350 (Tower)<br>440 × 580 × 88 (RT)  |
| Packaged dimensions (W × D × H) (mm) | 318 × 595 × 475 (Tower)<br>514 × 696 × 168 (RT)  | 318 × 617 × 475 (Tower)<br>514 × 696 × 168 (RT) |
| Net weight (kg)                      | 14.5 (Tower), 12 (RT)  | 16.5 (Tower), 14 (RT)                           |
| Gross weight (kg)                    | 16 (Tower), 14 (RT)  | 18 (Tower), 16 (RT)                             |

• All specifications are subject to change without notice.