

Filters

Filtros - Filtres

TOP MOUNT SAND FILTERS / FILTROS TOP S2 / FILTRES À SABLE TOP S2

S2-350TOP
S2-400TOP
S2-500TOP
S2-600TOP

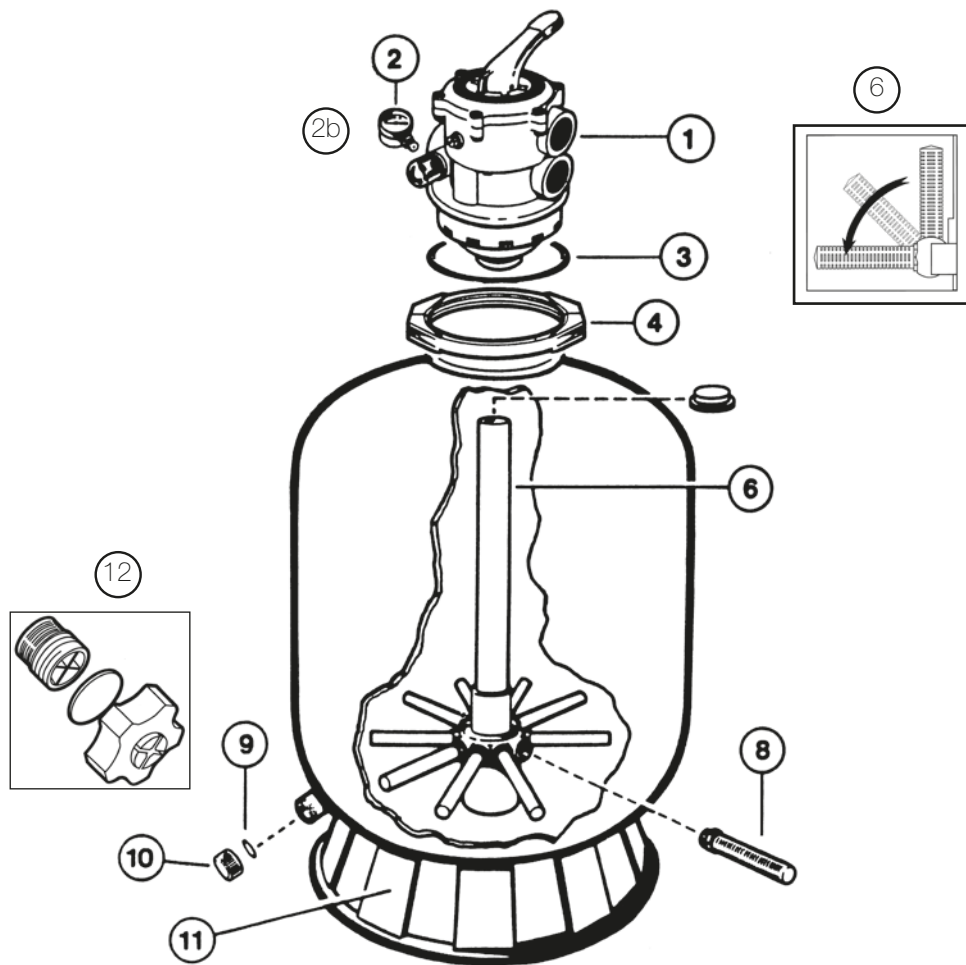

S2-350TOP - S2-400TOP - S2-500TOP - S2-600TOP

| N° | Item nr. Código Code | Description / Descripción / Description | Uds. embalaje Packaging qty. Qté. Emballage |
|----|----------------------------|--|---|
| 1 | SP0714TE | Valve • Válvula • Vanne | 1 |
| 2 | ECX271261 | Pressure Gauge • Manómetro • Manomètre | 1 |
| 3 | GMX0600F | Valve O'Ring • O'Ring del válvula • Joint torique | 1 |
| 4 | GMX0600NM | Flange Clamps • Abrazadera • Collier de serrage | 1 |
| 6 | SX164DA | Folding umbrella lateral assembly • Difusor inferior con tamices y tubo central • Diffuseur inférieur avec crépines et tube central S2-400TOP | 1 |
| | SX210DA | S2-500TOP | 1 |
| | SX244DA | S2-600TOP | 1 |
| 8 | SX200QNPAAK10 | Lateral (x10) • Crepina (x10) • Crépine (x10) S2-400TOP / S2-500TOP | 10 |
| | SX240DNPAK10 | S2-600TOP | 10 |
| 9 | SX0180G | Drain gasket • Junta del tapón de vaciado • Joint de bouchon de vidange | 1 |
| 10 | SX0180H | Drain clamp • Tapón de vaciado • Bouchon de vidange | 1 |
| 11 | SX0164B | Support stand • Base de soporte • Socle S2-350TOP / S2-400TOP | 1 |
| | SX0200J | S2-500TOP / S2-600TOP | 1 |
| - | SX0200H | Strainer of draining • Tamiz de drenaje • Crépines de vidange | 1 |
| 12 | SX180LA | Drain clamp • Tapón de vaciad • Bouchon de vidange | 1 |