



# EPT20-15ET2

## ELECTRIC PALLET TRUCK 1.5T

 1500 kg
  115 mm
  24 V Li-Ion



The EPT20-15ET2 is ideal for indoor environments such as retail stores, small warehouses, and light logistics applications. Its compact design and low service weight (180 kg) enable easy maneuvering in tight spaces. The truck also offers optional attachments including a cargo backrest, storage box, or built-in electric scale, adapting to various operational needs.

SPECIFICATION	REF	UNIT	VALUE
Battery type			Li-Ion
Battery nominal capacity		Ah	65
Battery voltage		V	24
Load capacity	Q	kg	1500
Load centre distance	c	mm	600
Service weight		kg	180
Lift height	$h_3$	mm	115
Overall length		mm	1638
Overall width	$b_1/b_2$	mm	560 (685)
Length to face of forks	$I_2$	mm	488
Fork dimensions	s/e/l	mm	50/150/1150
Turning radius		Wa	1475
Operator type			Pedestrian
Load distance, centre of drive axle to fork		mm	883/946
Wheelbase		mm	1202/1261
Axle loading, laden front/rear		kg	567/1128

# Features

---

## Compact & lightweight

With a 1.5-ton capacity and a compact frame, the EPT20-15ET2 offers excellent maneuverability. Its 180 kg service weight makes it easy to operate in tight aisles and small warehouses.

## Easy maintenance

A front detachable battery cover and optimized harness layout allow quick access for battery replacement and servicing. This design reduces downtime and ensures reliable long-term performance.

## Enhanced safety

Equipped with an upgraded emergency switch and a strong driving wheel cover, the truck improves operator safety during daily operations.

## Flexible attachments

The EPT20-15ET2 supports optional add-ons such as an electric scale, cargo backrest, or storage box, allowing customization to meet different application needs.

# VDI Chart

---

	SPECIFICATION	REF	UNIT	VALUE
1.4	Operator type			Pedestrian
1.5	Load capacity	Q	kg	1500
1.6	Load centre distance	c	mm	600
1.8	Load distance, centre of drive axle to fork		mm	883/946
1.9	Wheelbase		mm	1202/1261
2.1	Service weight		kg	180
2.2	Axle loading, laden front/rear		kg	567/1128
2.3	Axle loading, unladen front/rear		kg	155/40
3.1	Tyre type			Polyurethane
3.2	Tyre size, front			210x70
3.3	Tyre size, rear			80x60

SPECIFICATION		REF	UNIT	VALUE
3.5	Wheels, number front/rear (x=drive wheels)			1x—/4
3.6	Tread width, front	b <sub>10</sub>	mm	-
3.7	Tread width, rear	b <sub>11</sub>	mm	410 (535)
4.19	Overall length		mm	1638
4.20	Length to face of forks	I <sub>2</sub>	mm	488
4.21	Overall width	b <sub>1</sub> /b <sub>2</sub>	mm	560 (685)
4.22	Fork dimensions	s/e/1	mm	50/150/1150
4.32	Ground clearance, centre of wheelbase		mm	30
4.34.1	Aisle width for pallets 1000×1200 crossways		Ast	2280
4.34.2	Aisle width for pallets 800×1200 lengthways		Ast	2150
4.35	Turning radius		Wa	1475
4.4	Lift height	h <sub>3</sub>	mm	115
5.1	Travel speed, laden/unladen		km/h	4.5/5
5.10	Service brake			Electromagnetic
5.2	Lifting speed, laden/unladen		m/s	0.027/0.038
5.3	Lowering speed, laden/unladen		m/s	0.059/0.039
5.8	Max. gradeability, laden/unladen		%	5 / 16
6.1	Drive motor rating S2 60 min		kW	0.75
6.2	Lift motor rating at S3 15%		kW	0.84
6.4	Battery nominal capacity		Ah	65
6.4	Battery voltage		V	24
6.4.1	Battery type			Li-Ion
6.5	Battery weight		kg	14.15*2
8.1	Type of drive control			DC
10.5	Steering design			Mechanical
10.7	Sound pressure level at the drivers ear		dB(A)	74

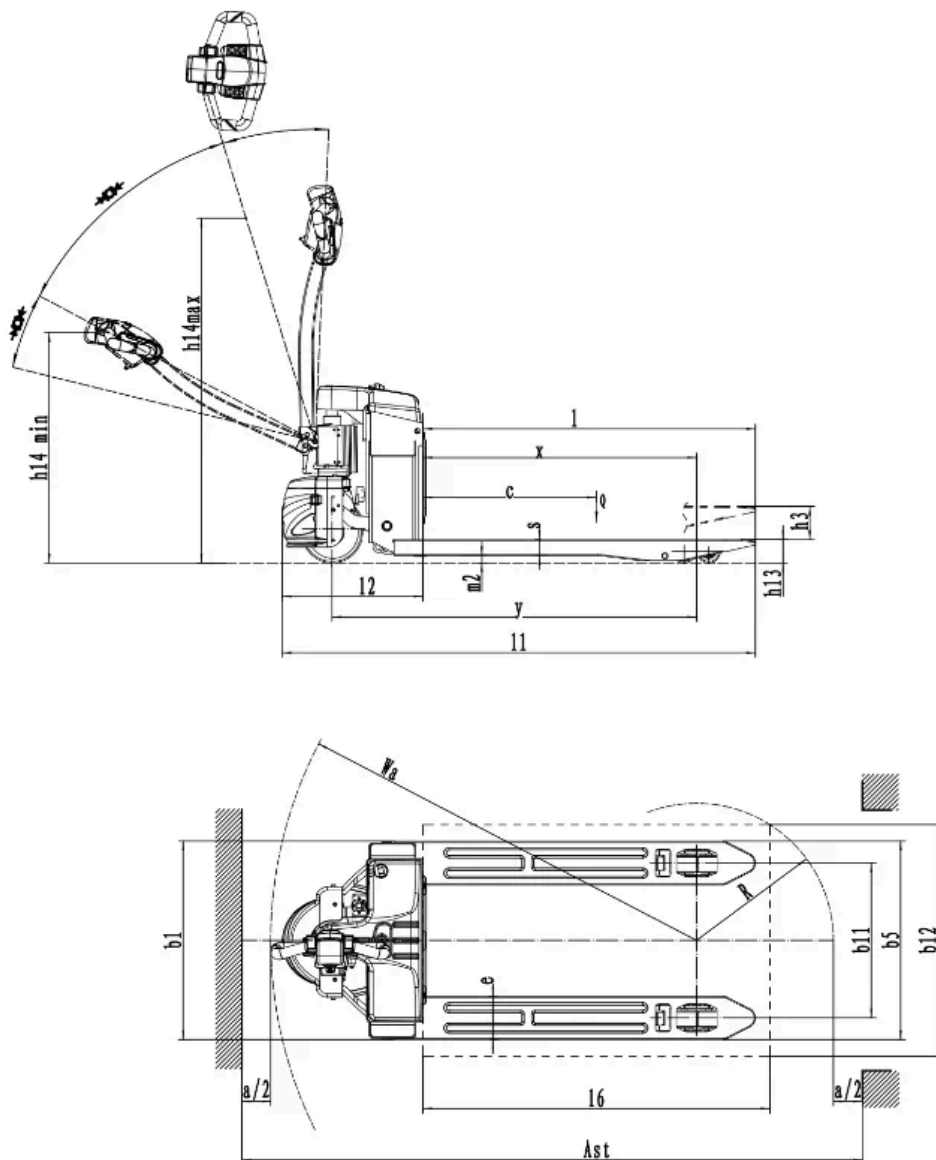

## Options

ITEM	OPTIONS (optional items marked in yellow)
Fork lowered height	80   60
Load wheel type	Double   Single
Load wheel material	PU
Drive wheel material	PU
Battery capacity	65Ah   85Ah
Charger	24V-10A internal
Battery display indicator (BDI)	With time

ITEM	OPTIONS (optional items marked in yellow)
Castor wheels	No   Yes and not customized
Fork length	1150   800-2000
Fork width	560   685   520   460   420   600