

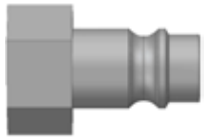

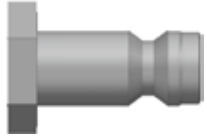

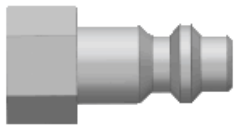



CORRESPONDENCE COUPLER

PROFILE	Series	DN	Standard	interchangeability							
				RECTUS	LEGRIS	CEJN		PREVOST	CAMOZZI		
	EG	7,5	Profile Europe	RECTUS 25-26	LEGRIS 25-26	CEJN 320		PREVOST ERC07	CAMOZZI 5180		
	EC	5	MIGNON	RECTUS 21-90	LEGRIS 21				CAMOZZI 5150		
	UM	5,5	ISO 6150 B-12 / Profile USA Industrial	RECTUS 23-24	LEGRIS 23-24	CEJN 310	PARKER 30-1/4	PREVOST IRM06			
	UA	5,5	Profile ARO	RECTUS 14-22	LEGRIS 14-22	CEJN 300	PARKER 50	PREVOST ARM06			
	JP	7,5	Profile Japan	RECTUS 13	LEGRIS 13	CEJN 315					NITTO KOHKI
	230	9	ISO 6150 B-15	RECTUS 30	LEGRIS 30	CEJN 430	PARKER 30-3/8	PREVOST IRM08			
	FR	5,5	ISO 6150 C-10	RECTUS 18	LEGRIS 18	CEJN 291				STAUBLI RBE6	OETIKER DP6150
	IT	5	Profile Italy								
	UK	5.5	Profile UK	PCL AC21							
	UT	5.5	Profile Truflate	Truflate 12-612	Milton 1808						

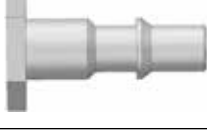
QUICK COUPLING

SAFETY PUSH BUTTON QUICK COUPLING

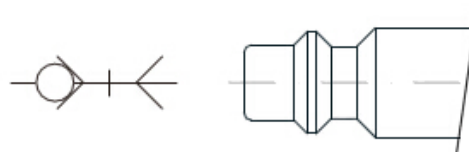

Profile ISO 6150 B12

SAFETY

1

- 1 - Press button once: instantaneous pressure relief
- 2 - Press button twice: instant disconnection

XHnotation S safety coupling incorporate a foolproof mechanical safety mechanism. They comply with standards ISO 4414

NO LEAKAGE

2

The sealing mechanism is used in conjunction with plugs, eliminates all leaks when coupled or uncoupled.

RELIABLE

3

The construction from shock-resistant composite materials, together with the metal insert, ensure long life and dependability.

SPECIFICATIONS

- Maximum Inlet Pressure: 225 Psi.
- Maximum Temperature: - 60° F to 140° F.
- Air Flow: 36 SCFM at 90 Psi.
- Coupler Body Shell Material: Fiberglass Filled Nylon 66.
- Rubber Seal: NBR Seals
- Plug: ISO 6150 B12, 5.5mm

		A	B	C	DESCRIPTION	PART NUMBER
Female threaded coupling						
		73	29	23 mm	Female 1/4" NPT	SPQ-SF 20
		73	29	23 mm	Female 3/8" NPT	SPQ-SF 30
		73	29	23 mm	Female 1/2" NPT	SPQ-SF 40
Male threaded coupling						
		80	29	23 mm	Male 1/4" NPT	SPQ-SM 20
		80	29	23 mm	Male 3/8" NPT	SPQ-SM 30
		80	29	23 mm	Male 1/2" NPT	SPQ-SM 40
Barb plug coupling						
		92	29	23 mm	Barb 6.5mm	SPQ-SH 20
		92	29	23 mm	Barb 8mm	SPQ-SH 30
		92	29	23 mm	Barb 10mm	SPQ-SH 40

UK PCL SPECIALLY

Profile UK
PCL AC21
DN5.5mm



HOW TO WORK

Double click to engage properly.
Firstly click locks couplers and plug.
The second click engages the air pressure.

To disconnect push the button twice.
The first push relieve air pressure,
the second push disconnect coupler and plug.

ADVANTAGE

Safety connection and disconnection.

The coupler automatically vents pressure before release.

The coupler prevents accidental hose whip.
Fit for compact space, good gripping;

SPECIFICATIONS

Maximum Inlet Pressure: 225 Psi.





Maximum Temperature: - 60° F to 140° F.

Air Flow: 36 SCFM at 90 Psi.

Coupler Body Shell Material: Fiberglass Filled Nylon 66.

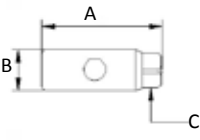
Rubber Seal: NBR Seals

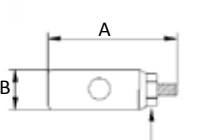
Plug: Profile UK PCL AC21, 5.5mm

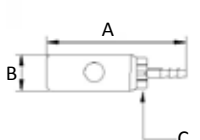
		A	B	C	DESCRIPTION	PART NUMBER
Female threaded coupling						
		78	29	25 mm	Female 1/4" BSP	SUK-SF 20
		78	29	25 mm	Female 3/8" BSP	SUK-SF 30
		78	29	25 mm	Female 1/2" BSP	SUK-SF 40
Male threaded coupling						
		84	29	25 mm	Male 1/4" BSP	SUK-SM 20
		84	29	25 mm	Male 3/8" BSP	SUK-SM 30
		84	29	25 mm	Male 1/2" BSP	SEU-SM 40
Barb plug coupling						
		97	29	25 mm	Barb 6mm	SUK-SH 20
		97	29	25 mm	Barb 8mm	SUK-SH 30
		97	29	25 mm	Barb 10mm	SUK-SH 40

QUICK COUPLING

SAFETY PUSH BUTTON QUICK COUPLING





FEATURES

1. We make Euro Universal coupler, Germany coupler, Italy coupler, UK coupler, Israel coupler etc.
2. Target market: Europe, South America, Middle East.
3. Material: Steel, Brass, Stainless Steel.
4. Various surface coating: Chrome plated, Nickel plated, Copper color etc.
5. Proven and positive connection using ball-locking mechanism.
6. Used for air tools and air compressors.

* Please specify the item model, material, surface finish when inquiring.

SPECIFICATIONS

1. Max. Working Pressure: 150 Psi.
2. Temperature: -40 °F to 225 °F (-20 °C to 107°C).
3. Air Flow: 35 SCFM at 100 Psi inlet with 10 Psi pressure drop.

HOW TO ORDER

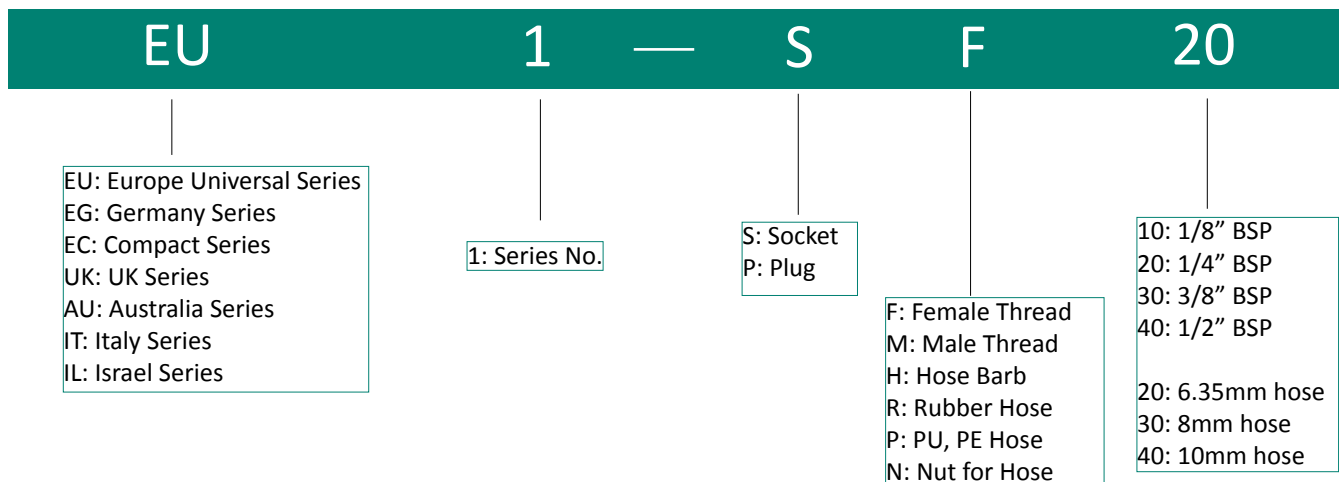

QUICK COUPLING

EUROPE UNIVERSAL COUPLER



EU1 Series-
Female Socket

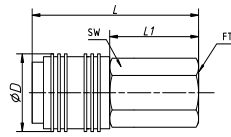

ITEM	L	ΦD	L1	SW	FT
EU1-SF20	54	23	24.5	19	1/4"BSP
EU1-SF30	54	23	25.5	20	3/8"BSP
EU1-SF40	57.5	23	28	25	1/2"BSP

EUROPE Standard-
Female Plug

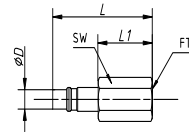

ITEM	L	ΦD	L1	SW	FT
EUPF20	37	7.4	13.5	16	1/4"BSP
EUPF30	39	7.4	15	20	3/8"BSP
EUPF40	42	7.4	18	25	1/2"BSP

EU1 Series-
Male Socket

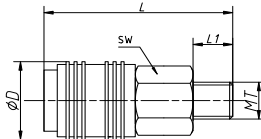

ITEM	L	ΦD	L1	SW	MT
EU1-SM20	54.5	23	10.5	19	1/4"BSP
EU1-SM30	55	23	11	19	3/8"BSP
EU1-SM40	58.5	23	13.5	21	1/2"BSP

EUROPE Standard-
Male Plug

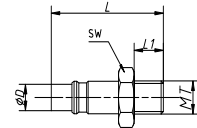

ITEM	L	ΦD	L1	SW	MT
EUPM20	39	7.4	10.5	14	1/4"BSP
EUPM30	40	7.4	11	17	3/8"BSP
EUPM40	44	7.4	13.5	21	1/2"BSP

EU1 Series-
Barb Socket

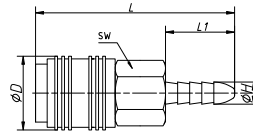

ITEM	L	ΦD	L1	SW	ΦH
EU1-SH20	65	23	20	19	6.35mm
EU1-SH30	65	23	20	19	8mm
EU1-SH40	65	23	20	19	10mm

EUROPE Standard-
Barb Plug

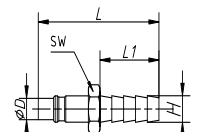

ITEM	L	ΦD	L1	SW	ΦH
EUPH20	48.5	7.4	20	14	6.35mm
EUPH30	48.5	7.4	20	14	8mm
EUPH40	48.5	7.4	20	14	10mm

EU1 Series-
Rubber Hose Socket

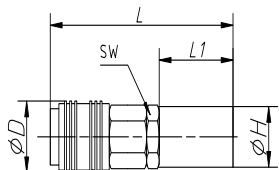

ITEM	L	ΦD	L1	SW	ΦH
EU1-SR20	71.5	23	26.5	19	6*12 mm
EU1-SR30	72.5	23	27.5	19	8*15 mm

EUROPE Standard-
Rubber Hose Plug

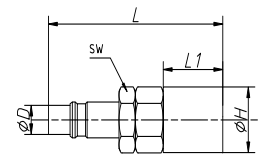

ITEM	L	ΦD	L1	SW	ΦH
EUPR20	55.5	7.4	26.5	14	6*12 mm
EUPR30	56.5	7.4	27.5	14	8*15 mm

EU1 Series-
Air Hose Socket with Spring Sleeve

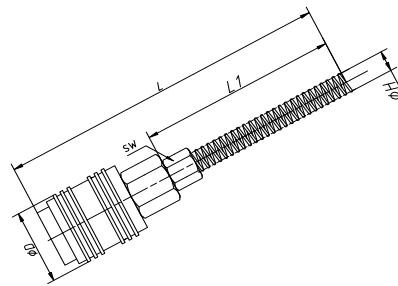

ITEM	L	ΦD	L1	SW	ΦH
EU1-SP10	135	23	90	19	4*6 mm
EU1-SP20	145	23	100	19	5*8 mm
EU1-SP30	150	23	105	19	6.5*10 mm
EU1-SP40	155	23	110	19	8*12 mm

EUROPE Standard-
Air Hose Plug with Spring Sleeve

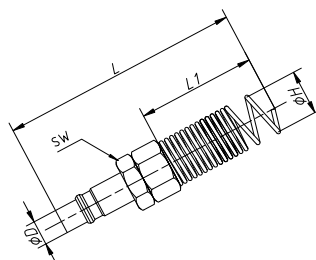

ITEM	L	ΦD	L1	SW	ΦH
EUPP10	119	7.4	90	14	4*6 mm
EUPP20	129	7.4	100	14	5*8 mm
EUPP30	135	7.4	105	16	6.5*10 mm
EUPP40	140	7.4	110	17	8*12 mm

EU2 Series-
Female Socket

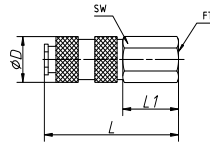

ITEM	L	ΦD	L1	SW	FT
EU2-SF20	53	22	21	19	1/4"BSP
EU2-SF30	54	22	22	20	3/8"BSP
EU2-SF40	56.5	22	24.5	25	1/2"BSP

EU3 Series-
Female Socket

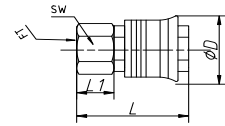

ITEM	L	ΦD	L1	SW	FT
EU3-SF20	48.5	27	18	20	1/4"BSP
EU3-SF30	50	27	19.5	20	3/8"BSP
EU3-SF40	53	27	22.5	25	1/2"BSP

EU2 Series-
Male Socket

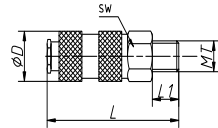

ITEM	L	ΦD	L1	SW	MT
EU2-SM20	53.5	22	10.5	19	1/4"BSP
EU2-SM30	54	22	11	19	3/8"BSP
EU2-SM40	57.5	22	13.5	21	1/2"BSP

EU3 Series-
Male Socket

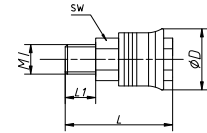

ITEM	L	ΦD	L1	SW	MT
EU3-SM20	48.5	27	18	20	1/4"BSP
EU3-SM30	50	27	19.5	20	3/8"BSP
EU3-SM40	53	27	22.5	25	1/2"BSP

EU2 Series-
Barb Socket

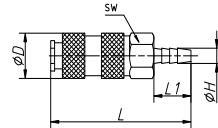

ITEM	L	ΦD	L1	SW	ΦH
EU2-SH20	65	23	20	19	6.35mm
EU2-SH30	65	23	20	19	8mm
EU2-SH40	65	23	20	19	10mm

EU3 Series-
Barb Socket

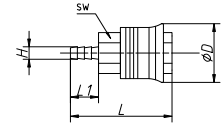

ITEM	L	ΦD	L1	SW	ΦH
EU3-SH20	61	27	20	20	6.35mm
EU3-SH30	61	27	20	20	8mm
EU3-SH40	61	27	20	20	10mm

EU2 Series-
Rubber Hose Socket

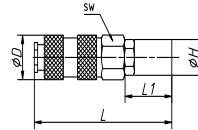

ITEM	L	ΦD	L1	SW	ΦH
EU2-SR20	69.5	22	26.5	19	6*12 mm
EU2-SR30	70.5	22	27.5	19	8*15 mm

EU2 Series-
Hose Socket

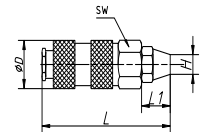

ITEM	L	ΦD	L1	SW	FT
EU2-SN20	55	22	12	19	5*8 mm
EU2-SN30	57	22	14	19	6.5*10mm
EU2-SN40	60	22	16	19	8*12 mm

EU2 Series-
Air Hose Socket with Spring Sleeve

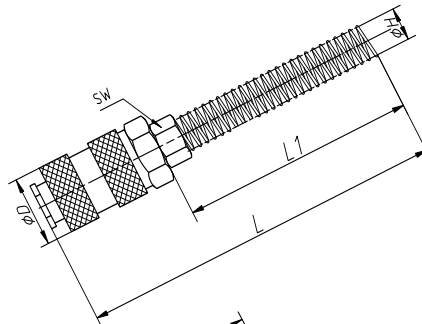

ITEM	L	ΦD	L1	SW	ΦH
EU2-SP10	133	22	90	19	4*6 mm
EU2-SP20	143	22	100	19	5*8 mm
EU2-SP30	148	22	105	19	6.5*10 mm
EU2-SP40	153	22	110	19	8*12 mm

EUROPE Standard-
Air Hose Plug with Spring Sleeve

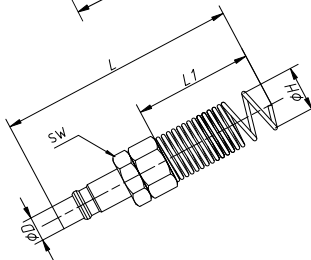

ITEM	L	ΦD	L1	SW	ΦH
EUPP10	119	7.4	90	14	4*6 mm
EUPP20	129	7.4	100	14	5*8 mm
EUPP30	135	7.4	105	16	6.5*10 mm
EUPP40	140	7.4	110	17	8*12 mm

QUICK COUPLING

GERMANY QUICK COUPLER



EG1 Series- Steel Material Female Socket

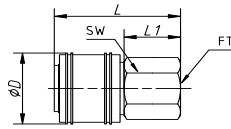

ITEM	L	ΦD	L1	SW	FT
EG1-SF20	41	26	17	21	1/4"BSP
EG1-SF30	42	26	18	21	3/8"BSP
EG1-SF40	45	26	21	25	1/2"BSP

EG1 Series- Steel Material Female Plug

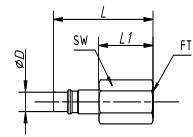

ITEM	L	ΦD	L1	SW	FT
EG1-PF20	37	7.4	13.5	16	1/4"BSP
EG1-PF30	39	7.4	15	20	3/8"BSP
EG1-PF40	42	7.4	18	25	1/2"BSP

EG1 Series- Steel Material Male Socket

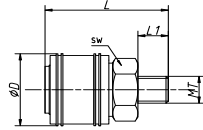

ITEM	L	ΦD	L1	SW	MT
EG1-SM20	42.5	26	10.5	21	1/4"BSP
EG1-SM30	43	26	11	21	3/8"BSP
EG1-SM40	47	26	13.5	21	1/2"BSP

EG1 Series- Steel Material Male Plug

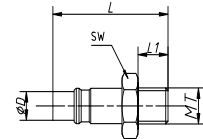

ITEM	L	ΦD	L1	SW	MT
EG1-PM20	39	7.4	10.5	14	1/4"BSP
EG1-PM30	40	7.4	11	17	3/8"BSP
EG1-PM40	44	7.4	13.5	21	1/2"BSP

EG1 Series- Steel Material Barb Socket

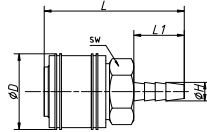

ITEM	L	ΦD	L1	SW	ΦH
EG1-SH20	53	26	20	21	6.35mm
EG1-SH30	53	26	20	21	8mm
EG1-SH40	53	26	20	21	10mm

EG1 Series- Steel Material Barb Plug

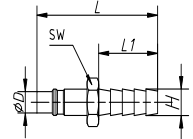

ITEM	L	ΦD	L1	SW	ΦH
EG1-PH20	48.5	7.4	20	14	6.35mm
EG1-PH30	48.5	7.4	20	14	8mm
EG1-PH40	48.5	7.4	20	14	10mm

EG2 Series- Brass Material Female Socket

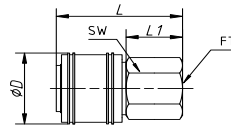

ITEM	L	ΦD	L1	SW	FT
EG2-SF20	41	26	17	21	1/4"BSP
EG2-SF30	42	26	18	21	3/8"BSP
EG2-SF40	45	26	21	25	1/2"BSP

EG2 Series- Brass Material Female Plug

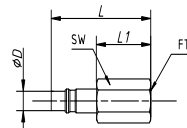

ITEM	L	ΦD	L1	SW	FT
EG2-PF20	37	7.4	13.5	16	1/4"BSP
EG2-PF30	39	7.4	15	20	3/8"BSP
EG2-PF40	42	7.4	18	25	1/2"BSP

EG2 Series- Brass Material Male Socket

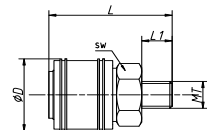

ITEM	L	ΦD	L1	SW	MT
EG2-SM20	42.5	26	10.5	21	1/4"BSP
EG2-SM30	43	26	11	21	3/8"BSP
EG2-SM40	47	26	13.5	21	1/2"BSP

EG2 Series- Brass Material Male Plug

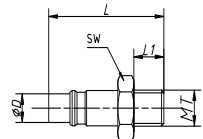

ITEM	L	ΦD	L1	SW	MT
EG2-PM20	39	7.4	10.5	14	1/4"BSP
EG2-PM30	40	7.4	11	17	3/8"BSP
EG2-PM40	44	7.4	13.5	21	1/2"BSP

EG2 Series- Brass Material Barb Socket

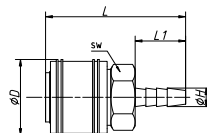

ITEM	L	ΦD	L1	SW	ΦH
EG2-SH20	53	26	20	21	6.35mm
EG2-SH30	53	26	20	21	8mm
EG2-SH40	53	26	20	21	10mm

EG2 Series- Brass Material Barb Plug

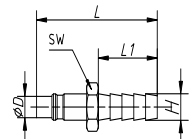

ITEM	L	ΦD	L1	SW	ΦH
EG2-PH20	48.5	7.4	20	14	6.35mm
EG2-PH30	48.5	7.4	20	14	8mm
EG2-PH40	48.5	7.4	20	14	10mm

UK1 Series-
Female Socket

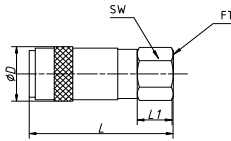

ITEM	L	ΦD	L1	SW	FT
UK1-SF20	62.5	22	12	19	1/4" BSP
UK1-SF30	64.5	22	14	20	3/8" BSP
UK1-SF40	66.5	22	16	25	1/2" BSP

UK3 Series-
Female Socket

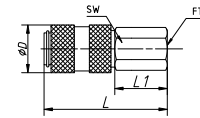

ITEM	L	ΦD	L1	SW	FT
UK3-SF20	57	23	23	19	1/4" BSP
UK3-SF30	57	23	23	19	3/8" BSP
UK3-SF40	61	23	27	24	1/2" BSP

UK1 Series-
Male Socket

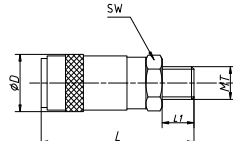

ITEM	L	ΦD	L1	SW	MT
UK1-SM20	70	22	10.5	19	1/4" BSP
UK1-SM30	71	22	11	19	3/8" BSP
UK1-SM40	74	22	13.5	21	1/2" BSP

UK3 Series-
Male Socket

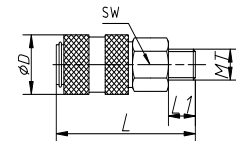

ITEM	L	ΦD	L1	SW	MT
UK3-SM20	61.5	23	10.5	19	1/4" BSP
UK3-SM30	62.0	23	11	19	3/8" BSP
UK3-SM40	64.5	23	13.5	21	1/2" BSP

UK1 Series-
Barb Socket

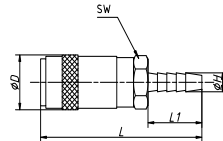

ITEM	L	ΦD	L1	SW	ΦH
UK1-SH20	77	22	20	19	6.35mm
UK1-SH30	77	22	20	19	8mm
UK1-SH40	77	22	20	19	10mm

UK3 Series-
Barb Socket

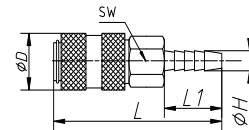

ITEM	L	ΦD	L1	SW	ΦH
UK3-SH20	76	23	25	19	6.35mm
UK3-SH30	76	23	25	19	8mm
UK3-SH40	76	23	25	19	10mm

UK2 Series-
Female Socket

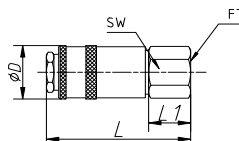

ITEM	L	ΦD	L1	SW	FT
UK2-SF20	58	25	12	19	1/4" BSP
UK2-SF30	60	25	14	20	3/8" BSP
UK2-SF40	62	25	18	25	1/2" BSP

UK Series-
Female Plug

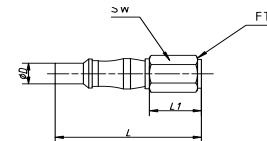

ITEM	L	ΦD	L1	SW	FT
UKPF20	53	7.8	17.5	16	1/4" BSP
UKPF30	54	7.8	18.5	20	3/8" BSP
UKPF40	55.5	7.8	20	25	1/2" BSP

UK2 Series-
Male Socket

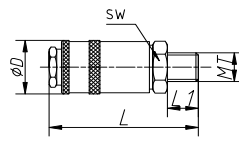

ITEM	L	ΦD	L1	SW	MT
UK2-SM20	63.5	25	10.5	19	1/4" BSP
UK2-SM30	64.0	25	11	19	3/8" BSP
UK2-SM40	66.5	25	13.5	19	1/2" BSP

UK Series-
Male Plug

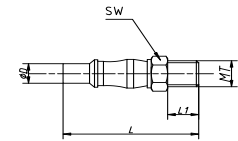

ITEM	L	ΦD	L1	SW	MT
UKPM20	50.5	7.8	10.5	14	1/4" BSP
UKPM30	51.5	7.8	11	17	3/8" BSP
UKPM40	55	7.8	13.5	21	1/2" BSP

UK2 Series-
Barb Socket

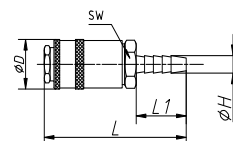

ITEM	L	ΦD	L1	SW	ΦH
UK2-SH20	70.5	25	16	19	6.35mm
UK2-SH30	72.5	25	18	19	8mm
UK2-SH40	74.5	25	20	19	10mm

UK Series-
Barb Plug

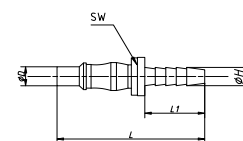

ITEM	L	ΦD	L1	SW	ΦH
UKPH20	60	7.8	20	14	6.35mm
UKPH30	60	7.8	20	14	8mm
UKPH40	60	7.8	20	14	10mm

QUICK COUPLING

IL / AU SERIES QUICK COUPLER



IL SERIES ISRAEL QUICK COUPLING

IL Series-
Female Socket

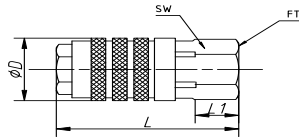

ITEM	L	ΦD	L1	SW	FT
ILSF20	54.5	24	11	19	1/4"BSP
ILSF30	56.5	24	12.5	20	3/8"BSP
ILSF40	59	24	15.5	25	1/2"BSP

IL Series-
Female Plug

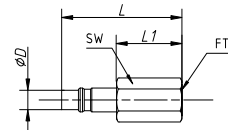

ITEM	L	ΦD	L1	SW	FT
ILPF20	39.5	8	16	16	1/4"BSP
ILPF30	41	8	17.5	20	3/8"BSP
ILPF40	43	8	19.5	25	1/2"BSP

IL Series-
Male Socket

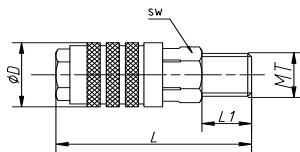

ITEM	L	ΦD	L1	SW	MT
ILSM20	61.5	24	10.5	19	1/4"BSP
ILSM30	62	24	11	19	3/8"BSP
ILSM40	66	24	13.5	21	1/2"BSP

IL Series-
Male Plug

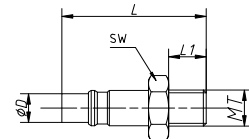

ITEM	L	ΦD	L1	SW	MT
ILPM20	41.5	8	12	14	1/4"BSP
ILPM30	43	8	13	17	3/8"BSP
ILPM40	47	8	15	21	1/2"BSP

IL Series-
Rubber Hose Socket

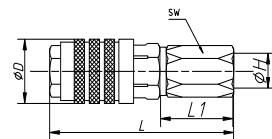

ITEM	L	ΦD	L1	SW	ΦH
ILSR20	79.6	24	22	19	6*12 mm
ILSR30	81	24	23.4	19	8*15 mm

IL Series-
Rubber Hose Plug

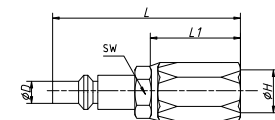

ITEM	L	ΦD	L1	SW	ΦH
ILPR20	60	8	22	14	6*12 mm
ILPR30	61.4	8	23.4	14	8*15 mm

AU SERIES AUSTRALIA QUICK COUPLING

AU Series-
Female Socket

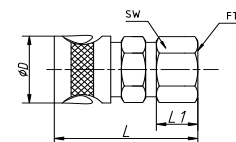

ITEM	L	ΦD	L1	SW	FT
AUSF20	47	22	13.5	19	1/4"BSP
AUSF30	49	22	15.5	20	3/8"BSP
AUSF40	55	22	17.5	25	1/2"BSP

AU Series-
Female Plug

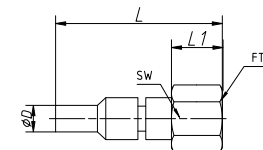

ITEM	L	ΦD	L1	SW	FT
AUPF20	37	7.4	13.5	16	1/4"BSP
AUPF30	39	7.4	15	20	3/8"BSP
AUPF40	42	7.4	18	25	1/2"BSP

AU Series-
Male Socket

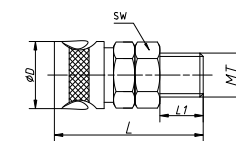

ITEM	L	ΦD	L1	SW	MT
AUSM20	51	22	10.5	19	1/4"BSP
AUSM30	51.5	22	11	19	3/8"BSP
AUSM40	54	22	13.5	21	1/2"BSP

AU Series-
Male Plug

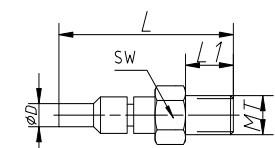

ITEM	L	ΦD	L1	SW	MT
AUPM20	39	7.4	10.5	14	1/4"BSP
AUPM30	40	7.4	11	17	3/8"BSP
AUPM40	44	7.4	13.5	21	1/2"BSP

EC1 Series-
Female Socket

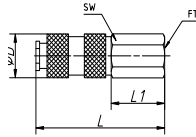

ITEM	L	ΦD	L1	SW	FT
EC1-SF20	41.5	19	13	16	1/4"BSP
EC1-SF30	42.5	19	14	20	3/8"BSP

EC1 Series-
Female Plug

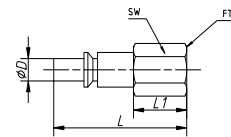

ITEM	L	ΦD	L1	SW	FT
EC1-PF20	32.5	5.5	13	16	1/4"BSP
EC1-PF30	34	5.5	14.5	20	3/8"BSP

EC1 Series-
Male Socket

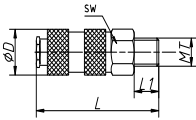

ITEM	L	ΦD	L1	SW	MT
EC1-SM20	45	19	10.5	16	1/4"BSP
EC1-SM30	46	19	11	17	3/8"BSP

EC1 Series-
Male Plug

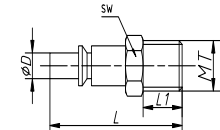

ITEM	L	ΦD	L1	SW	MT
EC1-PM20	33	5.5	8.5	14	1/4"BSP
EC1-PM30	35.5	5.5	10.5	17	3/8"BSP

EC1 Series-
Hose Socket

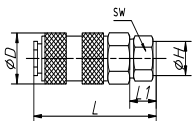

ITEM	L	ΦD	L1	SW	ΦH
EC1-SN20	46	19	12	16	4*6 mm
EC1-SN30	48	19	14	16	5*8 mm

EC1 Series-
Hose Plug

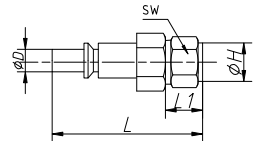

ITEM	L	ΦD	L1	SW	ΦH
EC1-PN20	37.5	5.5	12	14	4*6 mm
EC1-PN30	39.5	5.5	14	14	5*8 mm

MINIATURE QUICK COUPLING

EC2 Series-
Male Socket G1/8"



EC2 Series-
Female Socket G1/8"



EC2 Series-
Female Socket M16



EC3 Series-
Barb Socket 6mm



EC2 Series-
Bulkhead Socket 6x4mm Hose



EC2 Series-
Barb Plug 6mm



EC2 Series-
Hose Plug with Spring Sleeve 6x4mm



QUICK COUPLING

USA SERIES QUICK COUPLER



FEATURES

1. We make USA Universal coupler, Milton coupler, ARO coupler, Truflate coupler etc.
2. Target market: North America, South America.
3. Material: Steel, Brass, Stainless Steel.
4. Various surface coating: Chrome plated, Nickel plated, Copper color etc.
5. Proven and positive connection using ball-locking mechanism.
6. Used for air tools and air compressors.

* Please specify the item code, material, surface finish when inquiring.

SPECIFICATIONS

1. Max. Working Pressure: 150 Psi.
2. Temperature: -40 °F to 225 °F (-20 °C to 107°C).
3. Air Flow: 35 SCFM at 100 Psi inlet with 10 Psi pressure drop.

HOW TO ORDER

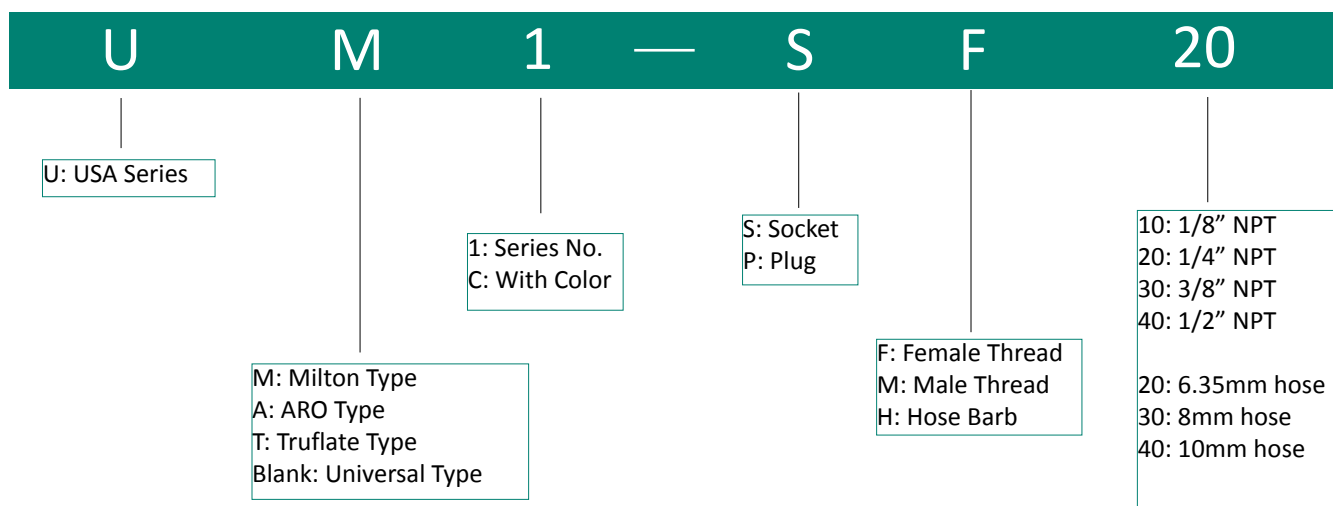

UM1 Series-
Female Socket

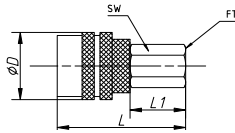

ITEM	L	ΦD	L1	SW	FT
UM1-SF20	47.5	24	15.5	17	1/4"NPT
UM1-SF30	48	24	16	20	3/8"NPT
UM1-SF40	50.5	24	18.5	25	1/2"NPT

UM2 Series-
Female Socket

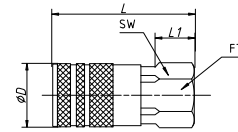

ITEM	L	ΦD	L1	SW	FT
UM2-SF20	46	22	13.5	19	1/4"NPT
UM2-SF30	48	22	15.5	20	3/8"NPT
UM2-SF40	50.5	22	17.5	25	1/2"NPT

UM1 Series-
Male Socket

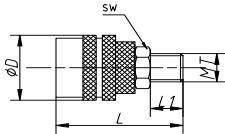

ITEM	L	ΦD	L1	SW	MT
UM1-SM20	50.5	24	12	17	1/4"NPT
UM1-SM30	51.5	24	13	17	3/8"NPT
UM1-SM40	55	24	15	21	1/2"NPT

UM2 Series-
Male Socket

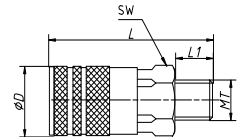

ITEM	L	ΦD	L1	SW	MT
UM2-SM20	55	22	12	19	1/4"NPT
UM2-SM30	55.5	22	13	19	3/8"NPT
UM2-SM40	59	22	15	21	1/2"NPT

UM1 Series-
Barb Socket

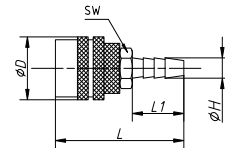

ITEM	L	ΦD	L1	SW	ΦH
UM1-SH20	60	24	20	17	6.35mm
UM1-SH30	60	24	20	17	8mm
UM1-SH40	60	24	20	17	10mm

UM2 Series-
Barb Socket

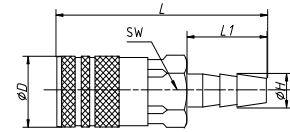

ITEM	L	ΦD	L1	SW	ΦH
UM2-SH20	64.5	22	20	19	6.35mm
UM2-SH30	64.5	22	20	19	8mm
UM2-SH40	64.5	22	20	19	10mm

UMC Series-
Female Socket

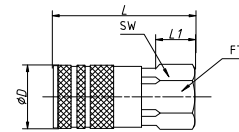

ITEM	L	ΦD	L1	SW	FT
UMC-SF20	46	22	13.5	19	1/4"NPT
UMC-SF30	48	22	15.5	20	3/8"NPT
UMC-SF40	50.5	22	17.5	25	1/2"NPT

UM Series-
Female Plug

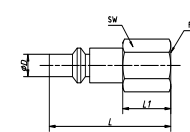

ITEM	L	ΦD	L1	SW	FT
UMPF20	37	7.9	14	16	1/4"NPT
UMPF30	39	7.9	16	20	3/8"NPT
UMPF40	41.5	7.9	18.5	25	1/2"NPT

UMC Series-
Male Socket

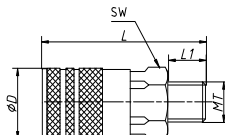

ITEM	L	ΦD	L1	SW	MT
UMC-SM20	55	22	12	19	1/4"NPT
UMC-SM30	55.5	22	13	19	3/8"NPT
UMC-SM40	59	22	15	21	1/2"NPT

UM Series-
Male Plug

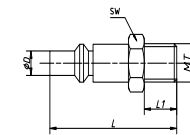

ITEM	L	ΦD	L1	SW	MT
UMPM20	38.5	7.9	10.5	14	1/4"NPT
UMPM30	40	7.9	11	17	3/8"NPT
UMPM40	43.5	7.9	13.5	21	1/2"NPT

UMC Series-
Barb Socket

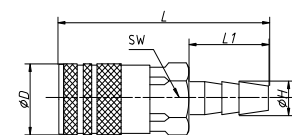

ITEM	L	ΦD	L1	SW	ΦH
UMC-SH20	64.5	22	20	19	6.35mm
UMC-SH30	64.5	22	20	19	8mm
UMC-SH40	64.5	22	20	19	10mm

UM Series-
Barb Plug

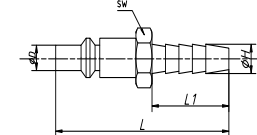

ITEM	L	ΦD	L1	SW	ΦH
UMPH20	48	7.9	20	13	6.35mm
UMPH30	48	7.9	20	13	8mm
UMPH40	48	7.9	20	13	10mm

QUICK COUPLING

USA SERIES INDUSTRIAL COUPLER



UM38 Series-
Female Socket

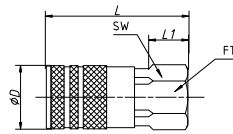

ITEM	L	ΦD	L1	SW	FT
UM38-SF20	57.5	28.5	21	22	1/4"NPT
UM38-SF30	59.5	28.5	23	22	3/8"NPT
UM38-SF40	61.5	28.5	25	25	1/2"NPT

UM38 Series-
Female Plug

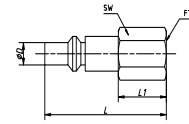

ITEM	L	ΦD	L1	SW	FT
UM38-PF20	42.5	10.9	15	20	1/4"NPT
UM38-PF30	44	10.9	16.5	20	3/8"NPT
UM38-PF40	46.5	10.9	19	25	1/2"NPT

UM38 Series-
Male Socket

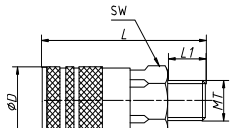

ITEM	L	ΦD	L1	SW	MT
UM38-SM20	56	28.5	12	22	1/4"NPT
UM38-SM30	57	28.5	13	22	3/8"NPT
UM38-SM40	60	28.5	15	22	1/2"NPT

UM38 Series-
Male Plug

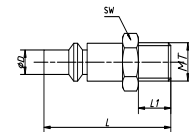

ITEM	L	ΦD	L1	SW	MT
UM38-PM20	43	10.9	11	16	1/4"NPT
UM38-PM30	44	10.9	12	17	3/8"NPT
UM38-PM40	48	10.9	14.5	21	1/2"NPT

UM38 Series-
Barb Socket

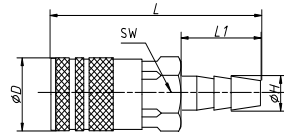

ITEM	L	ΦD	L1	SW	ΦH
UM38-SH20	60	28.5	20	22	6.35mm
UM38-SH30	60	28.5	20	22	8mm
UM38-SH40	60	28.5	20	22	10mm

UM38 Series-
Barb Plug

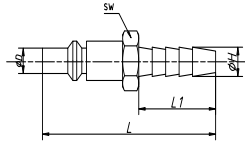

ITEM	L	ΦD	L1	SW	ΦH
UM38-PH20	48	10.9	20	14	6.35mm
UM38-PH30	48	10.9	20	14	8mm
UM38-PH40	48	10.9	20	14	10mm

UM12 Series-
Female Socket

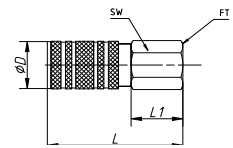

ITEM	L	ΦD	L1	SW	FT
UM12-SF20	75	30	18	25	1/4"NPT
UM12-SF30	77	30	22	25	3/8"NPT
UM12-SF40	80	30	25	25	1/2"NPT

UM12 Series-
Female Plug

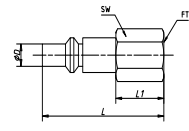

ITEM	L	ΦD	L1	SW	FT
UM12-PF20	48	17	18	19	1/4"NPT
UM12-PF30	52	17	28	20	3/8"NPT
UM12-PF40	65	17	32	25	1/2"NPT

UM12 Series-
Male Socket

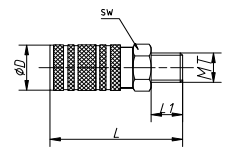

ITEM	L	ΦD	L1	SW	MT
UM12-SM20	85	30	12	25	1/4"NPT
UM12-SM30	85	30	13	25	3/8"NPT
UM12-SM40	90	30	15	25	1/2"NPT

UM12 Series-
Male Plug

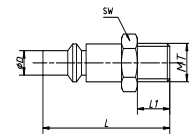

ITEM	L	ΦD	L1	SW	MT
UM12-PM20	48	17	18	19	1/4"NPT
UM12-PM30	52	17	22	19	3/8"NPT
UM12-PM40	65	17	25	21	1/2"NPT

UM12 Series-
Barb Socket

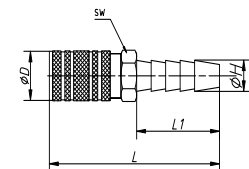

ITEM	L	ΦD	L1	SW	ΦH
UM12-SH20	92	30	30	25	10mm
UM12-SH30	92	30	30	25	13mm
UM12-SH40	92	30	30	25	19mm

UM12 Series-
Barb Plug

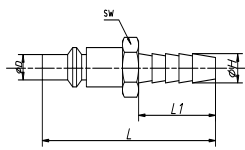

ITEM	L	ΦD	L1	SW	ΦH
UM12-PH20	68	17	30	19	10mm
UM12-PH30	68	17	30	19	13mm
UM12-PH40	68	17	30	19	19mm

UA1 Series-
Female Socket

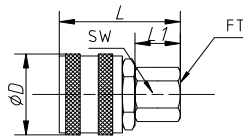

ITEM	L	ΦD	L1	SW	FT
UA1-SF20	44	28.5	15	20	1/4"NPT
UA1-SF30	45	28.5	16	20	3/8"NPT
UA1-SF40	47.5	28.5	18.5	25	1/2"NPT

UA2 Series-
Female Socket

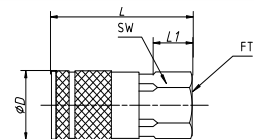

ITEM	L	ΦD	L1	SW	FT
UA2-SF20	44	28.5	15	20	1/4"NPT
UA2-SF30	45	28.5	16	20	3/8"NPT
UA2-SF40	47.5	28.5	18.5	25	1/2"NPT

UA1 Series-
Male Socket

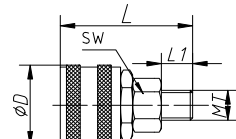

ITEM	L	ΦD	L1	SW	MT
UA1-SM20	47.5	28.5	10.5	20	1/4"NPT
UA1-SM30	48	28.5	11	20	3/8"NPT
UA1-SM40	51.5	28.5	13.5	21	1/2"NPT

UA2 Series-
Male Socket

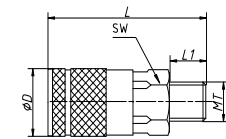

ITEM	L	ΦD	L1	SW	MT
UA2-SM20	47.5	28.5	10.5	20	1/4"NPT
UA2-SM30	48	28.5	11	20	3/8"NPT
UA2-SM40	51.5	28.5	13.5	21	1/2"NPT

UA1 Series-
Barb Socket

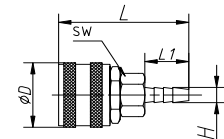

ITEM	L	ΦD	L1	SW	ΦH
UA1-SH20	57	28.5	20	20	6.35mm
UA1-SH30	57	28.5	20	20	8mm
UA1-SH40	57	28.5	20	20	10mm

UA2 Series-
Barb Socket

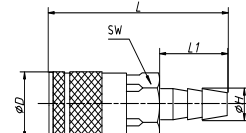

ITEM	L	ΦD	L1	SW	ΦH
UA2-SH20	57	28.5	20	20	6.35mm
UA2-SH30	57	28.5	20	20	8mm
UA2-SH40	57	28.5	20	20	10mm

UA38 Series-
Female Socket

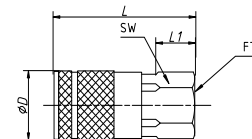

ITEM	L	ΦD	L1	SW	FT
UA38-SF20	57	27	15	22	1/4"NPT
UA38-SF30	58	27	15	22	3/8"NPT
UA38-SF40	60.5	27	18.5	22	1/2"NPT

UA Series-
Female Plug

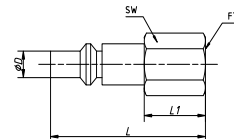

ITEM	L	ΦD	L1	SW	FT
UAPF20	36.5	7.9	15	16	1/4"NPT
UAPF30	37	7.9	16.5	20	3/8"NPT
UAPF40	39.5	7.9	19	25	1/2"NPT

UA38 Series-
Male Socket

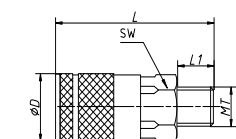

ITEM	L	ΦD	L1	SW	MT
UA38-SM20	58	27	12	22	1/4"NPT
UA38-SM30	60	27	13.5	22	3/8"NPT
UA38-SM40	63	27	15	22	1/2"NPT

UA Series-
Male Plug

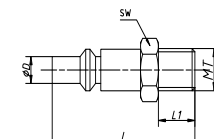

ITEM	L	ΦD	L1	SW	MT
UAPM20	37	7.9	10.5	14	1/4"NPT
UAPM30	39.5	7.9	11	17	3/8"NPT
UAPM40	43	7.9	13.5	21	1/2"NPT

UA38 Series-
Barb Socket

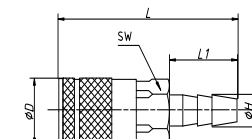

ITEM	L	ΦD	L1	SW	ΦH
UA38-SH20	60	27	20	22	6.35mm
UA38-SH30	60	27	20	22	8mm
UA38-SH40	60	27	20	22	10mm

UA Series-
Barb Plug

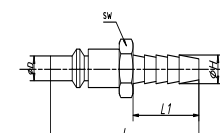

ITEM	L	ΦD	L1	SW	ΦH
UAPH20	47.5	7.9	20	13	6.35mm
UAPH30	47.5	7.9	20	13	8mm
UAPH40	47.5	7.9	20	13	10mm

QUICK COUPLING

USA SERIES UNIVERSAL COUPLER



U1 Series-
Female Socket

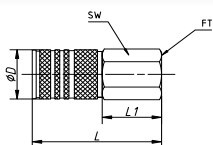

ITEM	L	ΦD	L1	SW	FT
U1-SF20	53	25	27	20	1/4"NPT
U1-SF30	54	25	28	20	3/8"NPT
U1-SF40	56	25	30.5	25	1/2"NPT

U38 Series-
Female Socket

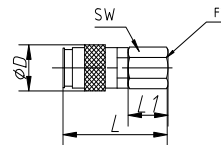

ITEM	L	ΦD	L1	SW	FT
U38-SF20	68.5	28.5	35	22	1/4"NPT
U38-SF30	69	28.5	35.5	22	3/8"NPT
U38-SF40	71.5	28.5	38.0	25	1/2"NPT

U1 Series-
Male Socket

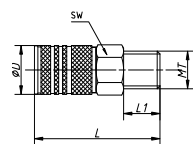

ITEM	L	ΦD	L1	SW	MT
U1-SM20	53	25	11	20	1/4"NPT
U1-SM30	54	25	11.5	20	3/8"NPT
U1-SM40	56	25	13.5	20	1/2"NPT

U38 Series-
Male Socket

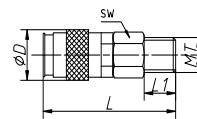

ITEM	L	ΦD	L1	SW	MT
U38-SM20	68.5	28.5	11	22	1/4"NPT
U38-SM30	70	28.5	12.5	22	3/8"NPT
U38-SM40	72	28.5	14.5	22	1/2"NPT

U1 Series-
Barb Socket

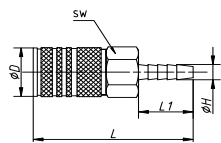

ITEM	L	ΦD	L1	SW	ΦH
U1-SH20	65	25	20	20	6.35mm
U1-SH30	65	25	20	20	8mm
U1-SH40	65	25	20	20	10mm

U38 Series-
Barb Socket

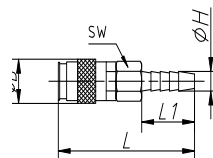

ITEM	L	ΦD	L1	SW	ΦH
U38-SH20	75	28.5	16	20	6.35mm
U38-SH30	75.5	28.5	18	20	8mm
U38-SH40	77.5	28.5	20	20	10mm

U2 Series-
Female Socket

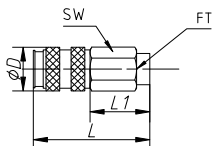

ITEM	L	ΦD	L1	SW	FT
U2-SF20	55	25	27	21	1/4"NPT
U2-SF30	56	25	28	21	3/8"NPT
U2-SF40	57.5	25	30.5	25	1/2"NPT

U2 Series-
Male Socket

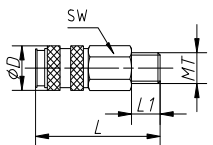

ITEM	L	ΦD	L1	SW	MT
U2-SM20	54.3	25	11	21	1/4"NPT
U2-SM30	55.3	25	11.5	21	3/8"NPT
U2-SM40	58	25	13.5	21	1/2"NPT

U2 Series-
Barb Socket

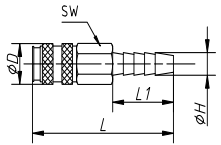

ITEM	L	ΦD	L1	SW	ΦH
U2-SH20	65	25	20	21	6.35mm
U2-SH30	65	25	20	21	8mm
U2-SH40	65	25	20	21	10mm



UT1 Series-
Female Socket

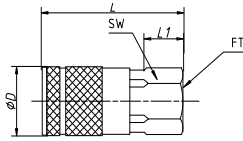

ITEM	L	ΦD	L1	SW	FT
UT1-SF20	47.5	24	15.5	17	1/4"NPT
UT1-SF30	48	24	16.0	20	3/8"NPT
UT1-SF40	50.5	24	18.5	25	1/2"NPT

UT Series-
Female Plug

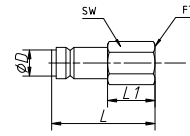

ITEM	L	ΦD	L1	SW	FT
UTPF20	37.5	8	14	16	1/4"NPT
UTPF30	39.5	8	16	20	3/8"NPT
UTPF40	42	8	18.5	25	1/2"NPT

UT1 Series-
Male Socket

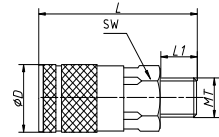

ITEM	L	ΦD	L1	SW	MT
UT1-SM20	51	24	12	17	1/4"NPT
UT1-SM30	52	24	13	17	3/8"NPT
UT1-SM40	54	24	15	21	1/2"NPT

UT Series-
Male Plug

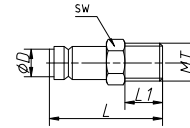

ITEM	L	ΦD	L1	SW	MT
UTPM20	38.5	8	10.5	14	1/4"NPT
UTPM30	39.5	8	11	17	3/8"NPT
UTPM40	43.5	8	13.5	21	1/2"NPT

UT1 Series-
Barb Socket

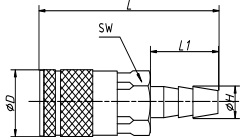

ITEM	L	ΦD	L1	SW	ΦH
UT1-SH20	60.0	24	20	17	6.35mm
UT1-SH30	60.0	24	20	17	8mm
UT1-SH40	60.0	24	20	17	10mm

UT Series-
Barb Plug

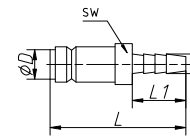

ITEM	L	ΦD	L1	SW	ΦH
UTPH20	48.5	8	20	13	6.35mm
UTPH30	48.5	8	20	13	8mm
UTPH40	48.5	8	20	13	10mm

UT38 Series-
Female Socket

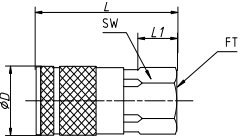

ITEM	L	ΦD	L1	SW	FT
UT38-SF20	57	27	15	22	1/4"NPT
UT38-SF30	58	27	15	22	3/8"NPT
UT38-SF40	60.5	27	18.5	25	1/2"NPT

UT38 Series-
Female Plug

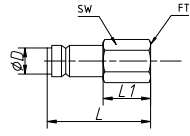

ITEM	L	ΦD	L1	SW	FT
UT38-PF20	40.8	12	18.5	17	1/4"NPT
UT38-PF30	45.8	12	19.5	20	3/8"NPT
UT38-PF40	48.3	12	22.0	25	1/2"NPT

UT38 Series-
Male Socket

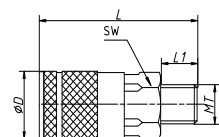

ITEM	L	ΦD	L1	SW	MT
UT38-SM20	58	27	12	22	1/4"NPT
UT38-SM30	60	27	13	22	3/8"NPT
UT38-SM40	62.5	27	15	22	1/2"NPT

UT38 Series-
Male Plug

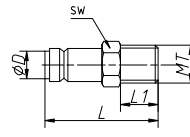

ITEM	L	ΦD	L1	SW	MT
UT38-PM20	46	12	12.5	14	1/4"NPT
UT38-PM30	46	12	12.5	17	3/8"NPT
UT38-PM40	46	12	15	21	1/2"NPT

UT38 Series-
Barb Socket

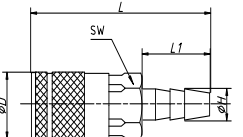

ITEM	L	ΦD	L1	SW	ΦH
UT38-SH20	60	27	20	19	6.35mm
UT38-SH30	60	27	20	19	8mm
UT38-SH40	60	27	20	19	10mm

UT38 Series-
Barb Plug

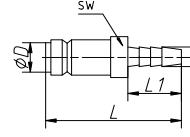

ITEM	L	ΦD	L1	SW	ΦH
UT38-PH20	52.5	12	20	16	6.35mm
UT38-PH30	52.5	12	20	16	8mm
UT38-PH40	52.5	12	20	16	10mm

QUICK COUPLING

NITTO SERIES QUICK COUPLER



FEATURES

1. We make Nitto one touch coupler, two touch quick coupler etc.
2. Target market: Japan, South East Asia, Australia etc.
3. Material: Steel, Brass, Stainless Steel.
4. Various surface coating: Chrome plated, Nickel plated, Copper color etc.
5. Proven and positive connection using ball-locking mechanism.
6. Used for air tools and air compressors.

* Please specify the item code, material, surface finish when inquiring.

SPECIFICATIONS

1. Max. Working Pressure: 150 Psi.
2. Temperature: -40 °F to 225 °F (-20 °C to 107°C).
3. Air Flow: 35 SCFM at 100 Psi inlet with 10 Psi pressure drop.

HOW TO ORDER

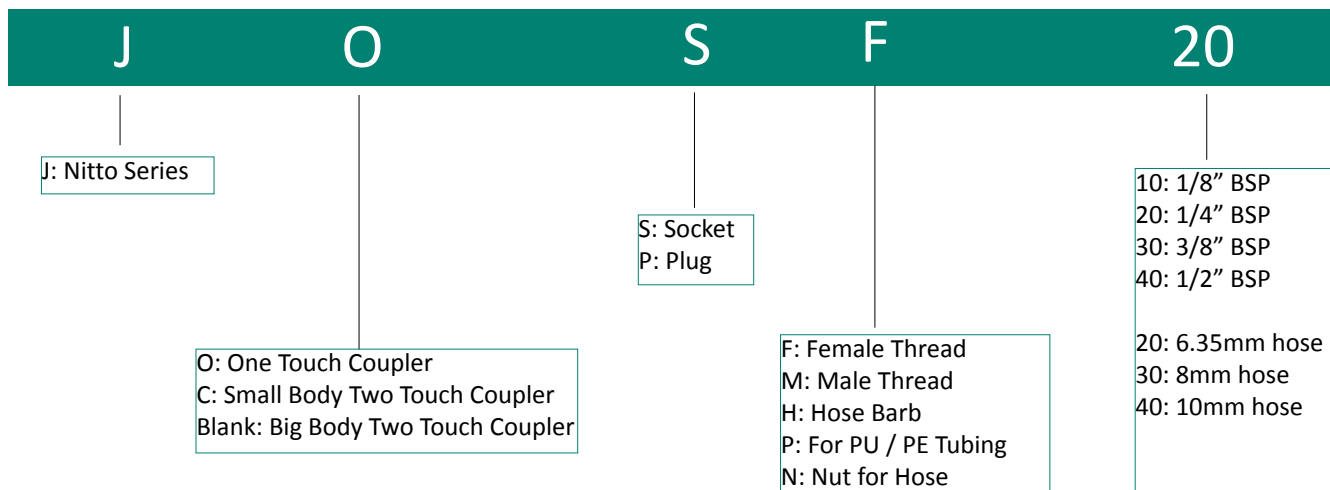

JO Series-
Female Socket

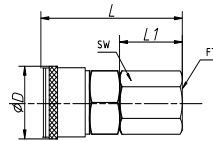

ITEM	L	ΦD	L1	SW	FT
JOSF20	54	26	20.5	19	1/4"BSP
JOSF30	54	26	20.5	22	3/8"BSP
JOSF40	56	26	22	25	1/2"BSP

J Series-
Female Plug

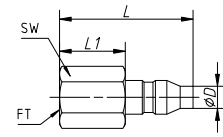

ITEM	L	ΦD	L1	SW	FT
JPF20	38.5	10.9	16	16	1/4"BSP
JPF30	39	10.9	16.5	20	3/8"BSP
JPF40	41	10.9	18.5	25	1/2"BSP

JO Series-
Male Socket

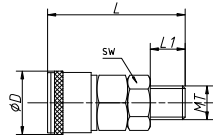

ITEM	L	ΦD	L1	SW	MT
JOSM20	56.5	26	14.5	19	1/4"BSP
JOSM30	56.5	26	14.5	19	3/8"BSP
JOSM40	58.5	26	17	21.5	1/2"BSP

J Series-
Male Plug

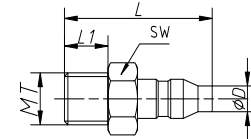

ITEM	L	ΦD	L1	SW	MT
JPM20	39	10.9	13.5	14	1/4"BSP
JPM30	42	10.9	14	17	3/8"BSP
JPM40	45	10.9	16	20	1/2"BSP

JO Series-
Barb Socket

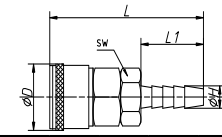

ITEM	L	ΦD	L1	SW	ΦH
JOSH20	71	26	28	19	9mm
JOSH30	73	26	30	19	11mm
JOSH40	75	26	32	19	13mm

J Series-
Barb Plug

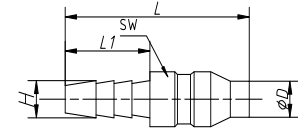

ITEM	L	ΦD	L1	SW	ΦH
JPH20	50.5	10.9	25	15	9mm
JPH30	55	10.9	28	15	11mm
JPH40	55	10.9	28	16	13mm

JO Series-
Air Hose Socket

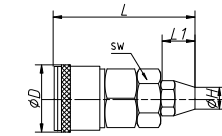

ITEM	L	ΦD	L1	SW	ΦH
JOSN20	58	26	14	19	5*8mm
JOSN30	61	26	16	19	6.5*10mm
JOSN40	63.5	26	20	19	8*12mm

J Series-
Air Hose Plug

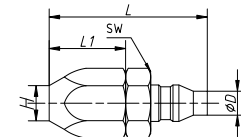

ITEM	L	ΦD	L1	SW	FT
JPN20	42.5	10.9	14	14	5*8mm
JPN30	45.5	10.9	17	16	6.5*10mm
JPN40	48	10.9	20	19	8*12mm

JO Series-
Air Hose Socket with Spring Sleeve

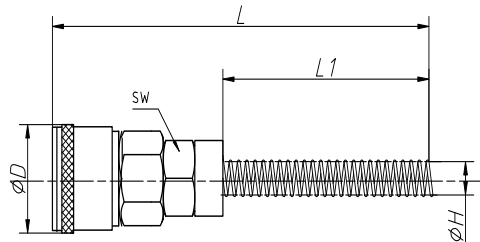

ITEM	L	ΦD	L1	SW	ΦH
JOSP10	56	26	14	19	4*6 mm
JOSP20	58	26	14	19	5*8mm
JOSP30	61	26	16	19	6.5*10mm
JOSP40	63.5	26	20	19	8*12mm

J Series-
Air Hose Plug with Spring Sleeve

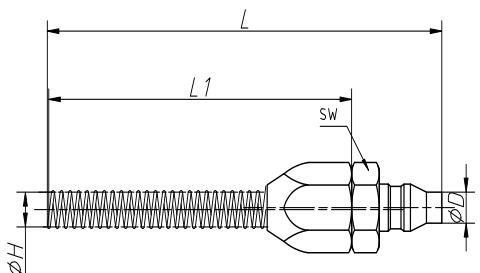

ITEM	L	ΦD	L1	SW	ΦH
JPP10	40.5	10.9	14	14	4*6mm
JPP20	42.5	10.9	14	14	5*8mm
JPP30	45.5	10.9	17	16	6.5*10mm
JPP40	48	10.9	20	19	8*12mm

QUICK COUPLING

NITTO SERIES QUICK COUPLER



J Series-
Female Socket

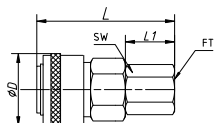

ITEM	L	ΦD	L1	SW	FT
JSF20	50	26	20	19	1/4"BSP
JSF30	51	26	20	22	3/8"BSP
JSF40	53	26	22	25	1/2"BSP

C Series-
Female Socket

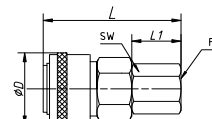

ITEM	L	ΦD	L1	SW	FT
CSF20	41.5	24	13	19	1/4"BSP
CSF30	44	24	15.5	20	3/8"BSP
CSF40	46	24	17.5	25	1/2"BSP

J Series-
Male Socket

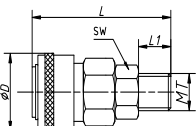

ITEM	L	ΦD	L1	SW	MT
JSM20	53.5	26	14	19	1/4"BSP
JSM30	56.5	26	14	19	3/8"BSP
JSM40	59.5	26	16	22	1/2"BSP

C Series-
Male Socket

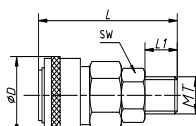

ITEM	L	ΦD	L1	SW	MT
CSM20	46	24	12	19	1/4"BSP
CSM30	48.5	24	14	19	3/8"BSP
CSM40	49	24	16	21	1/2"BSP

J Series-
Barb Socket

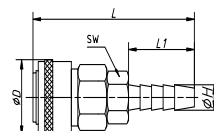

ITEM	L	ΦD	L1	SW	ΦH
JSH20	70.5	26	28	19	9mm
JSH30	70.5	26	28	19	11mm
JSH40	74	26	31.5	19	13mm

C Series-
Barb Socket

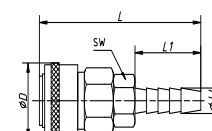

ITEM	L	ΦD	L1	SW	ΦH
CSH20	59	24	26	19	9mm
CSH30	59	24	26	19	11mm
CSH40	59	24	26	19	13mm

J Series-
Air Hose Socket

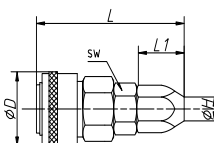

ITEM	L	ΦD	L1	SW	ΦH
JSN20	58	26	14	19	5*8mm
JSN30	61	26	18	19	6.5*10mm
JSN40	63.5	26	20	19	8*12mm

C Series-
Air Hose Socket

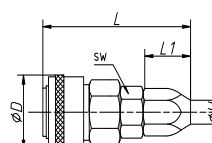

ITEM	L	ΦD	L1	SW	ΦH
CSN20	47.5	24	14	19	5*8mm
CSN30	51	24	18	19	6.5*10mm
CSN40	53	24	20	19	8*12mm

J Series-
Air Hose Socket with Spring Sleeve

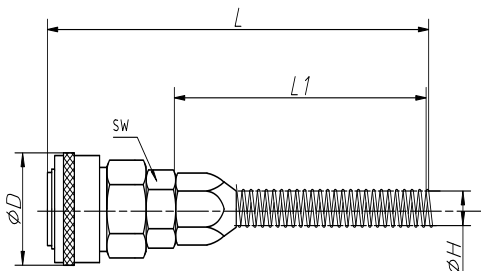

ITEM	L	ΦD	L1	SW	ΦH
JSP10	56	26	14	19	4*6 mm
JSP20	58	26	14	19	5*8mm
JSP30	61	26	16	19	6.5*10mm
JSP40	63.5	26	20	19	8*12mm



KZD couplings are used across the spectrum of hydraulic applications. These Double Shut-Off couplings can be found anywhere that fluid transfer lines need to be connected and disconnected for operation or maintenance of equipment, and a loss of fluid is undesirable. Primarily used with hydraulic fluid.

KZD couplings are also used with chemicals, water, steam, and some gases.

SPECIFICATION

Body Size(in)	1/8	1/4	3/8	1/2	3/4	1	1-1/4	1-1/2	2
Rated Pressure(PSI)	1000	1000	1000	1000	1000	1000	800	800	800
Rated Flow(GPM)	1	3	6	12	28	50	75	100	150
Temperature Range(std seals)	-20 degree - 120 degree								
Standard seal material	NBR								

FEATURES

- Poppet valves available to prevent uncoupled leakage.
- Poppet valves open automatically when coupled within rated working pressure, to keep the flow expediently.
- Dependable ball-locking mechanism holds the mating halves together.
- Socket and plug are precision machined from solid bar stock.
- KZD series conforms to the standard ISO7241-B.
- Compatible with PARKER 60 Series, FASTER HNV Series, AEROQUIP FD45 Series and HANSEN HK Series.

QUICK COUPLING

KZD Series - ISO7241-B

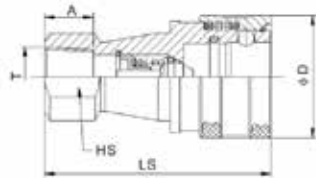

ISO	PARTNO.	LS	D	HS	A	T
5	KZD-01SF	48	24	14	8	G1/8
6.3	KZD-02SF	58	27	19	12.5	ZG1/4
10	KZD-03SF	65	35	22	13	ZG3/8
12.5	KZD-04SF	72.5	45	29	14	ZG1/2
20	KZD-06SF	88	54	36	17	ZG3/4
25	KZD-08SF	102	64.5	41	23	ZG1
31.5	KZD-10SF	115	69	54	27	ZG1-1/4
40	KZD-12SF	124	79	60	27	ZG1-1/2
50	KZD-16SF	132	102	77	30	ZG2

Note: Only size 01 to 08 conform to the standard of ISO 7241-B

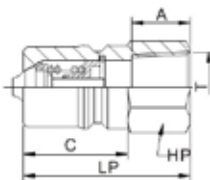

ISO	PARTNO.	LP	d	C	HP	A	T
5	KZD-01PF	29	10.8	19	14	8	G1/8
6.3	KZD-02PF	36	14.2	22.5	17	12.5	ZG1/4
10	KZD-03PF	40	19	25	22	13	ZG3/8
12.5	KZD-04PF	44	23.5	28	27	14	ZG1/2
20	KZD-06PF	52	31.4	36	36	17	ZG3/4
25	KZD-08PF	62	37.8	40	41	23	ZG1
31.5	KZD-10PF	70	45	45	52	27	ZG1-1/4
40	KZD-12PF	75	50	49	60	27	ZG1-1/2
50	KZD-16PF	80	70	52	77	30	ZG2

Note: Only size 01 to 08 conform to the standard of ISO 7241-B

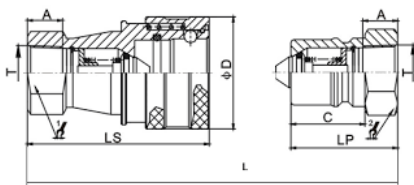

ISO	PARTNO.	L	D	HP1	HP2	T
5	KZD-01	58.5	24	14	14	G1/8
6.3	KZD-02	72.5	28	19	17	ZG1/4
10	KZD-03	80.5	35	22	22	ZG3/8
12.5	KZD-04	89	45	29	27	ZG1/2
20	KZD-06	105	54	36	36	ZG3/4
25	KZD-08	124.5	64.5	41	41	ZG1
31.5	KZD-10	140.5	69	54	52	ZG1-1/4
40	KZD-12	150.5	79	60	60	ZG1-1/2
50	KZD-16	160.5	102	77	77	ZG2

Note: Only size 01 to 08 conform to the standard of ISO 7241-B