

Scissors Jig SVX-150

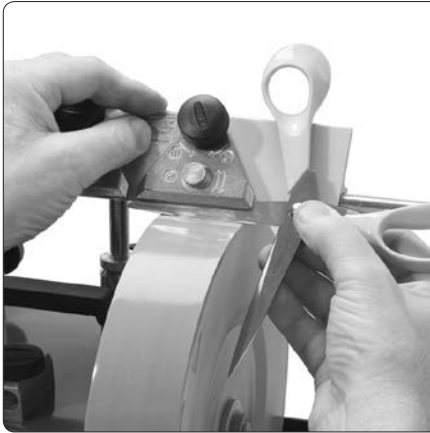

SCISSORS



GARDEN SHEARS

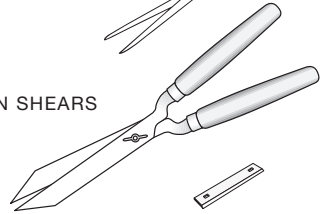

PORTABLE ELECTRIC PLANER BLADES
(Not tungsten carbide)

Positioning of Machine

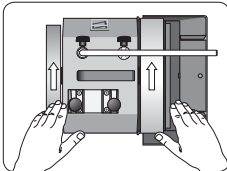

Grinding direction:
Towards the edge.

Tip The best working position is sitting on a chair in front of the machine.

Design

The jig comprises a support plate (1) and a holder (2) with two clamps (3) for the scissors. Usually you use only the right clamp. For large scissors and garden shears you use both clamps.

You adjust the clamp to fit the scissors' thickness with the screw (4). You lock the scissors by tightening the knob (5). The support plate has a sliding surface, so the holder with the scissors can easily be moved while it is pressed onto the plate.

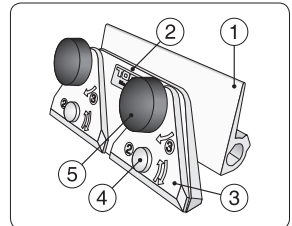

Setting the edge angle

The edge angle is set by adjusting the support plate. You can either repeat the existing angle or put a new edge angle to your scissors by using the AngleMaster WM-200. A common edge angle is 60°.

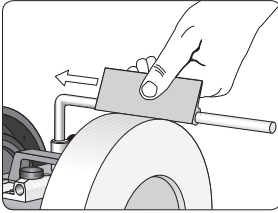

Slide the support plate onto the Universal Support. Lock the Universal Support in the lowest possible position with clearance for the plate.

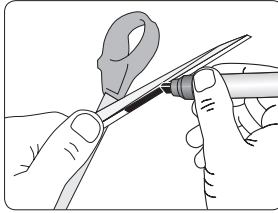

If you want to repeat the existing edge angle, colour the bevel with a marker to see where the grinding will take place.

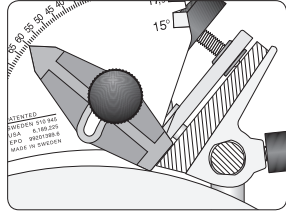

If you want to grind a new edge angle, use the AngleMaster WM-200. Let the indicator touch the holder between the two clamps.

Mounting the scissors in the jig

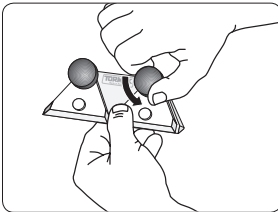

Loosen the larger knob (5).

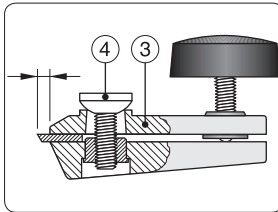

Adjust the screw (4) so the clamp (3) fits the scissor thickness. Leave about 3 mm ($\frac{1}{8}$ ") protruding.

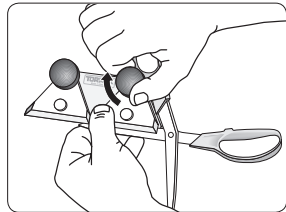

Ensure that the other blade will remain clear of the side of the stone and tighten the large knob to hold the scissors in place.

Grinding

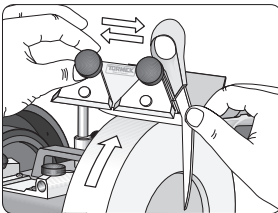

Grind carefully by placing the jig on the support plate with a light downward pressure.

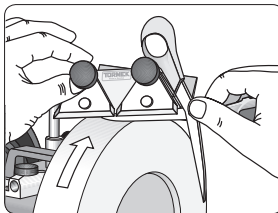

Move the jig back and forth across the stone while following the shape of the blade.

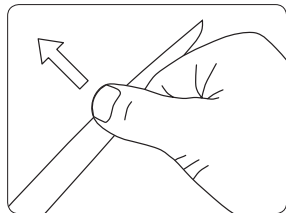

Grind until you have a burr along the entire length of the blade, and you can see an evenly ground bevel.

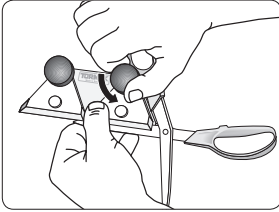

Remove the partially ground scissors from the jig by loosening the large knob.

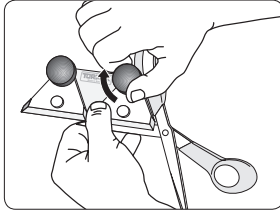

Mount the other blade in the jig.

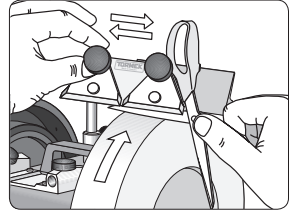

Grind the other blade in the same way as the first one.

Larger scissors and garden shears

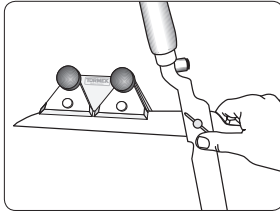
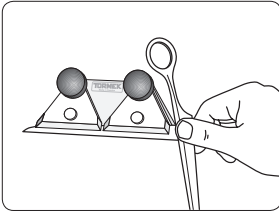

For larger scissors and shears, use both clamps.

No honing

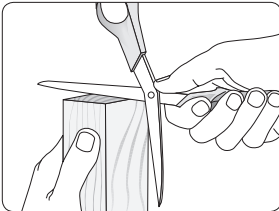

Do not hone the edge after grinding! There is no need for a finer surface. As a matter of fact a coarser surface on the scissors makes them work better, as the material (cloth or paper) to be cut slides less and cuts more easily. Remove the little burr resulting from the grinding by drawing the scissors through the end grain of a piece of wood.

Portable electric planer blades

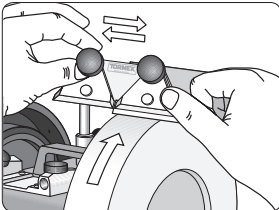

These are ground the same way as scissors. The bevel and back should however be honed. After grinding, keep the blade in the holder and hone the bevel and the back alternately until the burr disappears.